

*The Alaska Area Native Health Service*

Facsimile Cover Sheet

To: Bob Carlson
Company: ADEC Bethel
Phone: 543-3215
Fax: 543-3216

From: Dan Carpenter, P.E.
Company: Engineering Services
3925 Tudor Centre Drive
Anchorage, Alaska 99508-5997
Phone: (907) 729-3615
Fax: (907) 271-4735

Date: November 1, 1999

Pages including cover :

Comments: Bob – We now have the lab results back for the final sampling of the excavated hot spot at the YKHC hospital site (Bldg. 600). Attached is a copy of the chain of custody for the sampling that was conducted on October 6, 1999. Also attached is a revised site plan that shows the limits of excavation and the location where four wall (plus 1 duplicate) samples and 1 floor sample were collected. A summary table is provided along with the original lab analysis for each sample. The lab results confirm the field screening results that you witnessed at the site. It appears that all petroleum contaminated soil has been excavated from the site. Please advise if you require any additional information. - On a separate issue, we have accomplished the relocation of the final stockpiles of contaminated soil from and beneath the ramp at the YKHC Hospital site to the Old Hospital Site. We will deal with Shah on the remediation of the stockpiled soil. Thank you for your cooperation and patience.

Trip Report

7

Distance (ft -approx) from Sampling Location to Temporary Benchmark

Sample #	A	B	C	D
2North	-	-	22	13
2South	-	-	36	23
2East	-	-	43	33
2West	-	-	31	15
2Bottom	-	-	30	23

Summary Table of Results of Laboratory Analysis of Excavation
Bldg. 600 - YKHC Hospital (10/6/99)

Sample #	DRO	GRO	RRO
2North	152	3	197
2South	114	3	140
2East	34	3	163
2West	113	2	133
2West (duplicate)	141		
2Bottom	85	5	377

Note - Above readings are in mg/kg.

Site Map
 Soil Borings
 DC - ~~April 28, 1999~~
 October 6, 1999
 Bldg 600 YK Hospital Site
 42°F
 Cloudy

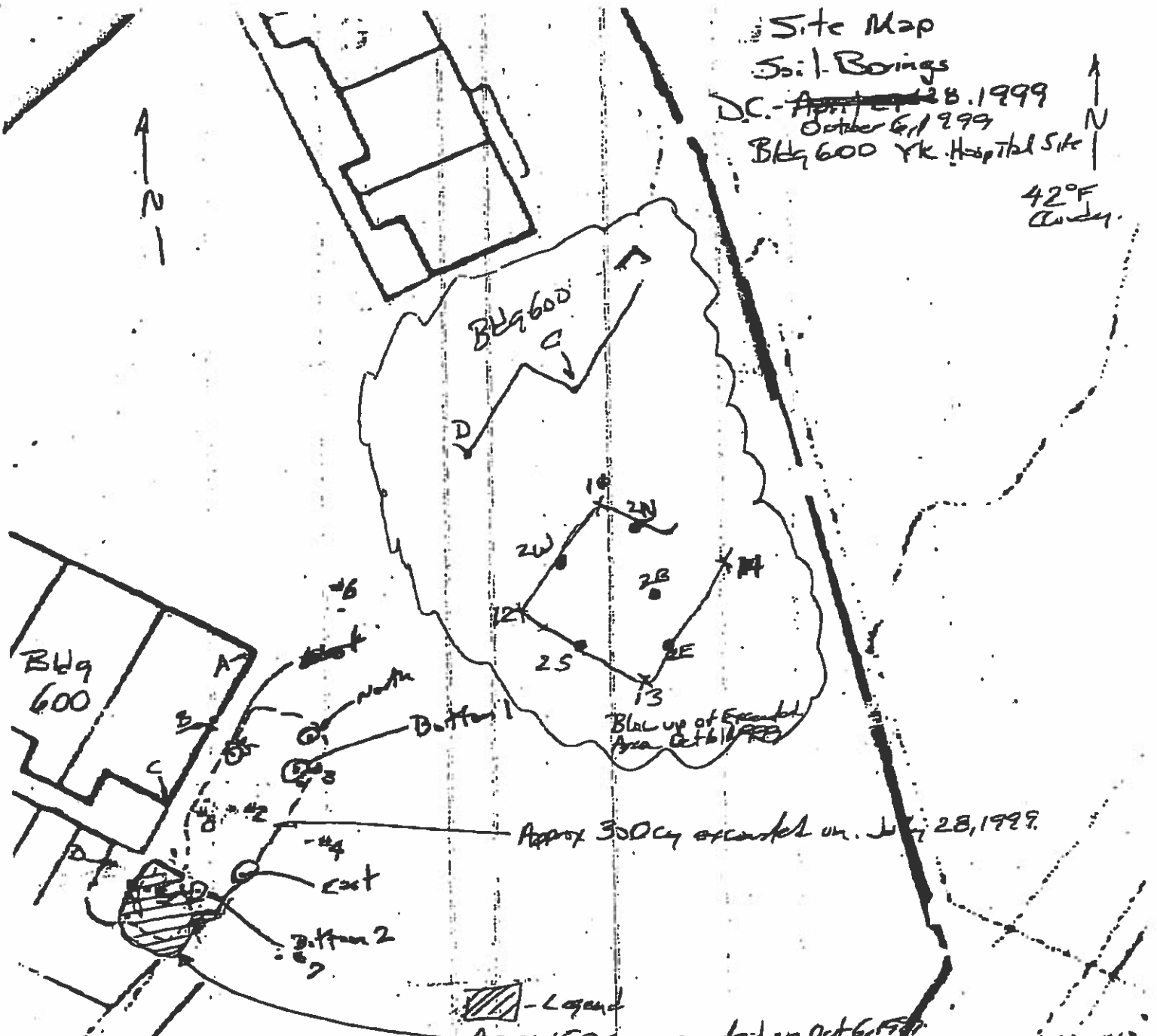

Distance (ft) from Boring to Temporary Benchmark

	A	B	C	D
11	-	-	23	28
12	-	-	36	8
13	-	-	46	22
14	-	-	34	34
2N	-	-	22	13
2B	-	-	31	15
2E	-	-	26	23
2W	-	-	43	33

Legend
 Approx 150cy excavated on Oct 6, 1999
 Approx 7cy hauled to Long, San Jose, CA on Oct 6, 1999

EXIST