

Table 1
Soil Analytical Data
(Petroleum Hydrocarbons)

Delta Western/Former Chevron Bulk Terminal #1001467
 1417 Peninsula Street
 Wrangell, Alaska

Sample Description	Sample Depth (feet)	Date Sampled	GRO (ppm)	Benzene (ppm)	Toluene (ppm)	Ethyl-benzene (ppm)	Total Xylenes (ppm)	DRO (ppm)	RRO (ppm)
SW-1	6.0'	09/30/03	--	--	--	--	--	183	<250
SW-2	2.5'	09/30/03	--	--	--	--	--	199	<250
SW-3	3.5'	09/30/03	--	--	--	--	--	1,150	<250
SW-4	3.0'	09/30/03	--	--	--	--	--	2,300	314
SW-5	3.5'	09/30/03	--	--	--	--	--	1,260	<250
SW-6	2.0'	09/30/03	--	--	--	--	--	2,110	<250
SW-7	2.5'	08/10/04	<64.4	0.428	<0.644	<0.644	<1.29	222	305
	4.5'	08/10/04	<6.17	0.0330	<0.0617	<0.0617	<0.123	<4.00	<25.0
	5.0'	08/10/04	<43.5	<0.174	<0.435	<0.435	<0.870	19.4	<115
SW-8	2.5'	08/10/04	61.9	0.235	<0.459	0.479	<0.918	443	336
	4.5'	08/10/04	7.76	0.0241	<0.0500	<0.0500	<0.100	7.80	<25.0
	5.0'	08/10/04	<52.1	<0.208	<0.521	<0.521	<1.04	<19.6	<123
SW-9	2.5'	08/10/04	147	0.328	<0.563	<0.563	1.13	142	270
	4.5'	08/10/04	<3.08	0.0141	<0.0308	<0.0308	0.101	<4.00	<25.0
	4.8'	08/10/04	<44.2	<0.177	<0.442	<0.442	<0.884	<16.9	<106
SW-10	4.3'	08/11/04	--	--	--	--	--	<4.00	<25.0
SW-11	4.5'	08/11/04	--	--	--	--	--	<4.00	<25.0
	6.0'	08/11/04	--	--	--	--	--	<4.00	<25.0
SW-12	3.0'	08/11/04	--	--	--	--	--	<4.00	<25.0
SW-13	4.0'	08/11/04	--	--	--	--	--	4.45	<25.0
	5.5'	08/11/04	--	--	--	--	--	<4.00	<25.0
SW-14	4.0'	08/11/04	--	--	--	--	--	<4.00	<25.0
	5.0'	08/11/04	--	--	--	--	--	48.6	<74.4
TF-1,1.5'	2.5'	10/01/03	4,440	1.70	4.93	26.5	87.6	6,860	<250
TF-1,2.5'	2.5'	10/01/03	2,440	<0.767	2.12	14.9	29.8	1,700	<250
TF-2,1.5'	1.5'	10/01/03	9.25	<0.0129	<0.0323	<0.0323	0.136	3,090	<250
TF-2,2.8'	2.8'	10/01/03	633	0.258	<0.423	1.36	4.35	1,580	<250
TF-3,1.5'	1.5'	10/01/03	417	0.291	<0.388	1.49	7.66	4,210	<250
TF-3,2.5'	2.5'	10/01/03	486	0.298	<0.308	3.17	21.3	2,080	<250
TF-4,1.5'	1.5'	10/02/03	736	0.239	<0.345	9.01	14.5	20,200	<1000
TF-5,1.5'	1.5'	10/01/03	18.8	<0.157	<0.0393	<0.0393	0.278	705	<250
TF-5,2.8'	2.8'	10/01/03	10.4	<0.0123	<0.0307	<0.0307	0.0846	193	<250
TF-6,2.0'	2.0'	10/02/03	52.6	<0.0157	<0.0393	0.137	0.709	2,790	<250
TF-7,1.5'	1.5'	10/01/03	101	<0.0917	<0.229	<0.229	1.85	6,300	1,540
TF-8,2.0'	2.0'	10/02/03	<4.33	<0.0173	<0.0433	<0.0433	<0.0866	75.5	<250
FOC-1,2.0'	2.0'	10/03/03	--	--	--	--	--	1,040	<574
FOC-1,3.5'	3.5'	10/03/03	--	--	--	--	--	1,040	1,250

Table 1
Soil Analytical Data
(Petroleum Hydrocarbons)

Delta Western/Former Chevron Bulk Terminal #1001467
 1417 Peninsula Street
 Wrangell, Alaska

Sample Description	Sample Depth (feet)	Date Sampled	GRO (ppm)	Benzene (ppm)	Toluene (ppm)	Ethyl-benzene (ppm)	Total Xylenes (ppm)	DRO (ppm)	RRO (ppm)
FOC-2,1.0'	1.0'	10/03/03	--	--	--	--	--	107	<283
FOC-2,2.0'	2.0'	10/03/03	--	--	--	--	--	406	697
FOC-3,1.5'	1.5'	10/03/03	--	--	--	--	--	34,900	7,720
FOC-3,2.5'	2.5'	10/03/03	--	--	--	--	--	99,500	<19,600
FOC-4,2.0'	2.0'	10/03/03	--	--	--	--	--	1,860	1,740
FOC-4,3.5'	3.5'	10/03/03	--	--	--	--	--	721	<1,300
FOC-4,5.0'	5.0'	10/03/03	--	--	--	--	--	591	2,460

Notes:

GRO = gasoline-range organics
 DRO = diesel-range organics
 RRO = residual-range organics
 ND = not detected - all compounds
 -- = not analyzed
 ppm = parts per million
 * = Sample was re-extracted to confirm the original DRO result, which was twenty times lower than the batch blank result
 < = not detected at or above laboratory detection limit shown

Table 2
Groundwater Analytical Data
(Petroleum Hydrocarbons)

Delta Western/Former Chevron Bulk Terminal #1001467
1417 Peninsula Street
Wrangell, Alaska

Sample Description	Date Monitored	Well Elevation (feet-MSL)	Depth to Water (feet TOC)	Groundwater Elevation (feet-MSL)	SPH Thickness (feet)	Date Sampled	GRO (ppb)	Benzene (ppb)	Toluene (ppb)	Ethyl-benzene (ppb)	Total Xylenes (ppb)	DRO (ppb)	RRO (ppb)	TAH (ppb)	TAQH (ppb)
<i>Groundwater Monitoring Wells</i>															
MW-1	10/31/01	38.51	5.47	33.04	0.00	10/31/01	<50.0	0.767	<0.500	<0.500	<1.00	612	<750	0.767	--
	03/27/02	38.51	3.24	35.27	0.00	03/27/02	<50.0	<0.200	13.8	<0.500	<1.00	1,010	<750	13.8	--
	06/24/02	38.51	5.92	32.59	0.00	06/25/02	<50.0	1.64	3.96	<0.500	<1.00	874	<750	5.60	--
	09/23/02	38.51	3.32	35.19	0.00	09/23/02	<50.0	<0.200	1.50	<0.500	<1.00	308	<750	1.50	--
	12/13/02	38.51	3.22	35.29	0.00	12/13/02	<50.0	<0.200	0.944	<0.500	<1.00	382	<750	0.944	--
	03/28/03	38.51	3.74	34.77	0.00	03/29/03	<50.0	<0.200	<0.500	<0.500	<1.00	149	<750	ND	--
	10/02/03	38.51	4.01	34.50	0.00	10/03/03	<50.0	<0.200	<0.500	<0.500	<1.00	376	<750	ND	1.91
	08/10/04	38.51	4.56	33.95	0.00	08/12/04	<50.0	0.210	<0.500	<0.500	<1.00	<100	<750	0.210	--
	02/21/05	38.51	4.80	33.71	0.00	02/21/05	<50.0	<0.200	1.95	<0.500	<1.00	<100	<750	1.95	2.64
	05/22/05	38.51	5.86	32.65	0.00	05/22/05	<50.0	0.729	<0.500	<0.500	<1.00	<94.3	<708	0.729	--
MW-2	10/31/01	33.36	1.66	31.70	0.00	10/31/01	80.2	16.0	0.683	<0.500	7.57	2,240	<750	24.3	26.8
	03/27/02	33.36	0.60	32.76	0.00	03/27/02	61.8	8.93	0.652	0.634	5.37	2,030	819	15.6	17.0
	06/24/02	33.36	3.90	29.46	0.00	06/25/02	67.8	21.9	<0.500	<0.500	<1.00	2,700	2,370	21.9	23.2
	09/23/02	33.36	1.01	32.35	0.00	09/23/02	<50.0	7.15	<0.500	<0.500	1.47	426	<750	8.62	10.7
	12/13/02	33.36	1.91	31.45	0.00	12/14/02	<50.0	5.51	<0.500	<0.500	1.07	715	<750	6.58	7.24
	03/28/03	33.36	1.26	32.10	0.00	03/29/03	<50.0	6.07	<0.500	<0.500	1.30	582	<750	7.37	7.94
	10/02/03	33.36	3.37	29.99	0.00	10/03/03	<50.0	1.27	<0.500	<0.500	<1.00	738	<750	1.27	2.91
	08/10/04	33.36	3.73	29.63	0.00	08/12/04	<50.0	2.10	<0.500	<0.500	<1.00	188	<750	2.10	--
	02/21/05						WELL INACCESSIBLE								
	05/22/05	33.36	4.05	29.31	0.00	05/22/05	<50.0	0.907	<0.500	<0.500	<1.00	140	<708	0.907	ND
MW-3	10/31/01	34.65	0.00	34.65	0.00	10/31/01	243	12.3	21.3	4.21	25.6	2,150	<750	63.4	--
	03/27/02	34.65	0.02	34.63	0.00	4/26/02 ^C	363	8.65	50.2	7.38	22.0	3,920	1,190	88.2	--
	06/24/02	34.65	0.60	34.05	0.00	06/25/02	363	7.99	57.2	10.3	20	1,840	859	95.5	--
	09/23/02	34.65	0.00	34.65	0.00	09/23/02	181	2.11	6.88	4.11	4.75	1,440	<750	17.9	--
	12/13/02	34.65	0.50	34.15	0.00	12/14/02	314	4.90	15.6	6.16	12.1	3,080	938	38.8	--
	03/28/03	34.65	0.05	34.60	0.00	03/29/03	286	4.76	3.60	8.18	10.4	1,630	<750	27.0	--
	10/02/03	34.65	0.12	34.53	0.00	10/03/03	342	4.43	2.03	6.86	7.34	580	<750	20.7	--
	08/10/04	34.65	0.83	33.82	0.00	08/10/04	305	5.06	4.63	0.703	3.08	2,470	<750	13.5	18.3
WELL REMOVED ON 8/10/04															

Table 2
Groundwater Analytical Data
(Petroleum Hydrocarbons)

Delta Western/Former Chevron Bulk Terminal #1001467
1417 Peninsula Street
Wrangell, Alaska

Sample Description	Date Monitored	Well Elevation (feet-MSL)	Depth to Water (feet TOC)	Groundwater Elevation (feet-MSL)	SPH Thickness (feet)	Date Sampled	Date			Ethyl-benzene (ppb)	Total Xylenes (ppb)	DRO (ppb)	RRO (ppb)	TAH (ppb)	TAQH (ppb)	
							GRO (ppb)	Benzene (ppb)	Toluene (ppb)							
MW-4	10/31/01	28.80	0.21	28.59	0.00	10/31/01	<50.0	1.43	2.18	0.510	2.30	7,230	922	6.42	7.64	
	03/27/02	28.80	0.50	28.30	0.00	03/27/02	90.3	2.94	28.1	<0.500	<1.00	1,950	<750	31.0	32.4	
	06/24/02	28.80	0.64	28.16	0.00	06/25/02	104	3.12	36.4	<0.500	<1.00	1,830	776	39.5	40.2	
	09/23/02	28.80	0.00	28.80	0.00	09/23/02	77.3	1.80	27.1	<0.500	<1.00	735	<750	28.9	29.6	
	12/13/02	28.80	1.38	27.42	0.00	12/14/02	<50.0	1.39	1.31	<0.500	<1.00	1,990	<750	2.70	3.30	
	03/28/03	28.80	0.40	28.40	0.00	03/29/03	<50.0	2.23	<0.500	<0.500	<1.00	2,010	<750	2.23	3.55	
	10/02/03	28.80	0.57	28.23	0.00	10/03/03	<50.0	1.47	<0.500	<0.500	<1.00	1,790	<750	1.47	3.45	
	08/10/04	28.80	1.02	27.78	0.00	08/12/04	<50.0	2.09	<0.500	<0.500	<1.00	724	<750	2.09	--	
	02/21/05						WELL INACCESSIBLE									
	05/22/05	28.80	1.95	26.85	0.00	05/22/05	<50.0	0.602	<0.500	<0.500	<1.00	871	<708	0.602	5.58	
MW-5	10/31/01	21.47	0.00	21.47	0.00	10/31/01	<50.0	<0.200	0.662	<0.500	<1.00	771	<750	0.662	12.7	
	03/27/02	21.47	0.30	21.17	0.00	4/26/02 ^C	106	<0.200	45.8	<0.500	<1.00	1,050	<750	45.8	49.8	
	06/24/02	21.47	0.33	21.14	0.00	06/25/02	137	<0.200	54.3	<0.500	<1.00	744	<750	54.3	--	
	09/23/02	31.47 ^b	9.38	22.09	0.00	09/23/02	69.5	<0.200	22.4	<0.500	<1.00	325	<750	22.4	24.9	
	12/13/02	31.47	9.77	21.70	0.00	12/13/02	<50.0	<0.200	15.4	<0.500	<1.00	311	<750	15.4	--	
	03/28/03	26.47	5.67	20.80	0.00	03/29/03	<50.0	<0.200	2.54	<0.500	<1.00	216	<750	219	219	
	10/02/03	26.47	5.69	20.78	0.00	10/03/03	439	<0.200	281	<0.500	<1.00	488	<750	281	283	
	08/10/04	26.47	5.83	20.64	0.00	08/12/04	<50.0	<0.200	0.808	<0.500	<1.00	<100	<750	0.808	1.06	
	02/21/05	26.47	4.78	21.69	0.00	02/21/05	<50.0	<0.200	0.887	<0.500	<1.00	<100	<750	0.887	2.11	
	05/22/05	26.47	5.94	20.53	0.00	05/22/05	75.2	<0.200	23.2	<0.500	<1.00	<94.3	<708	23.2	24.2	
MW-6	10/31/01	37.10	4.96	32.14	0.00	11/01/01	<50.0	0.391	<0.500	<0.500	<1.00	1,250	<840	0.391	0.491	
	03/27/02	37.10	3.88	33.22	0.00	4/26/02 ^C	541	0.397	12.2	<0.500	<1.00	13,200	<15,000	12.6	--	
	06/24/02	37.10	4.74	32.36	0.00	06/25/02	555	1.01	26.2	<2.50	<5.00	66,000	<7,500	27.2	--	
	09/23/02	37.10	3.95	33.15	0.00	09/23/02	1,210	<2.00	256	<5.00	<10.0	21,500	<7,500	256	475	
	12/13/02	37.10	4.73	32.37	0.00	12/13/02	1,420	1.74	309	<2.50	<5.00	31,000	803	311	--	
	03/28/03	37.10	3.61	33.49	0.00	03/29/03	455	3.61	236	3.06	17.6	7,720	<750	260	--	
	10/02/03	37.10	3.61	33.49	0.00	10/03/03	1,820	4.93	991	5.96	29.1	935	<750	1031	1035	
	08/10/04	37.10	4.88	32.22	0.00	08/12/04	347	0.718	128	1.42	4.90	2,420	792	135	139	
	02/21/05	37.10	3.68	33.42	0.00	02/21/05	740	1.12	433	2.25	9.24	265	<750	446	448	
	05/22/05	37.10	5.02	32.08	0.00	05/22/05	756	0.402	276	1.48	4.87	<94.3	<708	283	291	

Table 2
Groundwater Analytical Data
(Petroleum Hydrocarbons)

Delta Western/Former Chevron Bulk Terminal #1001467
1417 Peninsula Street
Wrangell, Alaska

Sample Description	Date Monitored	Well Elevation (feet-MSL)	Depth to Water (feet TOC)	Groundwater Elevation (feet-MSL)	SPH Thickness (feet)	Date Sampled	GRO	Benzene	Toluene	Ethyl-benzene	Total Xylenes	DRO	RRO	TAH	TAQH
							(ppb)	(ppb)	(ppb)	(ppb)	(ppb)	(ppb)	(ppb)	(ppb)	
MW-7	10/31/01	35.90	2.53	33.37	0.00	11/01/01	<50.0	0.271	<0.500	<0.500	<1.00	609	<750	0.271	--
	03/27/02	35.90	3.02	32.88	0.00	03/27/02	155	<0.400	68.3	<1.00	<2.00	7,610	<3,750	68.3	--
	06/24/02	35.90	3.63	32.27	0.00	06/25/02	234	<0.200	95.9	<0.500	<1.00	10,300	<750	95.9	--
	09/23/02	35.90	3.12	32.78	0.00	09/23/02	525	0.274	184	<0.500	<1.00	<100	<750	187	--
	12/13/02	35.90	3.85	32.05	0.00	12/14/02	374	<0.200	170	<0.500	<1.00	1,960	<750	170	--
	03/28/03	35.90	2.74	33.16	0.00	03/29/03	223	<0.200	146	<0.500	<1.00	799	<750	146	--
	10/02/03	35.90	2.78	33.12	0.00	10/03/03	97.5	<0.200	59.3	<0.500	<1.00	827	<750	59.3	--
	08/10/04	35.90	4.60	31.30	0.00	08/12/04	<50.0	<0.200	1.75	<0.500	<1.00	<100	<750	1.75	--
	02/21/05	35.90	2.42	33.48	0.00	02/21/05	<50.0	<0.200	0.808	<0.500	<1.00	<100	<750	0.808	--
05/22/05	35.90	3.39	32.51	0.00	05/22/05	<50.0	<0.200	3.20	<0.500	<1.00	<94.3	<708	3.20	--	
MW-8	10/31/01	43.16	6.24	36.92	Sheen	11/01/01	981	2.39	2.97	21.6	43.7	83,900	<30,000	70.7	--
	03/27/02	43.16	4.50	38.66	0.00	03/27/02	<50.0	<0.200	<0.500	<0.500	<1.00	10,200	<7,500	ND	--
	06/24/02	43.16	7.78	35.38	0.00	06/26/02	395	2.81	11.7	21.7	29.3	11,900	<750	65.5	--
	09/23/02	43.16	4.96	38.20	0.00	09/23/02	101	<0.200	19.3	<0.500	<1.00	4,480	<750	19.3	--
	12/13/02	43.16	6.00	37.16	0.00	12/14/02	87.7	<0.200	12.2	<0.500	<1.00	7,330	<750	12.2	--
	03/28/03	43.16	6.44	36.72	0.00	03/29/03	<50.0	<0.200	1.18	<0.500	<1.00	6,390	<750	1.18	--
	10/02/03	43.16	7.14	36.02	0.00	10/03/03	131	0.414	11.4	1.04	1.8	5,050	<750	14.7	--
	08/10/04	43.16	8.30	34.86	0.00	08/12/04	<50.0	<0.200	<0.500	<0.500	<1.00	1,400	<750	ND	--
	02/21/05	43.16	3.14	40.02	0.00	02/21/05	<50.0	<0.200	<0.500	<0.500	<1.00	<100	<750	ND	--
05/22/05	43.16	8.36	34.80	0.00	05/22/05	<50.0	<0.200	<0.500	<0.500	<1.00	--	--	ND	--	
MW-9	10/31/01	39.46	2.35	37.11	0.00	11/01/01	<50.0	0.389	0.717	<0.500	<1.00	404	<750	1.11	--
	03/27/02	39.46	3.00	36.46	0.00	03/27/02	<50.0	<0.200	1.36	<0.500	<1.00	802	<750	1.36	--
	06/24/02	39.46	3.76	35.70	0.00	06/25/02	<50.0	<0.200	2.07	<0.500	<1.00	270	<750	2.07	--
	09/23/02	39.46	2.79	36.67	0.00	09/23/02	<50.0	0.277	7.50	<0.500	<1.00	367	<750	7.78	--
	12/13/02	39.46	3.97	35.49	0.00	12/13/02	<50.0	<0.200	<0.500	<0.500	<1.00	187	<750	ND	--
	03/28/03	39.46	3.04	36.42	0.00	03/29/03	<50.0	<0.200	<0.500	<0.500	<1.00	<100	<750	ND	--
	10/02/03	39.46	3.09	36.37	0.00	10/03/03	<50.0	<0.200	3.61	<0.500	<1.00	540	<750	3.61	--
	08/10/04	39.46	3.74	35.72	0.00	08/12/04	<50.0	<0.200	<0.500	<0.500	<1.00	<100	<750	ND	--
	02/21/05	39.46	2.27	37.19	0.00	02/21/05	<50.0	<0.200	<0.500	<0.500	<1.00	143	<750	ND	--
05/22/05	39.46	4.40	35.06	0.00	05/22/05	<50.0	<0.200	<0.500	<0.500	<1.00	<94.3	<708	ND	--	

Table 2
Groundwater Analytical Data
(Petroleum Hydrocarbons)

Delta Western/Former Chevron Bulk Terminal #1001467
 1417 Peninsula Street
 Wrangell, Alaska

Sample Description	Date Monitored	Well Elevation (feet-MSL)	Depth to Water (feet TOC)	Groundwater Elevation (feet-MSL)	SPH Thickness (feet)	Date Sampled	GRO (ppb)	Benzene (ppb)	Toluene (ppb)	Ethyl-benzene (ppb)	Total Xylenes (ppb)	DRO (ppb)	RRO (ppb)	TAH (ppb)	TAQH (ppb)
<i>Tank Farm Pit Grab Samples</i>															
TF-2	--	--	--	--	--	10/01/03	1,110	1.64	1.09	6.67	12.1	4,380	<750	21.5	--
TF-4	--	--	--	--	--	10/01/03	1,240	5.81	1.28	97.3	102	53,900	2,550	206	--
<i>Seep Samples</i>															
Seep-1	--	--	--	--	--	11/01/01	<50.0	<0.200	<0.500	<0.500	<1.00	824	<750	ND	72.0
	--	--	--	--	--	03/27/02	<50.0	<0.200	<0.500	<0.500	<1.00	293	<750	ND	1.00
	--	--	--	--	--	06/25/02	<50.0	<0.200	<0.500	<0.500	<1.00	<100	<750	ND	9.50
	--	--	--	--	--	09/23/02	<50.0	<0.200	<0.500	<0.500	<1.00	178	<750	ND	35.2
	--	--	--	--	--	12/14/02	<50.0	<0.200	<0.500	<0.500	<1.00	152	<750	ND	ND
	--	--	--	--	--	03/29/03	<50.0	<0.200	1.09	<0.500	2.14	<100	<750	3.23	3.63
	--	--	--	--	--	10/03/03	<50.0	<0.200	<0.500	<0.500	<1.00	152	<750	ND	127
	--	--	--	--	--	08/10/04						DRY			
	--	--	--	--	--	02/21/05						DRY			
	--	--	--	--	--	05/22/05						DRY			
Seep-2	--	--	--	--	--	11/01/01	69.8	1.09	2.75	1.05	13.2	755	<1,430	18.1	19.0
	--	--	--	--	--	03/27/02	<50.0	<0.200	<0.500	<0.500	<1.00	<100	<750	ND	ND
	--	--	--	--	--	06/26/02	<50.0	0.275	0.572	<0.500	<1.00	642	1,160	0.847	1.68
	--	--	--	--	--	09/23/02	<50.0	<0.200	<0.500	<0.500	<1.00	<100	<750	ND	--
	--	--	--	--	--	12/14/02	<50.0	<0.200	<0.500	<0.500	<1.00	144	<750	ND	--
	--	--	--	--	--	03/29/03	<50.0	<0.200	<0.500	<0.500	<1.00	<100	<750	ND	ND
	--	--	--	--	--	10/03/03						DRY			
	--	--	--	--	--	08/10/04						DRY			
	--	--	--	--	--	02/21/05						DRY			
	--	--	--	--	--	05/22/05						DRY			
Table C Cleanup Levels	--	--	--	--	--	--	1,300	5	1,000	700	10,000	1,500	1,100	--	--
Surface Water Standards	--	--	--	--	0.00	--	--	--	--	--	--	--	--	10	15

Table 2
Groundwater Analytical Data
(Petroleum Hydrocarbons)

Delta Western/Former Chevron Bulk Terminal #1001467
 1417 Peninsula Street
 Wrangell, Alaska

Sample Description	Date Monitored	Well Elevation (feet-MSL)	Depth to Water (feet TOC)	Groundwater Elevation (feet-MSL)	SPH Thickness (feet)	Date Sampled	GRO (ppb)	Benzene (ppb)	Toluene (ppb)	Ethyl-benzene (ppb)	Total Xylenes (ppb)	DRO (ppb)	RRO (ppb)	TAH (ppb)	TAqH (ppb)
--------------------	----------------	---------------------------	---------------------------	----------------------------------	----------------------	--------------	-----------	---------------	---------------	---------------------	---------------------	-----------	-----------	-----------	------------

Notes:

GRO = gasoline range organics
 DRO = diesel range organics
 RRO = residual range organics
 MSL = mean sea level
 TOC = top of casing
 TAH = total aromatic hydrocarbons (totalled concentrations of benzene, toluene, ethyl-benzene, and total xylenes)
 TAqH = total aqueous hydrocarbons (totalled concentrations of TAH and total PAHs from Table 2)
 -- = not analyzed
 ND = not detected - all compounds
 ppb = parts per billion
 < = not detected at or above laboratory detection limit shown
 a = not detected at or above laboratory detection limit shown
 b = 10.0 feet of casing added to well due to residential construction activities.
 c = Re-sampled on 4/26/02 for GRO/BTEX Compounds due to container breakage by laboratory.
 d = 5.0 feet removed following residential construction activities

Table 3
Groundwater Analytical Data
(Polynuclear Aromatic Hydrocarbons)

Delta Western/Former Chevron Bulk Terminal #1001467
 1417 Peninsula Street
 Wrangell, Alaska

Analyte	Table C Standards	MW-1	MW-1	MW-2	MW-2	MW-2	MW-2	MW-2	MW-2	MW-2
		10/3/2003	2/21/2005	10/31/2001	3/27/2002	6/25/2002	9/23/2002	12/14/2002	10/3/2003	10/3/2003
<i>Polynuclear Aromatic Hydrocarbons in ppb</i>										
1-Methylnaphthalene	--	--	<0.100	--	--	--	--	--	--	--
2-Methylnaphthalene	--	--	<0.100	--	--	--	--	--	--	--
Acenaphthene	2,200	0.528	<0.100	<0.100	<0.100	<0.100	<0.100	<0.100	<0.100	<0.100
Acenaphthylene	--	<0.100	<0.100	<0.100	<0.100	<0.100	<0.100	<0.100	<0.100	<0.100
Anthracene	11,000	0.604	<0.100	<0.100	<0.100	<0.100	<0.100	<0.100	0.604	<0.100
Benzo (a) anthracene	1	<0.100	<0.100	<0.100	<0.100	<0.100	<0.100	<0.100	<0.100	<0.100
Benzo (a) pyrene	0.2	0.566	0.579	<0.100	<0.100	<0.100	<0.100	<0.100	0.566	<0.100
Benzo (b) fluoranthene	1	<0.100	<0.100	<0.100	<0.100	<0.100	<0.100	<0.100	<0.100	<0.100
Benzo (ghi) perylene	--	<0.100	<0.100	<0.100	0.152	<0.100	<0.100	<0.100	<0.100	<0.100
Benzo (k) fluoranthene	10	<0.100	<0.100	<0.100	<0.100	<0.100	0.491	<0.100	<0.100	<0.100
Chrysene	100	<0.100	<0.100	<0.100	<0.100	<0.100	<0.100	<0.100	<0.100	<0.100
Dibenzo (a,h) anthracene	0.1	<0.100	<0.100	<0.100	<0.100	<0.100	<0.100	<0.100	<0.100	<0.100
Fluoranthene	1,460	<0.100	0.111	<0.100	<0.100	<0.100	<0.100	<0.100	<0.100	<0.100
Fluorene	1,460	<0.100	<0.100	0.151	<0.100	<0.100	<0.100	<0.100	<0.100	<0.100
Indeno (1,2,3-cd) pyrene	1	<0.100	<0.100	<0.100	<0.100	<0.100	0.453	<0.100	<0.100	<0.100
Napthalene	1,460	0.208	<0.100	2.11	1.20	1.30	1.17	0.660	0.472	0.340
Phenanthrene	--	<0.100	<0.100	0.132	<0.100	<0.100	<0.100	<0.100	<0.100	<0.100
Pyrene	1,100	<0.100	<0.100	0.113	<0.100	<0.100	<0.100	<0.100	<0.100	<0.100
TOTAL PAH:	--	1.91	0.690	2.51	1.35	1.30	2.11	0.660	1.640	0.340

Notes:
 PAH = polynuclear aromatic hydrocarbons
 -- = not analyzed
 < = not detected at or above laboratory detection
 limit shown
 ppb = parts per billion

Table 3
Groundwater Analytical Data
(Polynuclear Aromatic Hydrocarbons)

Delta Western/Former Chevron Bulk Terminal #1001467
 1417 Peninsula Street
 Wrangell, Alaska

Analyte	Table C Standards	MW-2 5/22/2005	MW-3 8/10/2004	MW-4 10/31/2001	MW-4 3/27/2002	MW-4 6/25/2002	MW-4 9/23/2002	MW-4 12/14/2002	MW-4 10/3/2003	MW-4 8/12/2004
<i>Polynuclear Aromatic Hydrocarbons in ppb</i>										
1-Methylnaphthalene	--	<0.0943	1.59	--	--	--	--	--	--	0.362
2-Methylnaphthalene	--	<0.0943	0.140	--	--	--	--	--	--	0.209
Acenaphthene	2,200	<0.0943	0.328	<0.100	0.133	0.120	<0.100	<0.100	0.736	0.606
Acenaphthylene	--	<0.0943	<0.100	<0.100	<0.100	<0.100	<0.100	<0.100	<0.100	<0.100
Anthracene	11,000	<0.0943	<0.100	<0.100	<0.100	<0.100	<0.100	<0.100	0.623	<0.100
Benzo (a) anthracene	1	<0.0943	<0.100	<0.100	<0.100	<0.100	<0.100	<0.100	<0.100	<0.100
Benzo (a) pyrene	0.2	<0.0943	0.260	<0.100	<0.100	<0.100	<0.100	<0.100	<0.100	<0.100
Benzo (b) fluoranthene	1	<0.0943	<0.100	<0.100	<0.100	<0.100	<0.100	<0.100	<0.100	<0.100
Benzo (ghi) perylene	--	<0.0943	<0.100	<0.100	<0.100	<0.100	<0.100	<0.100	<0.100	<0.100
Benzo (k) fluoranthene	10	<0.0943	<0.100	<0.100	<0.100	<0.100	<0.100	<0.100	<0.100	<0.100
Chrysene	100	<0.0943	<0.100	<0.100	<0.100	<0.100	<0.100	<0.100	<0.100	<0.100
Dibenzo (a,h) anthracene	0.1	<0.0943	<0.100	<0.100	<0.100	<0.100	<0.100	<0.100	<0.100	<0.100
Fluoranthene	1,460	<0.0943	<0.100	0.150	<0.100	<0.100	<0.100	<0.100	<0.100	<0.100
Fluorene	1,460	<0.0943	0.864	0.337	0.114	<0.100	<0.100	<0.100	<0.100	0.242
Indeno (1,2,3-cd) pyrene	1	<0.0943	<0.100	<0.100	<0.100	<0.100	<0.100	<0.100	<0.100	<0.100
Napthalene	1,460	<0.0943	1.41	0.730	1.18	0.580	0.698	0.604	0.623	1.62
Phenanthrene	--	<0.0943	0.251	<0.100	<0.100	<0.100	<0.100	<0.100	<0.100	0.136
Pyrene	1,100	<0.0943	<0.100	<0.100	<0.100	<0.100	<0.100	<0.100	<0.100	<0.100
TOTAL PAH:	--	<i>ND</i>	<i>4.84</i>	<i>1.22</i>	<i>1.43</i>	<i>0.700</i>	<i>0.698</i>	<i>0.604</i>	<i>1.98</i>	<i>3.18</i>

Notes:
 PAH = polynuclear aromatic hydrocarbons
 -- = not analyzed
 < = not detected at or above laboratory detection
 limit shown
 ppb = parts per billion

Table 3
Groundwater Analytical Data
(Polynuclear Aromatic Hydrocarbons)

Delta Western/Former Chevron Bulk Terminal #1001467
 1417 Peninsula Street
 Wrangell, Alaska

Analyte	Table C Standards	MW-4 5/22/2005	MW-5 10/31/2001	MW-5 3/27/2002	MW-5 9/23/2002	MW-5 10/3/2003	MW-5 8/12/2004	MW-5 2/21/2005	MW-5 5/22/2005	MW-6 11/1/2001
<i>Polynuclear Aromatic Hydrocarbons in ppb</i>										
1-Methylnaphthalene	--	0.677	--	--	--	--	<0.100	<0.100	<0.0943	--
2-Methylnaphthalene	--	<0.0943	--	--	--	--	<0.100	<0.100	<0.0943	--
Acenaphthene	2,200	2.07	0.202	<0.100	<0.100	0.528	<0.100	<0.100	<0.0943	<0.100
Acenaphthylene	--	<0.0943	<0.100	<0.100	<0.100	<0.100	<0.100	<0.100	<0.0943	<0.100
Anthracene	11,000	<0.0943	0.956	0.171	0.151	0.642	<0.100	<0.100	<0.0943	<0.100
Benzo (a) anthracene	1	<0.0943	1.08	0.457	<0.100	<0.100	<0.100	0.130	0.323	<0.100
Benzo (a) pyrene	0.2	<0.0943	0.754	<0.100	0.358	0.566	<0.100	0.113	<0.0943	<0.100
Benzo (b) fluoranthene	1	<0.0943	1.01	0.686	<0.100	<0.100	<0.100	0.108	<0.0943	<0.100
Benzo (ghi) perylene	--	<0.0943	0.423	0.133	<0.100	<0.100	<0.100	<0.100	<0.0943	<0.100
Benzo (k) fluoranthene	10	<0.0943	0.331	0.229	0.491	<0.100	<0.100	0.115	<0.0943	<0.100
Chrysene	100	<0.0943	0.901	0.343	<0.100	<0.100	<0.100	0.138	<0.0943	<0.100
Dibenzo (a,h) anthracene	0.1	<0.0943	0.202	<0.100	0.528	<0.100	<0.100	<0.100	<0.0943	<0.100
Fluoranthene	1,460	<0.0943	1.91	0.648	0.151	<0.100	0.102	0.236	0.53	<0.100
Fluorene	1,460	0.875	0.294	0.114	0.113	<0.100	<0.100	<0.100	<0.0943	<0.100
Indeno (1,2,3-cd) pyrene	1	<0.0943	0.441	<0.100	0.453	<0.100	<0.100	<0.100	<0.0943	<0.100
Napthalene	1,460	1.18	0.312	<0.100	<0.100	0.170	<0.100	<0.100	<0.0943	<0.100
Phenanthrene	--	0.175	1.67	0.533	0.208	0.151	0.149	0.206	0.119	0.100
Pyrene	1,100	<0.0943	1.54	0.648	<0.100	<0.100	<0.100	0.181	<0.0943	<0.100
TOTAL PAH:	--	4.98	12.0	3.96	2.45	2.06	0.251	1.23	0.972	0.100

Notes:
 PAH = polynuclear aromatic hydrocarbons
 -- = not analyzed
 < = not detected at or above laboratory detection
 limit shown
 ppb = parts per billion

Table 3
Groundwater Analytical Data
(Polynuclear Aromatic Hydrocarbons)

Delta Western/Former Chevron Bulk Terminal #1001467
 1417 Peninsula Street
 Wrangell, Alaska

Analyte	Table C Standards	MW-6	MW-6	MW-6	MW-6	MW-6	SEEP-1	SEEP-1	SEEP-1	SEEP-1
		9/23/2002	10/3/2003	8/12/2004	2/21/2005	5/22/2005	11/1/2001	3/27/2002	6/25/2002	9/23/2002
<i>Polynuclear Aromatic Hydrocarbons in ppb</i>										
1-Methylnaphthalene	--	--	--	0.792	0.340	0.300	--	--	--	--
2-Methylnaphthalene	--	--	--	1.26	0.332	0.375	--	--	--	--
Acenaphthene	2,200	<0.100	<0.100	<0.100	<0.100	<0.0943	0.114	0.200	<0.100	<0.100
Acenaphthylene	--	<0.100	<0.100	<0.100	<0.100	<0.0943	<0.100	<0.100	<0.100	0.226
Anthracene	11,000	<0.100	<0.100	0.283	<0.100	<0.0943	1.38	<0.100	<0.100	0.415
Benzo (a) anthracene	1	<0.100	<0.100	<0.100	<0.100	<0.0943	8.12	<0.100	1.20	4.17
Benzo (a) pyrene	0.2	<0.100	<0.100	<0.100	<0.100	<0.0943	4.26	<0.100	0.540	2.36
Benzo (b) fluoranthene	1	<0.100	<0.100	<0.100	<0.100	<0.0943	11.0	<0.100	0.900	3.34
Benzo (ghi) perylene	--	<0.100	<0.100	<0.100	<0.100	<0.0943	1.49	<0.100	0.200	0.717
Benzo (k) fluoranthene	10	<0.100	<0.100	<0.100	<0.100	<0.0943	3.08	<0.100	0.500	3.45
Chrysene	100	<0.100	<0.100	<0.100	<0.100	<0.0943	8.33	<0.100	1.02	4.40
Dibenzo (a,h) anthracene	0.1	<0.100	<0.100	<0.100	<0.100	<0.0943	0.530	<0.100	<0.100	<0.100
Fluoranthene	1,460	<0.100	<0.100	<0.100	<0.100	<0.0943	14.4	<0.100	2.64	7.81
Fluorene	1,460	3.77	<0.100	<0.100	<0.100	<0.0943	0.322	0.160	<0.100	0.245
Indeno (1,2,3-cd) pyrene	1	<0.100	<0.100	<0.100	<0.100	<0.0943	2.29	<0.100	0.200	1.13
Napthalene	1,460	215	4.36	1.42	1.42	1.15	<0.100	0.440	<0.100	<0.100
Phenanthrene	--	<0.100	<0.100	0.472	<0.100	<0.0943	1.84	0.200	<0.100	1.08
Pyrene	1,100	<0.100	<0.100	<0.100	<0.100	<0.0943	14.8	<0.100	2.30	5.89
TOTAL PAH:	--	219	4.36	4.23	2.09	1.83	72.0	1.00	9.50	35.2

Notes:
 PAH = polynuclear aromatic hydrocarbons
 -- = not analyzed
 < = not detected at or above laboratory detection
 limit shown
 ppb = parts per billion

Table 3
Groundwater Analytical Data
(Polynuclear Aromatic Hydrocarbons)

Delta Western/Former Chevron Bulk Terminal #1001467
 1417 Peninsula Street
 Wrangell, Alaska

Analyte	Table C Standards	SEEP-1	SEEP-1	SEEP-2	SEEP-2	SEEP-2
		12/14/2002	10/2/2003	10/31/2001	3/27/2002	9/23/2002
<i>Polynuclear Aromatic Hydrocarbons in ppb</i>						
1-Methylnaphthalene	--	--	--	--	--	--
2-Methylnaphthalene	--	--	--	--	--	--
Acenaphthene	2,200	<0.100	0.716	<0.100	<0.100	<0.100
Acenaphthylene	--	<0.100	1.01	<0.100	<0.100	<0.100
Anthracene	11,000	<0.100	3.26	<0.100	<0.100	<0.100
Benzo (a) anthracene	1	<0.100	15.1	<0.100	<0.100	<0.100
Benzo (a) pyrene	0.2	<0.100	6.40	<0.100	<0.100	0.340
Benzo (b) fluoranthene	1	<0.100	11.6	<0.100	<0.100	<0.100
Benzo (ghi) perylene	--	<0.100	2.10	<0.100	<0.100	<0.100
Benzo (k) fluoranthene	10	<0.100	6.30	<0.100	<0.100	0.491
Chrysene	100	<0.100	14.6	<0.100	<0.100	<0.100
Dibenzo (a,h) anthracene	0.1	<0.100	1.19	<0.100	<0.100	<0.100
Fluoranthene	1,460	<0.100	37.4	0.151	<0.100	<0.100
Fluorene	1,460	<0.100	0.247	<0.100	<0.100	<0.100
Indeno (1,2,3-cd) pyrene	1	<0.100	2.54	<0.100	<0.100	<0.100
Napthalene	1,460	<0.100	0.222	0.396	<0.100	<0.100
Phenanthrene	--	<0.100	1.11	0.189	<0.100	<0.100
Pyrene	1,100	<0.100	23.1	0.208	<0.100	<0.100
TOTAL PAH:	--	<i>ND</i>	<i>127</i>	<i>0.944</i>	<i>ND</i>	<i>0.831</i>

Notes:
 PAH = polynuclear aromatic hydrocarbons
 -- = not analyzed
 < = not detected at or above laboratory detection
 limit shown
 ppb = parts per billion

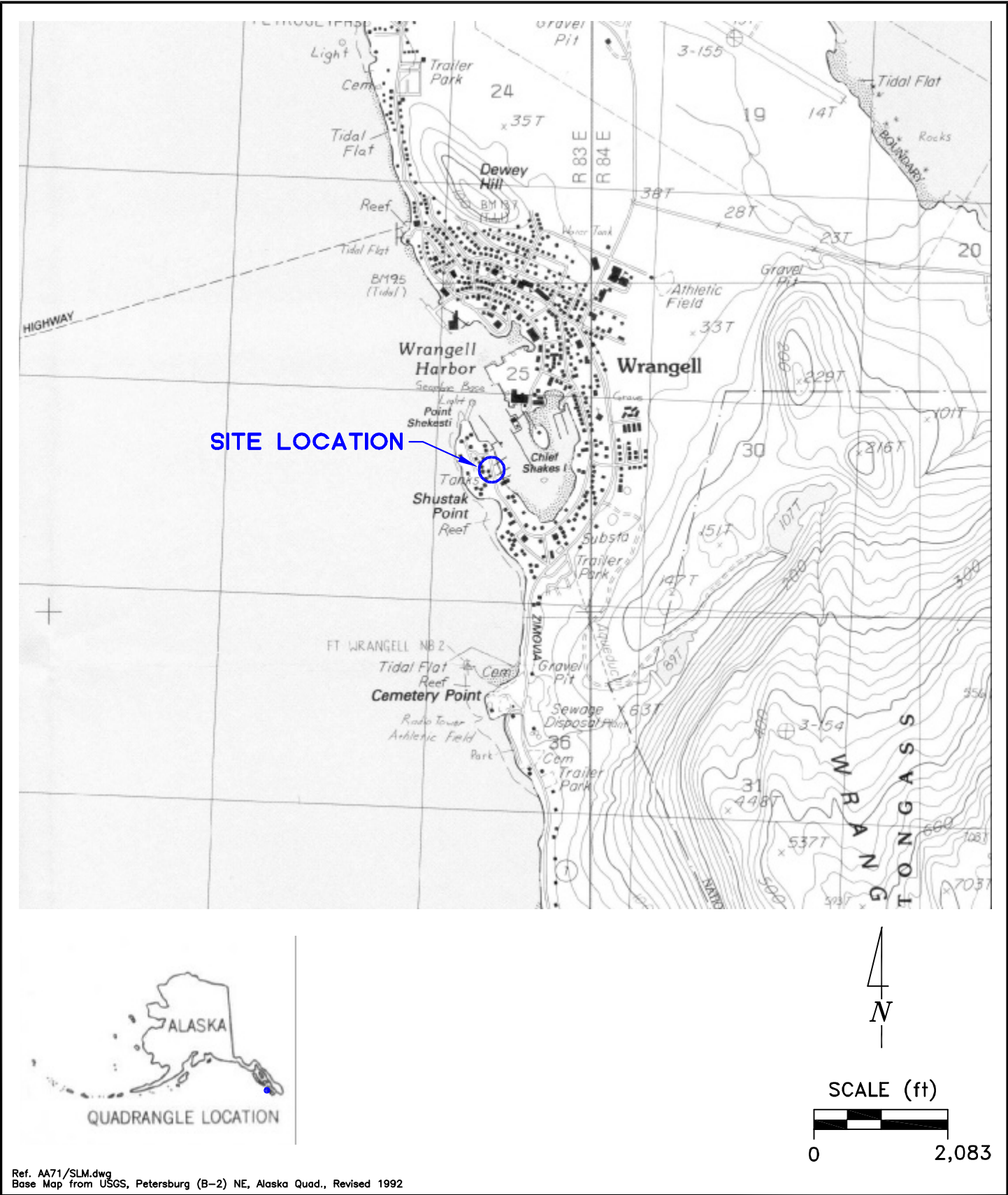

SITE LOCATION MAP
DELTA WESTERN / FORMER CHEVRON
BULK TERMINAL #1001467
 1417 Peninsula Street
 Wrangell, Alaska

FIGURE:
1
PROJECT:
 11467

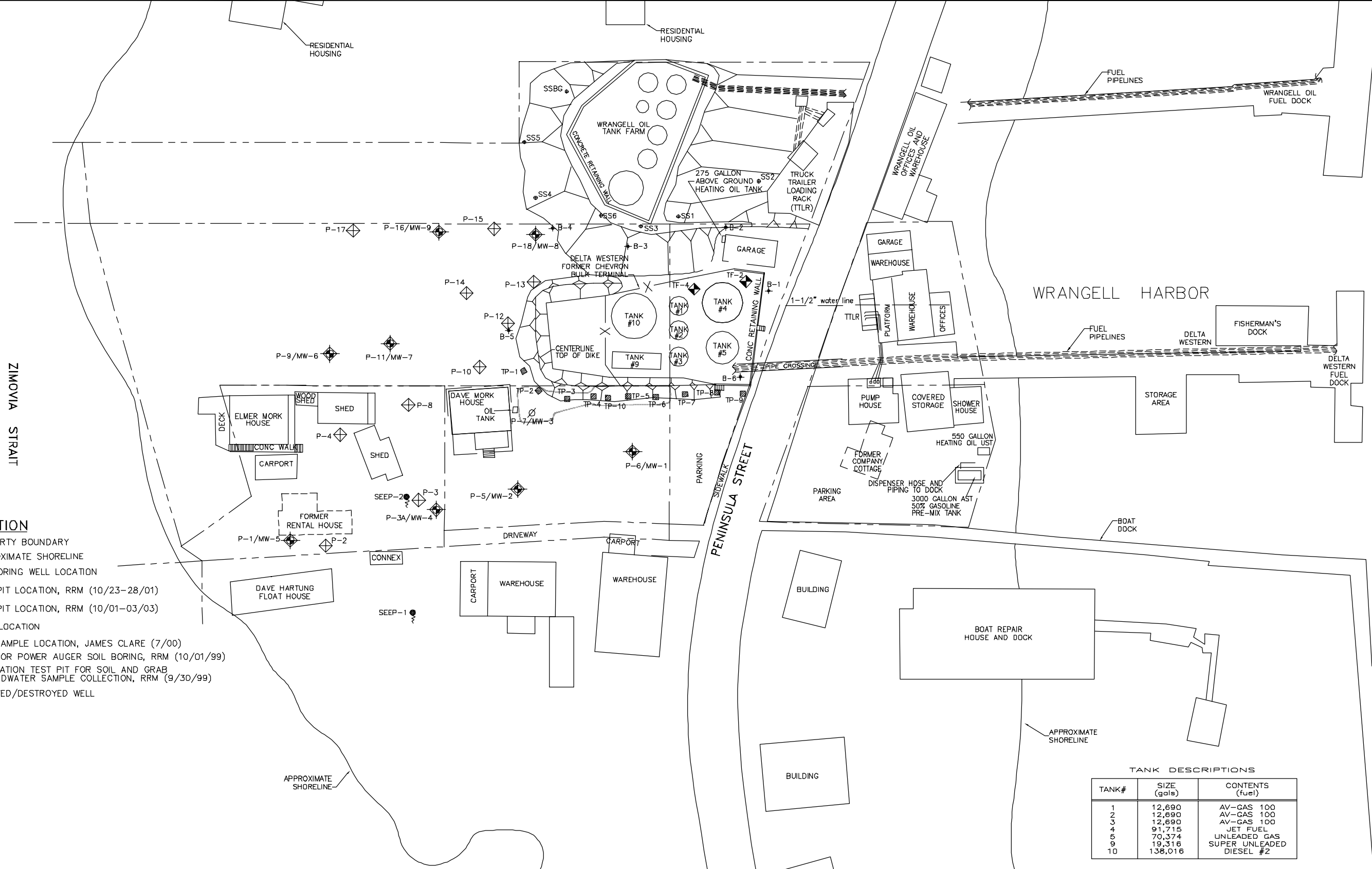
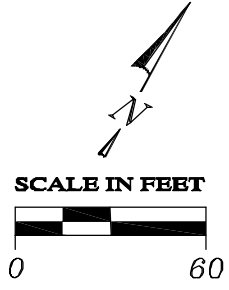

EXPLANATION

- PROPERTY BOUNDARY
- - - APPROXIMATE SHORELINE
- ⊕ MONITORING WELL LOCATION
- ◇ TEST PIT LOCATION, RRM (10/23-28/01)
- ◆ TEST PIT LOCATION, RRM (10/01-03/03)
- ⊙ SEEP LOCATION
- SS2⊕ SOIL SAMPLE LOCATION, JAMES CLARE (7/00)
- B-3 ⊕ HAND OR POWER AUGER SOIL BORING, RRM (10/01/99)
- TP-6 ⊕ EXCAVATION TEST PIT FOR SOIL AND GRAB GROUNDWATER SAMPLE COLLECTION, RRM (9/30/99)
- ⊘ REMOVED/DESTROYED WELL

TANK DESCRIPTIONS

TANK#	SIZE (gals)	CONTENTS (fuel)
1	12,690	AV-GAS 100
2	12,690	AV-GAS 100
3	12,690	AV-GAS 100
4	91,715	JET FUEL
5	70,374	UNLEADED GAS
9	19,316	SUPER UNLEADED
10	138,016	DIESEL #2



SITE MAP

**DELTA WESTERN / FORMER CHEVRON
BULK TERMINAL #1001467**

1417 Peninsula Street
Wrangell, Alaska

FIGURE:
2

PROJECT:
11467

Ref. A471/extend.dwg
Basemap from aerial photograph from Aeromap U.S. 7/26/98, Scale 1"=100'

D

D

C

C

B

B

A

A

EXPLANATION

- PROPERTY BOUNDARY
- APPROXIMATE SHORELINE
- MONITORING WELL LOCATION
- TEST PIT LOCATION, RRM (10/23-28/01)
- TEST PIT LOCATION, RRM (10/01-03/03)
- SEEP LOCATION
- SS2 SOIL SAMPLE LOCATION, JAMES CLARE (7/00)
- B-3 HAND OR POWER AUGER SOIL BORING, RRM (10/01/99)
- TP-6 EXCAVATION TEST PIT FOR SOIL AND GRAB GROUNDWATER SAMPLE COLLECTION, RRM (9/30/99)
- SOIL SAMPLE LOCATIONS, RRM (9/30/03)
- 2.0' DEPTH OF SAMPLE, IN FEET BELOW GROUND SURFACE
- 63.6 SOIL CONCENTRATION IN PARTS PER MILLION (ppm)
- NA NOT ANALYZED
- < NOT DETECTED AT OR ABOVE REPORTING LIMIT SHOWN
- * SAMPLE RE-ANALYZED DUE TO POOR QA/QC RESULTS
- GRO GASOLINE RANGE ORGANICS
- BENZ BENZENE
- DRO DIESEL RANGE ORGANICS
- RRO RESIDUAL RANGE ORGANICS

APPROXIMATE SHORELINE

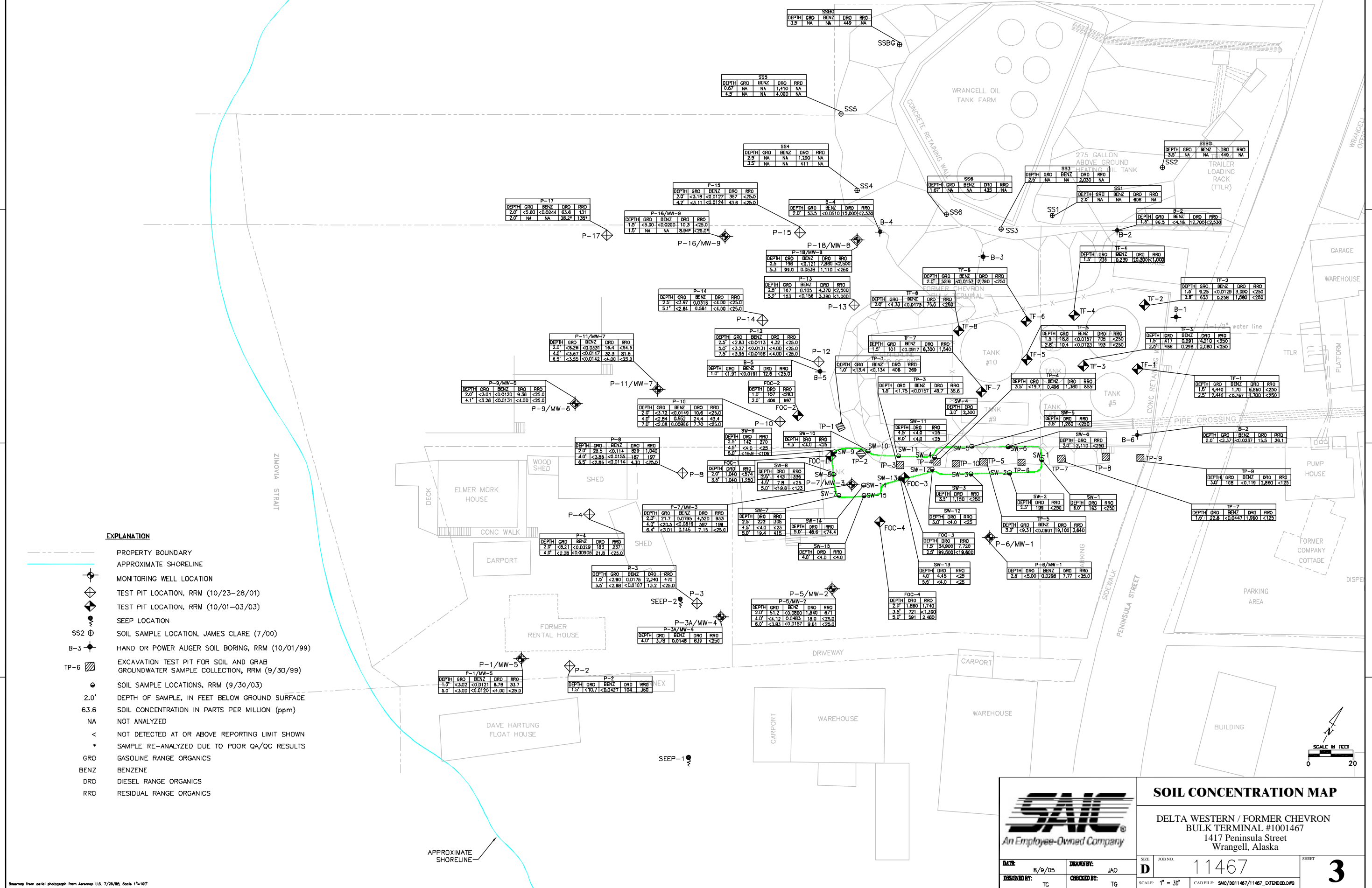

 SAIC An Employee-Owned Company		SOIL CONCENTRATION MAP	
DELTA WESTERN / FORMER CHEVRON BULK TERMINAL #1001467 1417 Peninsula Street Wrangell, Alaska			
DATE: 8/9/05	DRAWN BY: JAO	JOB NO.: 11467	SHEET: 3
DESIGNED BY: TG	CHECKED BY: TG	SCALE: 1" = 30'	CAD FILE: SMC/0011467/11467_EXTEND.DWG

Esomap from aerial photograph from Aerialmap U.S. 7/26/05, Scale 1"=100'

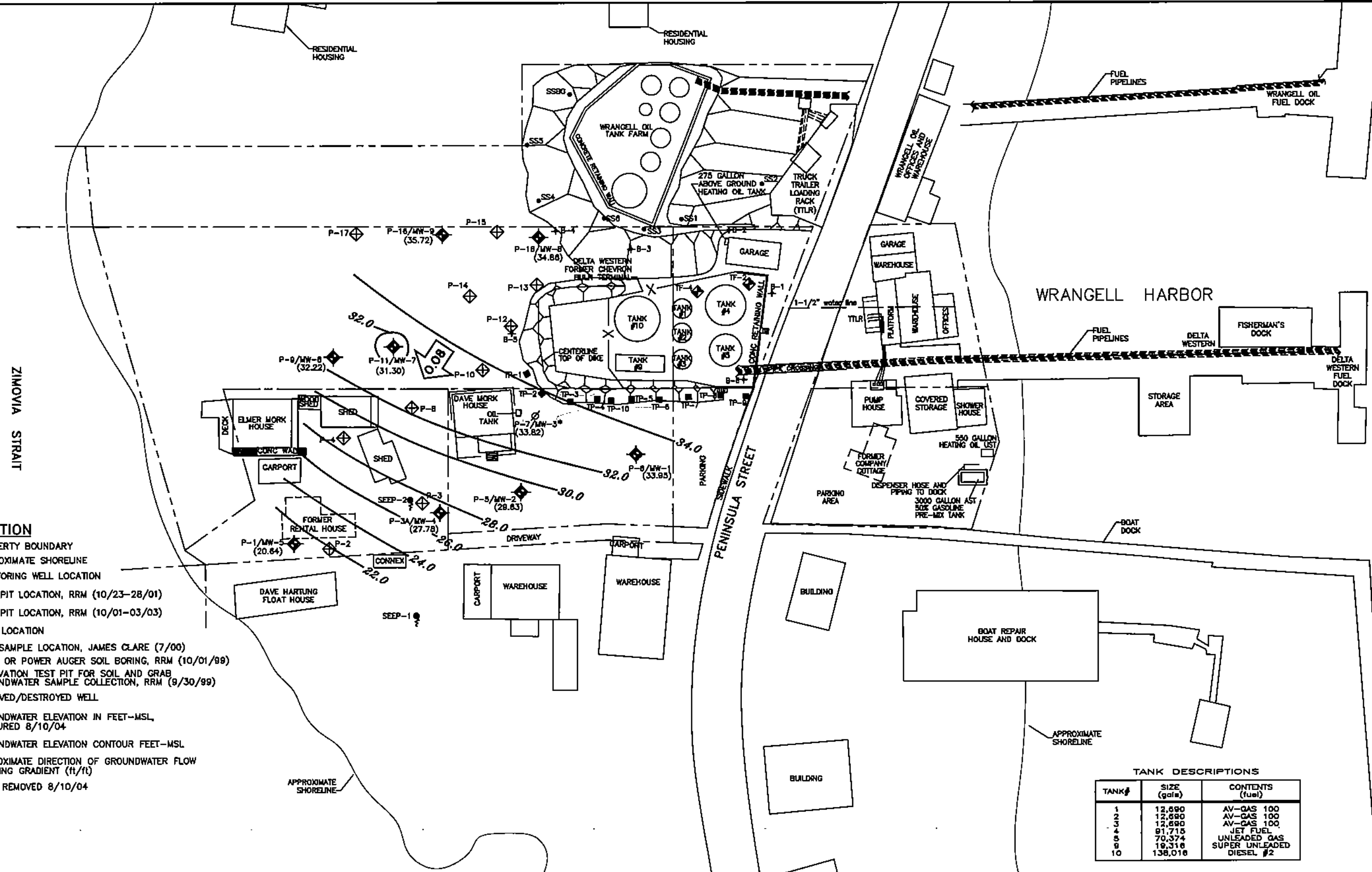
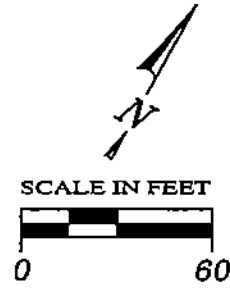

EXPLANATION

- PROPERTY BOUNDARY
- - - APPROXIMATE SHORELINE
- ⊕ MONITORING WELL LOCATION
- ⊕ TEST PIT LOCATION, RRM (10/23-28/01)
- ⊕ TEST PIT LOCATION, RRM (10/01-03/03)
- SEEP LOCATION
- SS2● SOIL SAMPLE LOCATION, JAMES CLARE (7/00)
- B-3+ HAND OR POWER AUGER SOIL BORING, RRM (10/01/89)
- TP-8 ■ EXCAVATION TEST PIT FOR SOIL AND GRAB GROUNDWATER SAMPLE COLLECTION, RRM (9/30/99)
- ⊘ REMOVED/DESTROYED WELL
- (20.64) GROUNDWATER ELEVATION IN FEET-MSL, MEASURED 8/10/04
- 22.0 GROUNDWATER ELEVATION CONTOUR FEET-MSL
- 0.08 APPROXIMATE DIRECTION OF GROUNDWATER FLOW SHOWING GRADIENT (ft/ft)
- WELL REMOVED 8/10/04

TANK DESCRIPTIONS

TANK#	SIZE (gals)	CONTENTS (fuel)
1	12,690	AV-GAS 100
2	12,690	AV-GAS 100
3	12,690	AV-GAS 100
4	81,715	JET FUEL
5	70,374	UNLEADED GAS
9	19,318	SUPER UNLEADED
10	136,018	DIESEL #2

Ref. A47/interdundg
 Drawings from aerial photograph from Aerialmap U.S. 7/26/94, Scale 1"=100'



**GROUNDWATER ELEVATION CONTOUR MAP,
 AUGUST 10, 2004**

**DELTA WESTERN / FORMER CHEVRON
 BULK TERMINAL #1001467**

1417 Peninsula Street
 Wrangell, Alaska

FIGURE:
4

PROJECT:
 11467



ZIMOVIA STRAIT

EXPLANATION

- PROPERTY BOUNDARY
- - - APPROXIMATE SHORELINE
- ⊕ MONITORING WELL LOCATION
- ◇ TEST PIT LOCATION, RRM (10/23-28/01)
- ◆ TEST PIT LOCATION, RRM (10/01-03/03)
- ⊙ SEEP LOCATION
- SS2⊕ SOIL SAMPLE LOCATION, JAMES CLARE (7/00)
- B-3 ⊕ HAND OR POWER AUGER SOIL BORING, RRM (10/01/99)
- TP-6 ⊕ EXCAVATION TEST PIT FOR SOIL AND GRAB GROUNDWATER SAMPLE COLLECTION, RRM (9/30/99)
- ⊘ REMOVED/DESTROYED WELL
- 439/<0.200 GRO/BENZENE CONCENTRATIONS IN GROUNDWATER IN PARTS PER BILLION (ppb) SAMPLED ON 8/12/04
- GRO GASOLINE RANGE ORGANICS
- < NOT DETECTED AT OR ABOVE REPORTING LIMIT SHOWN
- * WELL SAMPLED AND REMOVED 8/10/04

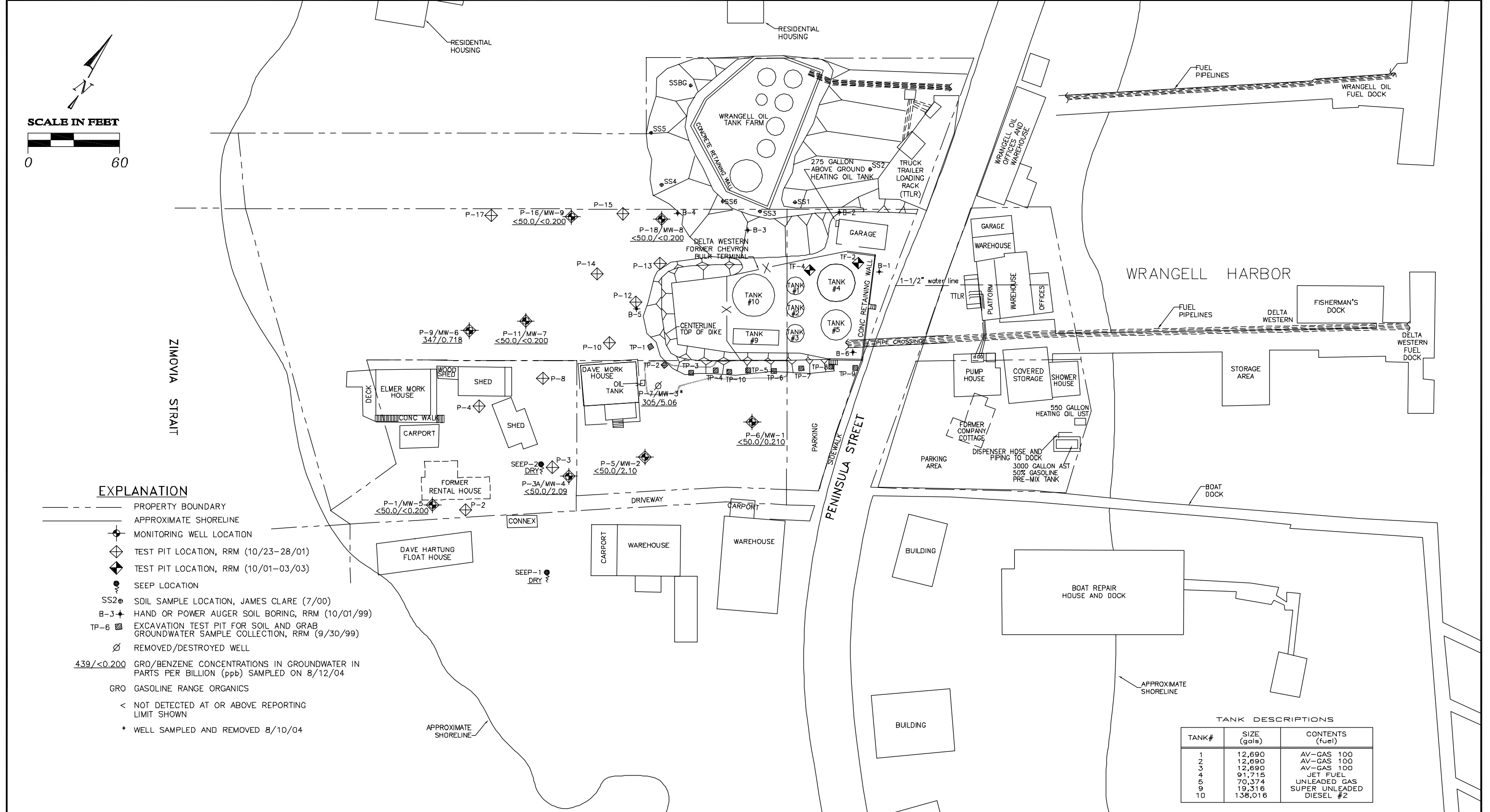

TANK DESCRIPTIONS

TANK#	SIZE (gals)	CONTENTS (fuel)
1	12,690	AV-GAS 100
2	12,690	AV-GAS 100
3	12,690	AV-GAS 100
4	9,715	JET FUEL
5	70,374	UNLEADED GAS
9	19,316	SUPER UNLEADED
10	138,016	DIESEL #2

Ref. A471/extend.dwg
 Basemap from aerial photograph from Aeromap U.S. 7/26/98, Scale 1"=100'



SAIC
An Employee-Owned Company

**GRO/BENZENE CONCENTRATIONS IN GROUNDWATER
AUGUST 12, 2004**

**DELTA WESTERN / FORMER CHEVRON
BULK TERMINAL #1001467**

1417 Peninsula Street
Wrangell, Alaska

FIGURE:
5

PROJECT:
11467

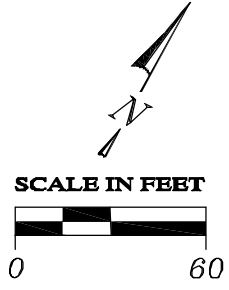

ZIMOVIA STRAIT

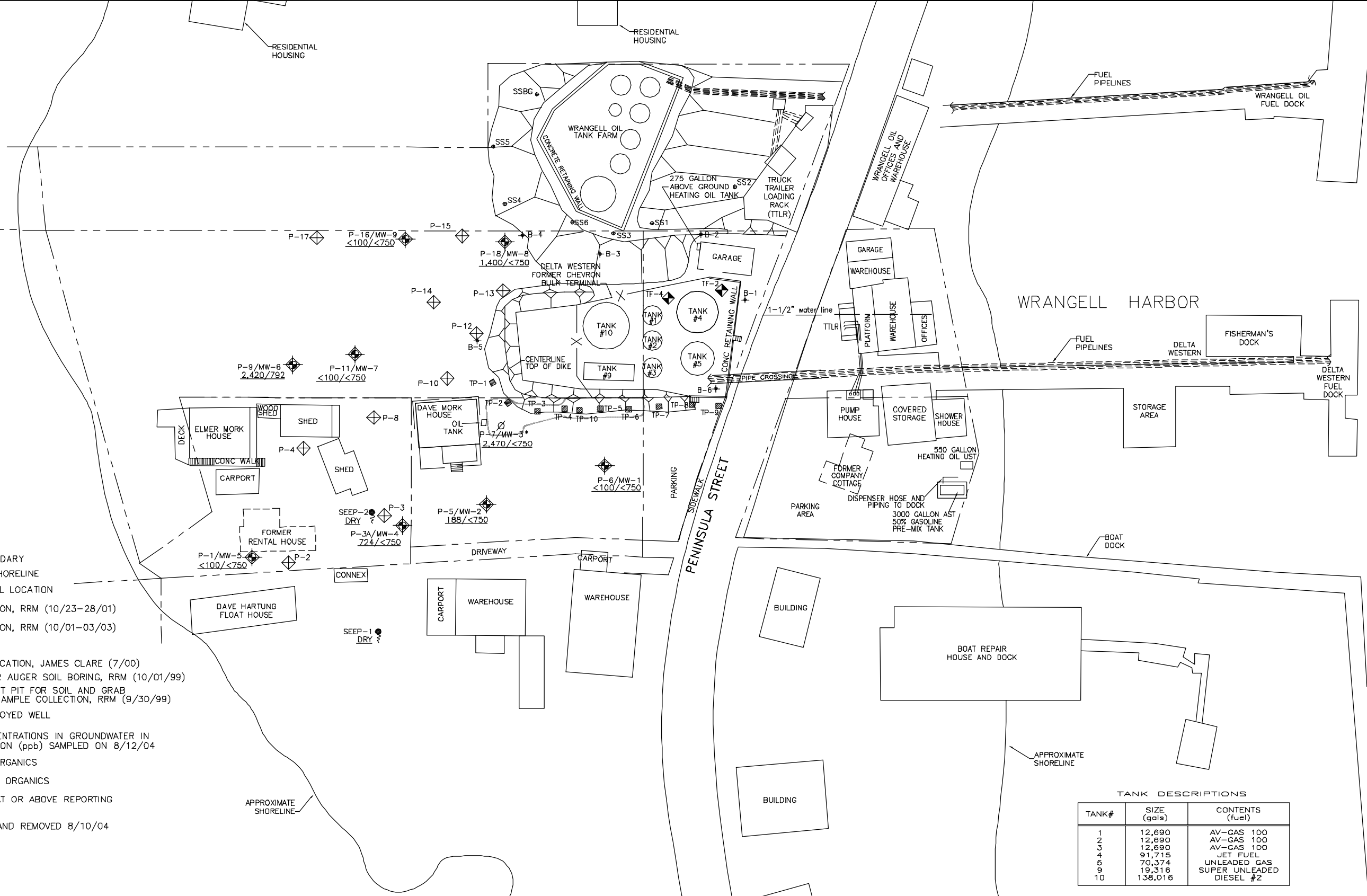

EXPLANATION

- PROPERTY BOUNDARY
- - - APPROXIMATE SHORELINE
- ⊕ MONITORING WELL LOCATION
- ◇ TEST PIT LOCATION, RRM (10/23-28/01)
- ◆ TEST PIT LOCATION, RRM (10/01-03/03)
- ⊙ SEEP LOCATION
- SS2⊕ SOIL SAMPLE LOCATION, JAMES CLARE (7/00)
- B-3⊕ HAND OR POWER AUGER SOIL BORING, RRM (10/01/99)
- TP-6 ⊕ EXCAVATION TEST PIT FOR SOIL AND GRAB GROUNDWATER SAMPLE COLLECTION, RRM (9/30/99)
- ⊘ REMOVED/DESTROYED WELL
- <100/<750 DRO/RRO CONCENTRATIONS IN GROUNDWATER IN PARTS PER BILLION (ppb) SAMPLED ON 8/12/04
- DRO DIESEL RANGE ORGANICS
- RRO RESIDUAL RANGE ORGANICS
- < NOT DETECTED AT OR ABOVE REPORTING LIMIT SHOWN
- * WELL SAMPLED AND REMOVED 8/10/04

TANK DESCRIPTIONS

TANK#	SIZE (gals)	CONTENTS (fuel)
1	12,690	AV-GAS 100
2	12,690	AV-GAS 100
3	12,690	AV-GAS 100
4	91,715	JET FUEL
5	70,374	UNLEADED GAS
9	19,316	SUPER UNLEADED
10	138,016	DIESEL #2



SAIC
An Employee-Owned Company

**DRO/RRO CONCENTRATIONS IN GROUNDWATER
AUGUST 12, 2004**

**DELTA WESTERN / FORMER CHEVRON
BULK TERMINAL #1001467**

1417 Peninsula Street
Wrangell, Alaska

FIGURE:
6

PROJECT:
11467

Ref. A471/extend.dwg
Basemap from aerial photograph from Aeromap U.S. 7/26/98, Scale 1"=100'



ZIMOVIA STRAIT

EXPLANATION

- PROPERTY BOUNDARY
- - - APPROXIMATE SHORELINE
- ⊕ MONITORING WELL LOCATION
- ◇ TEST PIT LOCATION, RRM (10/23-28/01)
- ◆ TEST PIT LOCATION, RRM (10/01-03/03)
- ⊙ SEEP LOCATION
- SS2⊕ SOIL SAMPLE LOCATION, JAMES CLARE (7/00)
- B-3 ⊕ HAND OR POWER AUGER SOIL BORING, RRM (10/01/99)
- TP-6 ⊕ EXCAVATION TEST PIT FOR SOIL AND GRAB GROUNDWATER SAMPLE COLLECTION, RRM (9/30/99)
- ∅ REMOVED/DESTROYED WELL
- 2.09/5.27 TAH/TAqH CONCENTRATIONS IN GROUNDWATER IN PARTS PER BILLION (ppb) SAMPLED ON 8/12/04
- TAH TOTAL AROMATIC HYDROCARBONS
- TAqH TOTAL AQUEOUS HYDROCARBONS
- ND NOT DETECTED AT OR ABOVE REPORTING LIMIT
- NA NOT ANALYZED
- * WELL SAMPLED AND REMOVED 8/10/04

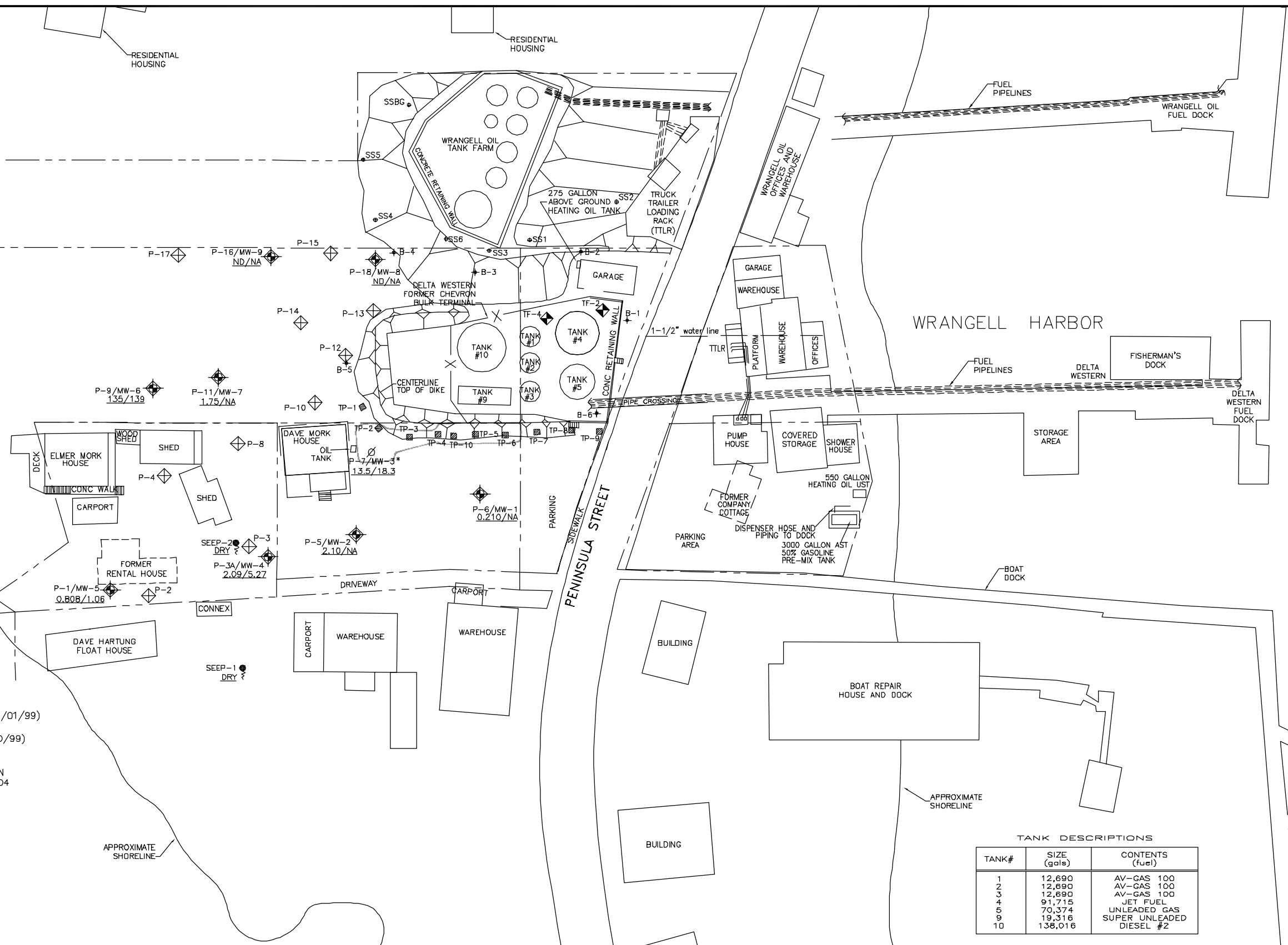

TANK DESCRIPTIONS

TANK#	SIZE (gals)	CONTENTS (fuel)
1	12,690	AV-GAS 100
2	12,690	AV-GAS 100
3	12,690	AV-GAS 100
4	91,715	JET FUEL
5	70,374	UNLEADED GAS
9	19,316	SUPER UNLEADED
10	138,016	DIESEL #2



SAIC
An Employee-Owned Company

**TAH/TAqH CONCENTRATIONS IN GROUNDWATER
AUGUST 12, 2004**

**DELTA WESTERN / FORMER CHEVRON
BULK TERMINAL #1001467**

1417 Peninsula Street
Wrangell, Alaska

FIGURE:
7

PROJECT:
11467

Ref. A471/extend.dwg
Basemap from aerial photograph from Aeromap U.S. 7/26/98, Scale 1"=100'



ZIMOVIA STRAIT

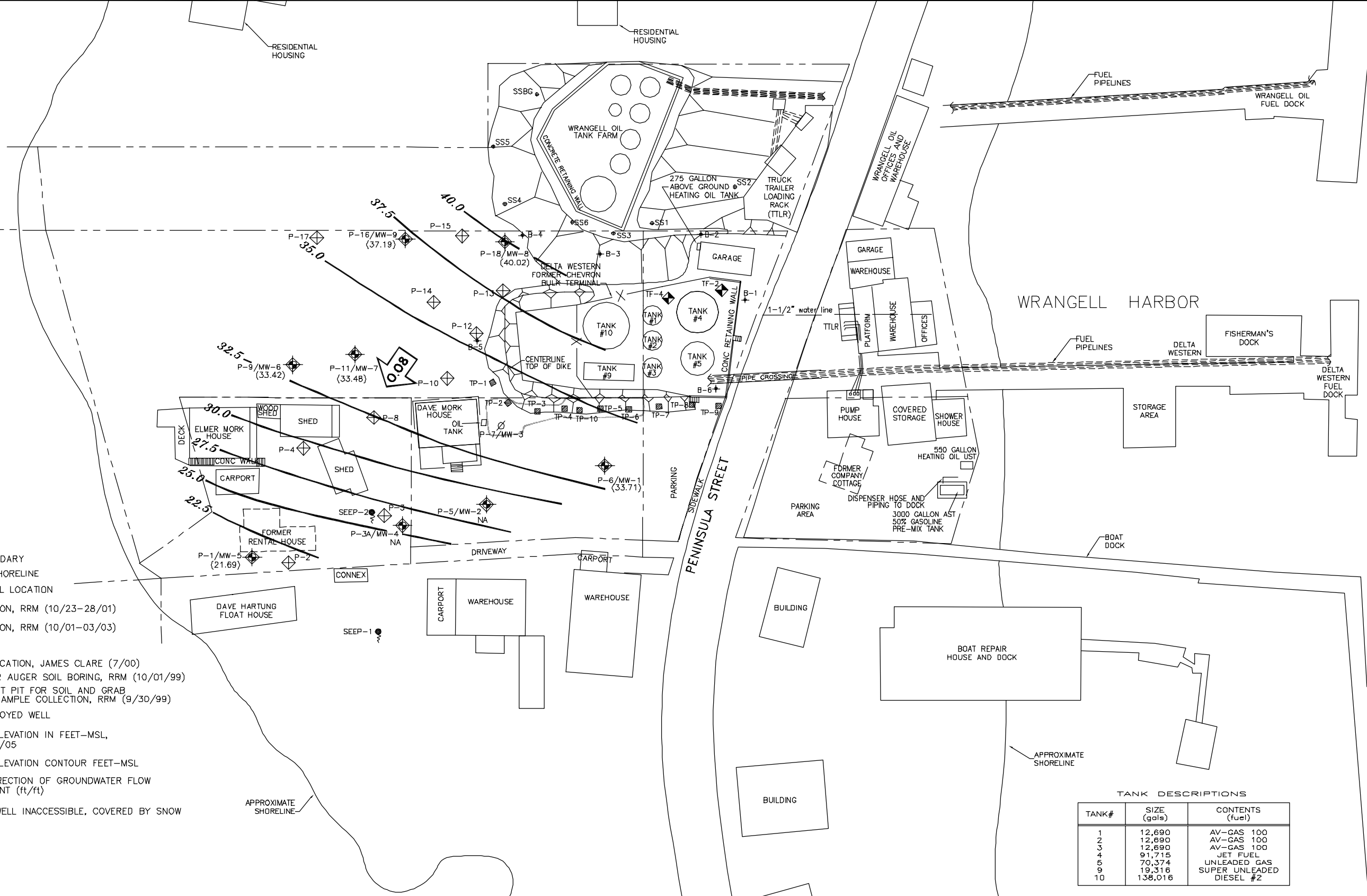

EXPLANATION

- PROPERTY BOUNDARY
- - - APPROXIMATE SHORELINE
- ⊕ MONITORING WELL LOCATION
- ◇ TEST PIT LOCATION, RRM (10/23-28/01)
- ◆ TEST PIT LOCATION, RRM (10/01-03/03)
- ⊙ SEEP LOCATION
- SS2⊕ SOIL SAMPLE LOCATION, JAMES CLARE (7/00)
- B-3 ⊕ HAND OR POWER AUGER SOIL BORING, RRM (10/01/99)
- TP-6 ⊕ EXCAVATION TEST PIT FOR SOIL AND GRAB GROUNDWATER SAMPLE COLLECTION, RRM (9/30/99)
- ⊘ REMOVED/DESTROYED WELL
- (21.69) GROUNDWATER ELEVATION IN FEET-MSL, MEASURED 2/21/05
- 22.5 — GROUNDWATER ELEVATION CONTOUR FEET-MSL
- ↘ APPROXIMATE DIRECTION OF GROUNDWATER FLOW SHOWING GRADIENT (ft/ft)
- NS NOT SAMPLED, WELL INACCESSIBLE, COVERED BY SNOW

TANK DESCRIPTIONS

TANK#	SIZE (gals)	CONTENTS (fuel)
1	12,690	AV-GAS 100
2	12,690	AV-GAS 100
3	12,690	AV-GAS 100
4	91,715	JET FUEL
5	70,374	UNLEADED GAS
9	19,316	SUPER UNLEADED
10	138,016	DIESEL #2



GROUNDWATER ELEVATION CONTOUR MAP, FEBRUARY 21, 2005

DELTA WESTERN / FORMER CHEVRON BULK TERMINAL #1001467
 1417 Peninsula Street
 Wrangell, Alaska

FIGURE:
8
 PROJECT:
 11467

Ref. A471/extend.dwg
 Basemap from aerial photograph from Aeromap U.S. 7/26/98, Scale 1"=100'

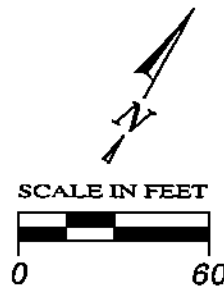

ZIMOVIA STRAIT

PENINSULA STREET

WRANGELL HARBOR

EXPLANATION

- PROPERTY BOUNDARY
- - - APPROXIMATE SHORELINE
- ⊕ MONITORING WELL LOCATION
- ⊕ TEST PIT LOCATION, RRM (10/23-28/01)
- ⊕ TEST PIT LOCATION, RRM (10/01-03/03)
- ⊕ SEEP LOCATION
- SS2● SOIL SAMPLE LOCATION, JAMES CLARE (7/00)
- B-3+ HAND OR POWER AUGER SOIL BORING, RRM (10/01/89)
- TP-6 ■ EXCAVATION TEST PIT FOR SOIL AND GRAB GROUNDWATER SAMPLE COLLECTION, RRM (9/30/99)
- ∅ REMOVED/DESTROYED WELL
- 439/<0.200 GRO/BENZENE CONCENTRATIONS IN GROUNDWATER IN PARTS PER BILLION (ppb) SAMPLED ON 2/21/05
- GRO GASOLINE RANGE ORGANICS
- < NOT DETECTED AT OR ABOVE REPORTING LIMIT SHOWN
- NS NOT SAMPLED, WELL INACCESSIBLE, COVERED BY SNOW

TANK DESCRIPTIONS

TANK#	SIZE (gals)	CONTENTS (fuel)
1	12,890	AV-GAS 100
2	12,890	AV-GAS 100
3	12,890	AV-GAS 100
4	91,715	JET FUEL
5	70,374	UNLEADED GAS
9	19,318	SUPER UNLEADED
10	138,018	DIESEL #2

Ref. A471/wrangel.org
Basemap from aerial photograph from Aerialmap U.S. 7/26/98, Scale 1"=100'



SAIC
An Employee-Owned Company

**GRO/BENZENE CONCENTRATIONS IN GROUNDWATER
FEBRUARY 21, 2005**

**DELTA WESTERN / FORMER CHEVRON
BULK TERMINAL #1001467**

1417 Peninsula Street
Wrangell, Alaska

FIGURE:
9

PROJECT:
11467

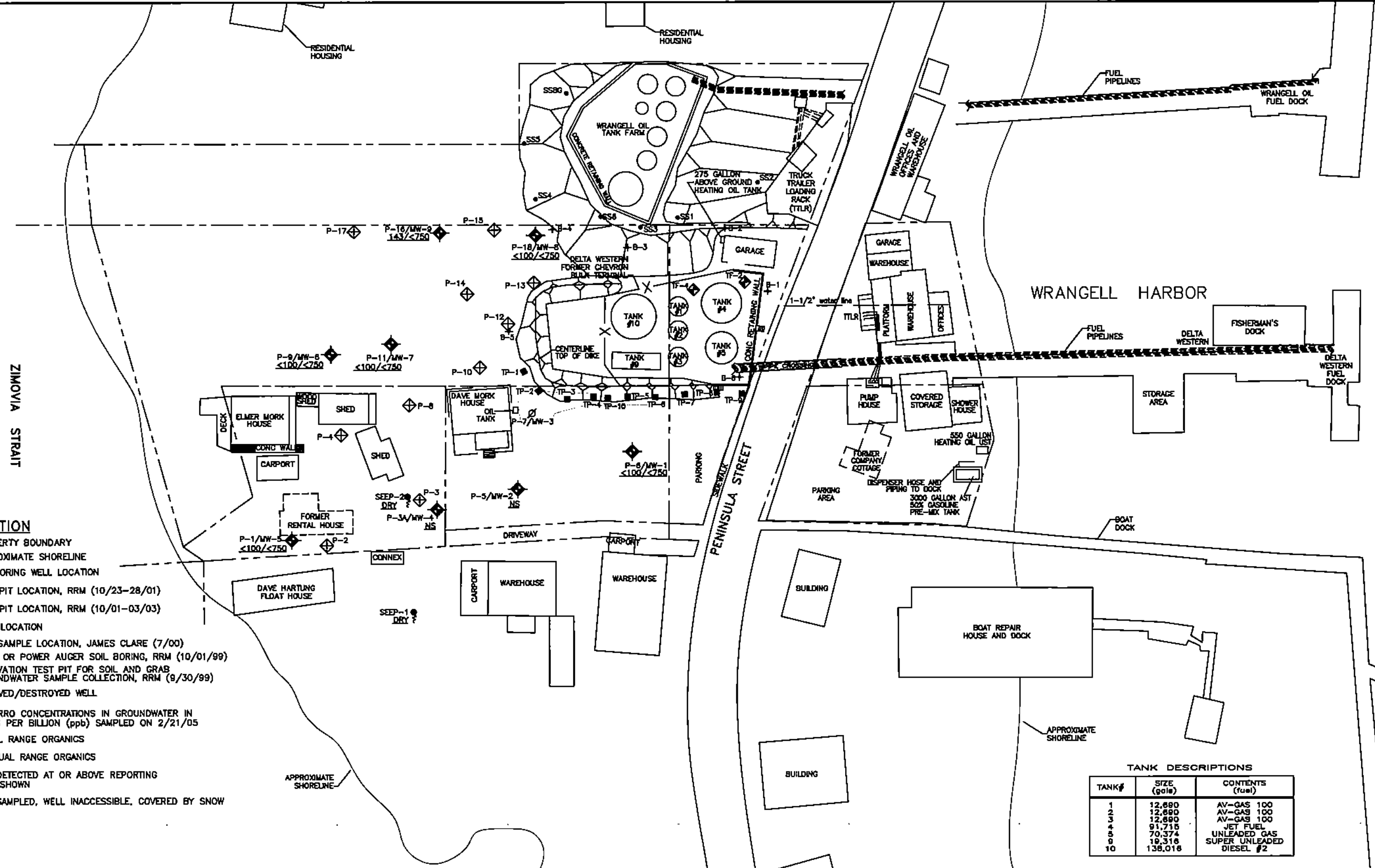
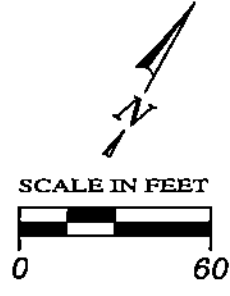

EXPLANATION

- PROPERTY BOUNDARY
- - - APPROXIMATE SHORELINE
- ⊕ MONITORING WELL LOCATION
- ⊕ TEST PIT LOCATION, RRM (10/23-28/01)
- ⊕ TEST PIT LOCATION, RRM (10/01-03/03)
- SEEP LOCATION
- SS2● SOIL SAMPLE LOCATION, JAMES CLARE (7/00)
- B-3+ HAND OR POWER AUGER SOIL BORING, RRM (10/01/99)
- TP-6 ■ EXCAVATION TEST PIT FOR SOIL AND GRAB GROUNDWATER SAMPLE COLLECTION, RRM (9/30/99)
- ⊘ REMOVED/DESTROYED WELL
- <100/<750 DRO/RRO CONCENTRATIONS IN GROUNDWATER IN PARTS PER BILLION (ppb) SAMPLED ON 2/21/05
- DRO DIESEL RANGE ORGANICS
- RRO RESIDUAL RANGE ORGANICS
- < NOT DETECTED AT OR ABOVE REPORTING LIMIT SHOWN
- NS NOT SAMPLED, WELL INACCESSIBLE, COVERED BY SNOW

TANK DESCRIPTIONS

TANK#	SIZE (gals)	CONTENTS (fuel)
1	12,680	AV-GAS 100
2	12,680	AV-GAS 100
3	12,680	AV-GAS 100
4	91,715	JET FUEL
5	70,374	UNLEADED GAS
9	19,316	SUPER UNLEADED
10	136,016	DIESEL #2



**DRO/RRO CONCENTRATIONS IN GROUNDWATER
FEBRUARY 21, 2005**

**DELTA WESTERN / FORMER CHEVRON
BULK TERMINAL #1001467**

1417 Peninsula Street
Wrangell, Alaska

FIGURE:
10
PROJECT:
11467

Ref. A471/airphoto.dwg
Scanmap from aerial photograph from Aeronav U.S. 7/24/96. Scale 1"=100'

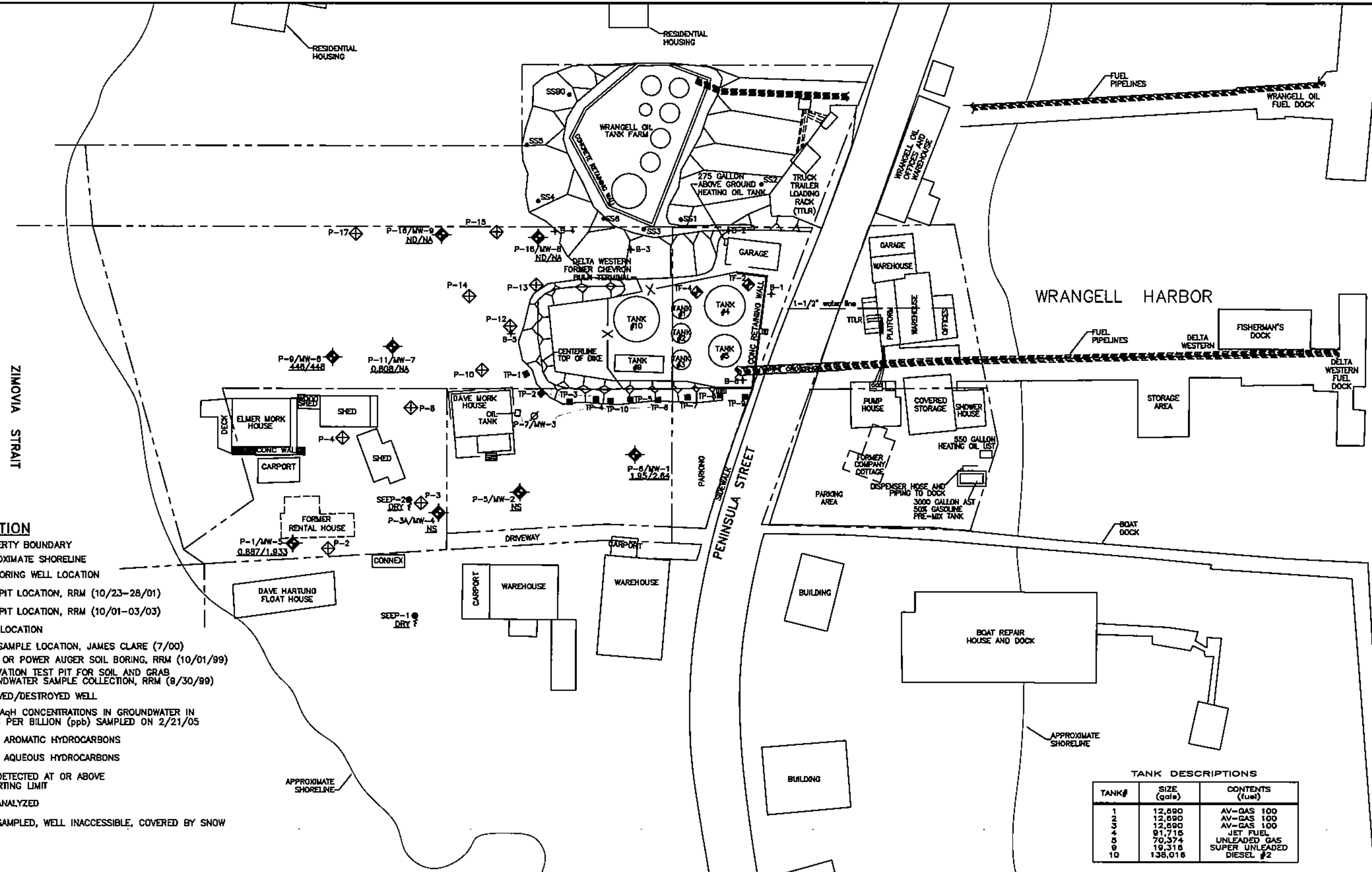
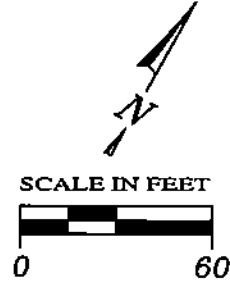

EXPLANATION

- PROPERTY BOUNDARY
- - - APPROXIMATE SHORELINE
- ⊕ MONITORING WELL LOCATION
- ⊕ TEST PIT LOCATION, RRM (10/23-28/01)
- ⊕ TEST PIT LOCATION, RRM (10/01-03/03)
- SEEP LOCATION
- SS2● SOIL SAMPLE LOCATION, JAMES CLARE (7/00)
- B-3+ HAND OR POWER AUGER SOIL BORING, RRM (10/01/99)
- TP-6 ■ EXCAVATION TEST PIT FOR SOIL AND GRAB GROUNDWATER SAMPLE COLLECTION, RRM (9/30/99)
- ∅ REMOVED/DESTROYED WELL
- 1.85/2.64 TAH/TAQH CONCENTRATIONS IN GROUNDWATER IN PARTS PER BILLION (ppb) SAMPLED ON 2/21/05
- TAH TOTAL AROMATIC HYDROCARBONS
- TAQH TOTAL AQUEOUS HYDROCARBONS
- ND NOT DETECTED AT OR ABOVE REPORTING LIMIT
- NA NOT ANALYZED
- NS NOT SAMPLED, WELL INACCESSIBLE, COVERED BY SNOW

TANK DESCRIPTIONS

TANK#	SIZE (gals)	CONTENTS (fuel)
1	12,690	AV-GAS 100
2	12,690	AV-GAS 100
3	12,690	AV-GAS 100
4	91,716	JET FUEL
5	70,374	UNLEADED GAS
9	19,318	SUPER UNLEADED
10	138,018	DIESEL #2



**TAH/TAQH CONCENTRATIONS IN GROUNDWATER
FEBRUARY 21, 2005**

**DELTA WESTERN / FORMER CHEVRON
BULK TERMINAL #1001467**

1417 Peninsula Street
Wrangell, Alaska

**FIGURE:
11
PROJECT:
11467**

File: A07/airphoto.dwg
Scanmap from aerial photograph from Aeronap U.S. 7/24/98, Scale 1"=100'



ZIMOVIA STRAIT

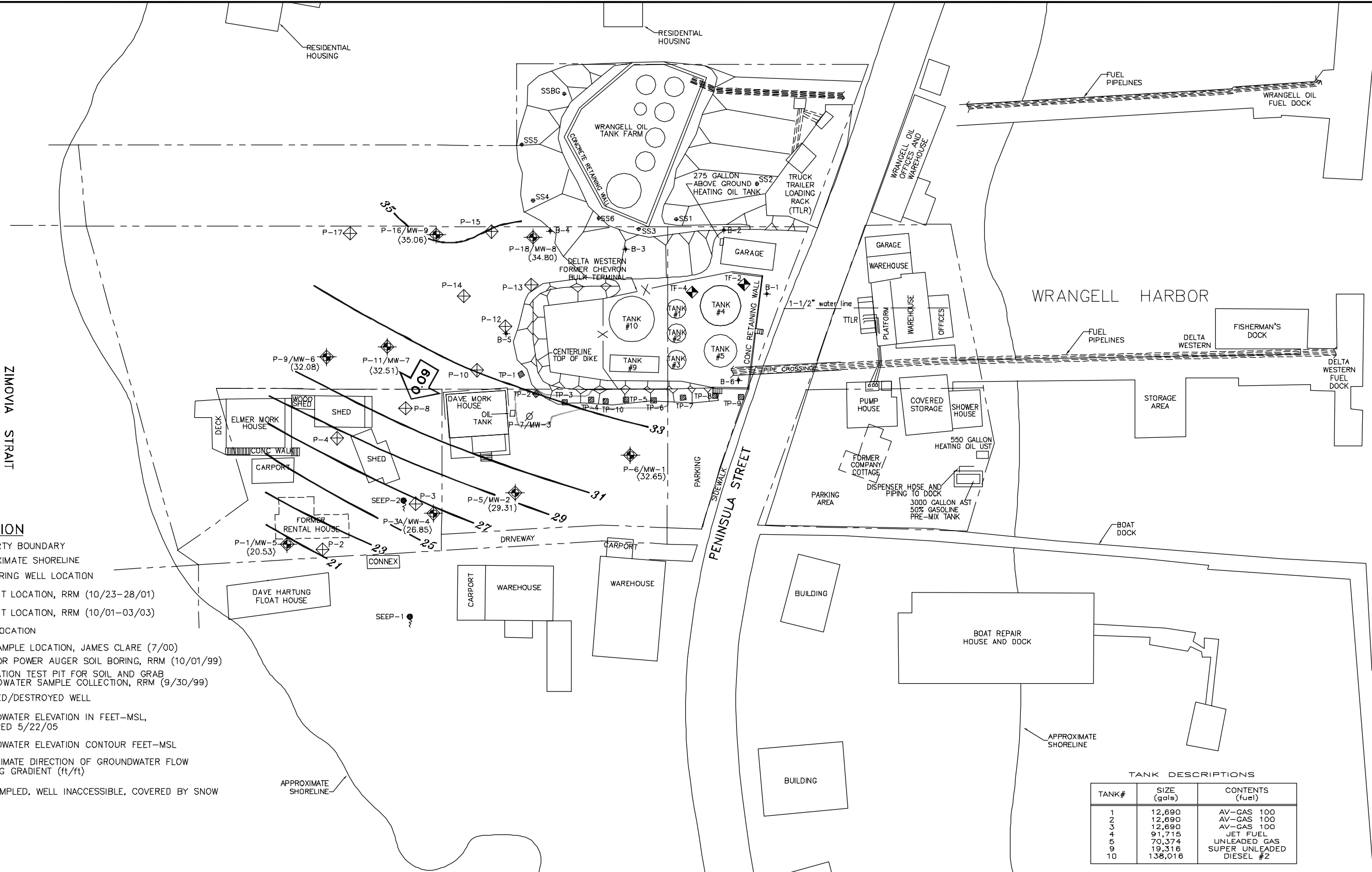

EXPLANATION

- PROPERTY BOUNDARY
- - - APPROXIMATE SHORELINE
- ⊕ MONITORING WELL LOCATION
- ◇ TEST PIT LOCATION, RRM (10/23-28/01)
- ◆ TEST PIT LOCATION, RRM (10/01-03/03)
- SEEP LOCATION
- SS2⊕ SOIL SAMPLE LOCATION, JAMES CLARE (7/00)
- B-3 ⊕ HAND OR POWER AUGER SOIL BORING, RRM (10/01/99)
- TP-6 ⊕ EXCAVATION TEST PIT FOR SOIL AND GRAB GROUNDWATER SAMPLE COLLECTION, RRM (9/30/99)
- ∅ REMOVED/DESTROYED WELL
- (32.65) GROUNDWATER ELEVATION IN FEET-MSL, MEASURED 5/22/05
- 23 — GROUNDWATER ELEVATION CONTOUR FEET-MSL
- 0.09 — APPROXIMATE DIRECTION OF GROUNDWATER FLOW SHOWING GRADIENT (ft/ft)
- NS NOT SAMPLED, WELL INACCESSIBLE, COVERED BY SNOW

TANK DESCRIPTIONS

TANK#	SIZE (gals)	CONTENTS (fuel)
1	12,690	AV-GAS 100
2	12,690	AV-GAS 100
3	12,690	AV-GAS 100
4	91,715	JET FUEL
5	70,374	UNLEADED GAS
9	19,316	SUPER UNLEADED
10	138,016	DIESEL #2

Ref. A471/extent.dwg
Base map from aerial photograph from Aeromap U.S. 7/26/98, Scale 1"=100'



GROUNDWATER ELEVATION CONTOUR MAP, MAY, 22, 2005

DELTA WESTERN / FORMER CHEVRON BULK TERMINAL #1001467
1417 Peninsula Street
Wrangell, Alaska

FIGURE:
12
PROJECT:
11467

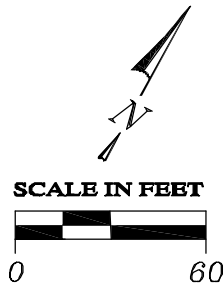

ZIMOVIA STRAIT

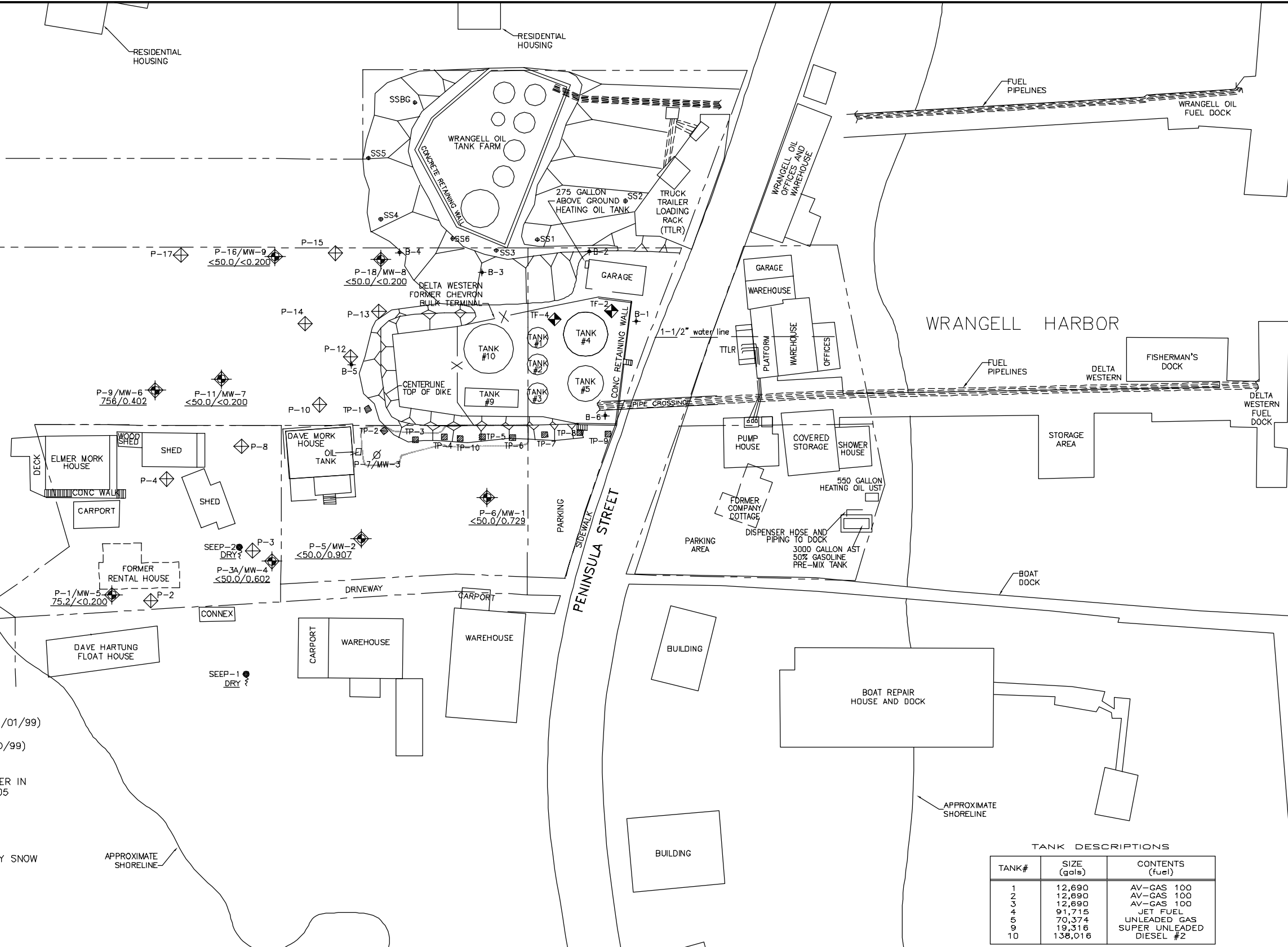

EXPLANATION

- PROPERTY BOUNDARY
- - - APPROXIMATE SHORELINE
- ⊕ MONITORING WELL LOCATION
- ◇ TEST PIT LOCATION, RRM (10/23-28/01)
- ◆ TEST PIT LOCATION, RRM (10/01-03/03)
- SEEP LOCATION
- SS2⊕ SOIL SAMPLE LOCATION, JAMES CLARE (7/00)
- B-3 ⊕ HAND OR POWER AUGER SOIL BORING, RRM (10/01/99)
- TP-6 ⊕ EXCAVATION TEST PIT FOR SOIL AND GRAB GROUNDWATER SAMPLE COLLECTION, RRM (9/30/99)
- ⊘ REMOVED/DESTROYED WELL
- <50.0/0.729 GRO/BENZENE CONCENTRATIONS IN GROUNDWATER IN PARTS PER BILLION (ppb) SAMPLED ON 5/22/05
- GRO GASOLINE RANGE ORGANICS
- < NOT DETECTED AT OR ABOVE REPORTING LIMIT SHOWN
- NS NOT SAMPLED, WELL INACCESSIBLE, COVERED BY SNOW

TANK DESCRIPTIONS

TANK#	SIZE (gals)	CONTENTS (fuel)
1	12,690	AV-GAS 100
2	12,690	AV-GAS 100
3	12,690	AV-GAS 100
4	91,715	JET FUEL
5	70,374	UNLEADED GAS
9	19,316	SUPER UNLEADED
10	138,016	DIESEL #2

Ref. A471/extent.dwg
Base map from aerial photograph from Aeromap U.S. 7/26/98, Scale 1"=100'



**GRO/BENZENE CONCENTRATIONS IN GROUNDWATER
MAY 22, 2005**

**DELTA WESTERN / FORMER CHEVRON
BULK TERMINAL #1001467**
1417 Peninsula Street
Wrangell, Alaska

FIGURE:
13
PROJECT:
11467



ZIMOVIA STRAIT

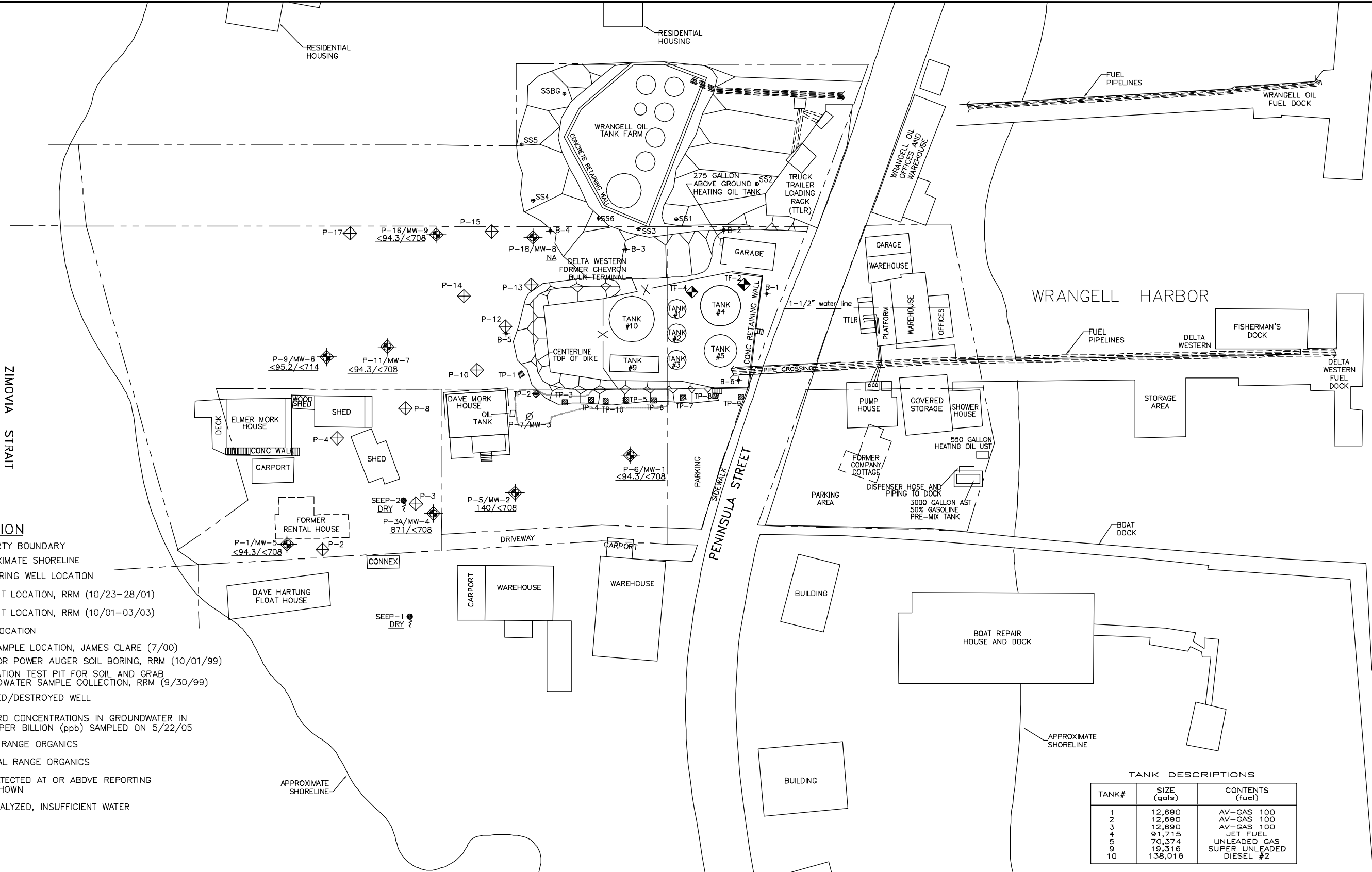

EXPLANATION

- PROPERTY BOUNDARY
- - - APPROXIMATE SHORELINE
- ⊕ MONITORING WELL LOCATION
- ◇ TEST PIT LOCATION, RRM (10/23-28/01)
- ◆ TEST PIT LOCATION, RRM (10/01-03/03)
- SEEP LOCATION
- SS2⊕ SOIL SAMPLE LOCATION, JAMES CLARE (7/00)
- B-3 ⊕ HAND OR POWER AUGER SOIL BORING, RRM (10/01/99)
- TP-6 ⊕ EXCAVATION TEST PIT FOR SOIL AND GRAB GROUNDWATER SAMPLE COLLECTION, RRM (9/30/99)
- ∅ REMOVED/DESTROYED WELL
- <94.3/<708 DRO/RRO CONCENTRATIONS IN GROUNDWATER IN PARTS PER BILLION (ppb) SAMPLED ON 5/22/05
- DRO DIESEL RANGE ORGANICS
- RRO RESIDUAL RANGE ORGANICS
- < NOT DETECTED AT OR ABOVE REPORTING LIMIT SHOWN
- NA NOT ANALYZED, INSUFFICIENT WATER

TANK DESCRIPTIONS

TANK#	SIZE (gals)	CONTENTS (fuel)
1	12,690	AV-GAS 100
2	12,690	AV-GAS 100
3	12,690	AV-GAS 100
4	91,715	JET FUEL
5	70,374	UNLEADED GAS
9	19,316	SUPER UNLEADED
10	138,016	DIESEL #2

Ref. A471/extend.dwg
Base map from aerial photograph from Aeromap U.S. 7/26/98, Scale 1"=100'



**DRO/RRO CONCENTRATIONS IN GROUNDWATER
MAY 22, 2005**

**DELTA WESTERN / FORMER CHEVRON
BULK TERMINAL #1001467**

1417 Peninsula Street
Wrangell, Alaska

FIGURE:
14

PROJECT:
11467

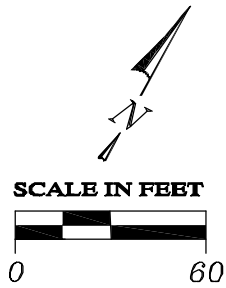

ZIMOVIA STRAIT

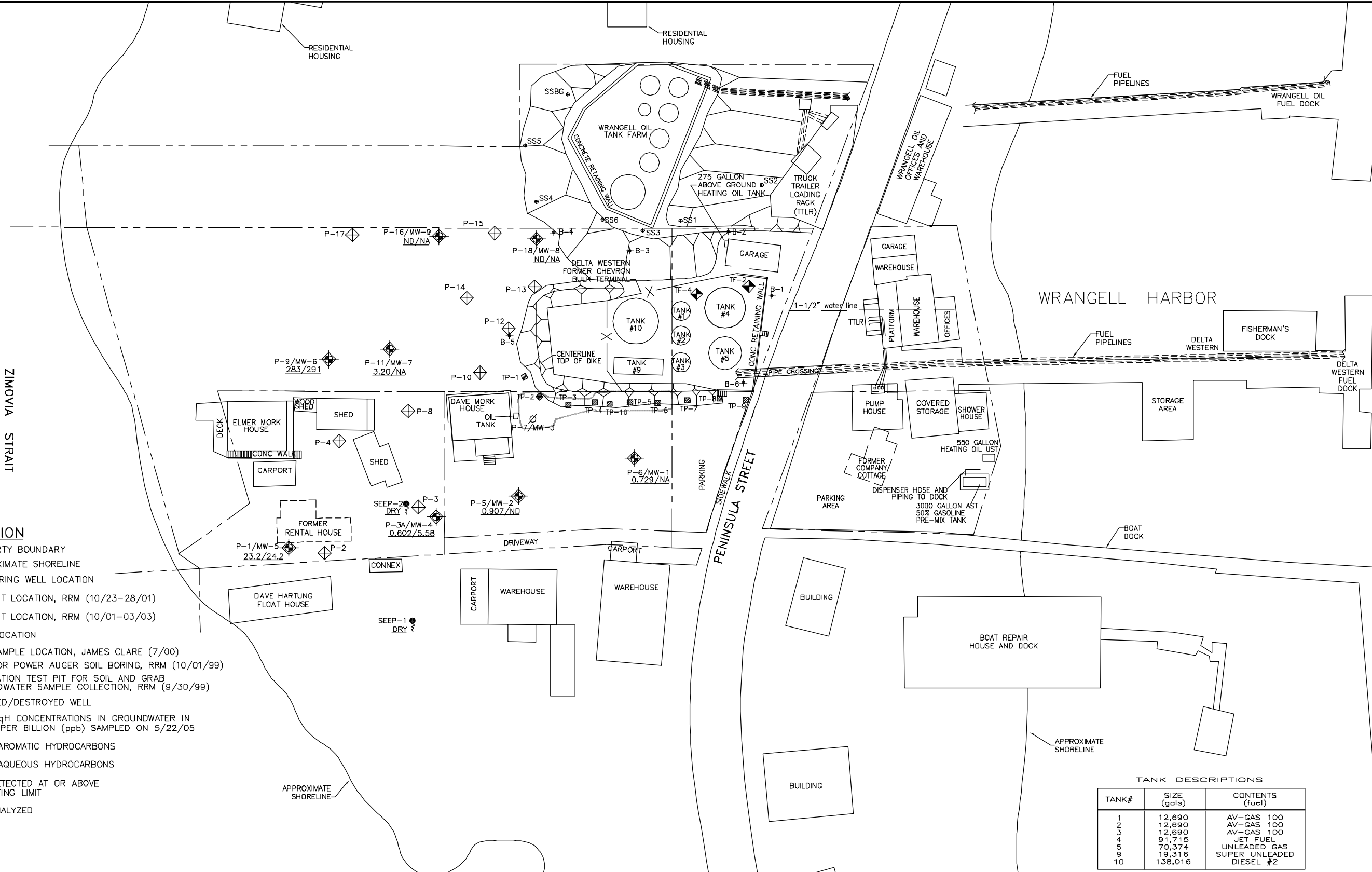

EXPLANATION

- PROPERTY BOUNDARY
- - - APPROXIMATE SHORELINE
- ⊕ MONITORING WELL LOCATION
- ◇ TEST PIT LOCATION, RRM (10/23-28/01)
- ◆ TEST PIT LOCATION, RRM (10/01-03/03)
- SEEP LOCATION
- SS2⊕ SOIL SAMPLE LOCATION, JAMES CLARE (7/00)
- B-3 ⊕ HAND OR POWER AUGER SOIL BORING, RRM (10/01/99)
- TP-6 ⊕ EXCAVATION TEST PIT FOR SOIL AND GRAB GROUNDWATER SAMPLE COLLECTION, RRM (9/30/99)
- ∅ REMOVED/DESTROYED WELL
- 0.729/NA TAH/TAqH CONCENTRATIONS IN GROUNDWATER IN PARTS PER BILLION (ppb) SAMPLED ON 5/22/05
- TAH TOTAL AROMATIC HYDROCARBONS
- TAqH TOTAL AQUEOUS HYDROCARBONS
- ND NOT DETECTED AT OR ABOVE REPORTING LIMIT
- NA NOT ANALYZED

TANK DESCRIPTIONS

TANK#	SIZE (gals)	CONTENTS (fuel)
1	12,690	AV-GAS 100
2	12,690	AV-GAS 100
3	12,690	AV-GAS 100
4	91,715	JET FUEL
5	70,374	UNLEADED GAS
9	19,316	SUPER UNLEADED
10	138,016	DIESEL #2

Ref. A471/extent.dwg
Base map from aerial photograph from Aeromap U.S. 7/26/98, Scale 1"=100'



**TAH/TAqH CONCENTRATIONS IN GROUNDWATER
MAY 22, 2005**

**DELTA WESTERN / FORMER CHEVRON
BULK TERMINAL #1001467**
1417 Peninsula Street
Wrangell, Alaska

FIGURE:
15
PROJECT:
11467