

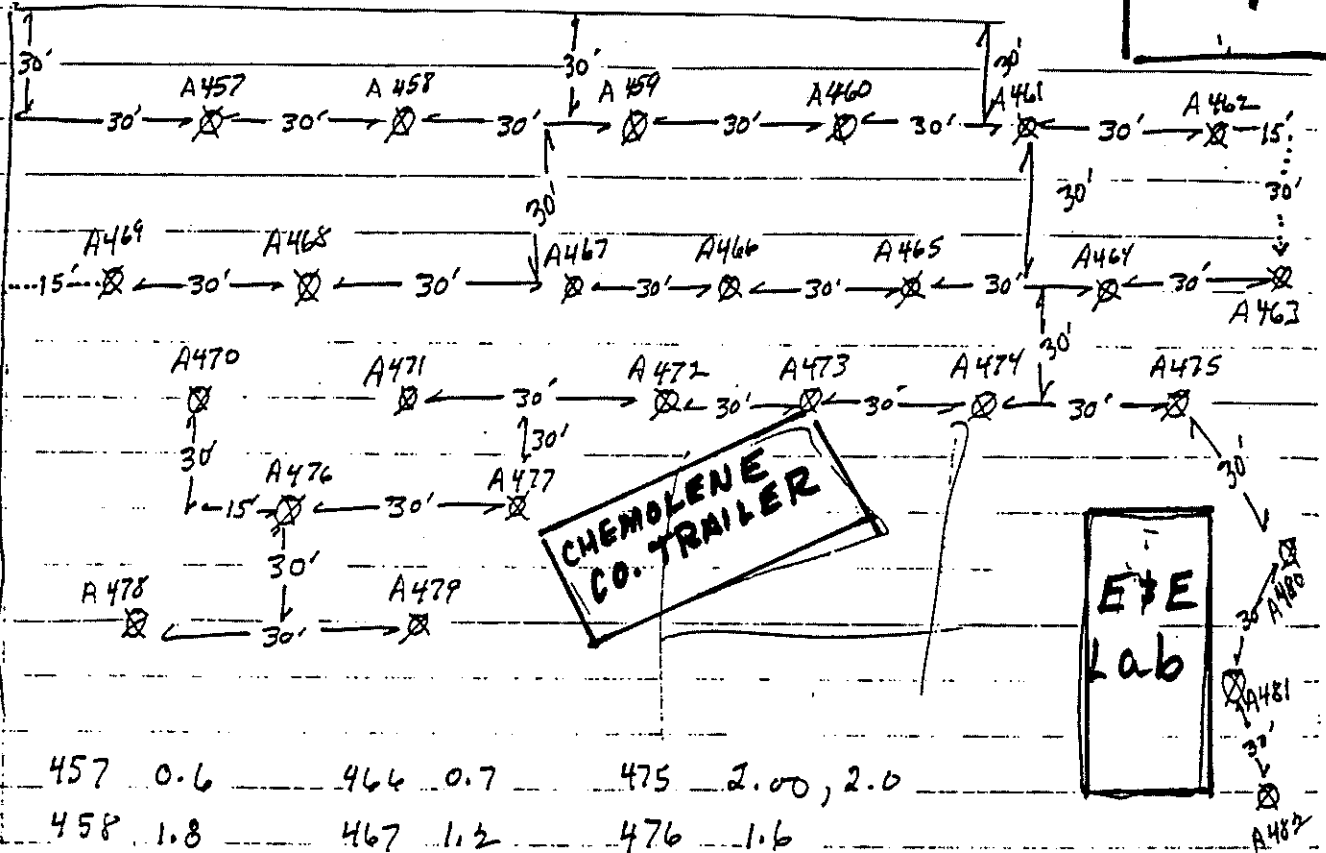

NOT TO SCALE

C. P.  
Machine  
Shop

Compressor Plant Office



457	0.6	466	0.7	475	2.00, 2.0
458	1.8	467	1.2	476	1.6
459	1.7	468	0.8	477	3.6
460	3.0	469	0.5	478	1.6
461	2.2	470	0.2	479	0.3
462	0.87(0.9)	471	0.4	480	2.2
463	3.4	472	0.5	481	0.6
464	1.9	473	12.3	482	2.5
465	1.1, 0.9	474	4.8		

Compressor Plant  
Facility - Parking  
Lot  
0-6" Screens  
June 20, 1987

SAMPLES: A457 - A482



Project: \_\_\_\_\_ By: \_\_\_\_\_

Subject: \_\_\_\_\_ Date: \_\_\_\_\_

⊗ A451 (9.0)

⊗ A447 (<1)

⊗ A452 (1.0)

⊗ A453 (2.2)

⊗ A454 (1.0)

⊕ A446 (5.6)

⊕ A445 (1.9)

⊗ A455 (2.7)

⊗ A456 (3.1)

⊗ A444 (3.1)

⊕ A443 (4.2)

⊗ A442 (4.9)

⊗ A441 (8.9)



NOT TO SCALE

**COMPRESSOR PLANT  
FACILITY- NORTH  
ACCESS ROAD  
0-6" SCREENS  
JUNE 24, 1987**

SAMPLES : A441- A447; A451- A456



THERMINOL  
HEATER BLDG.

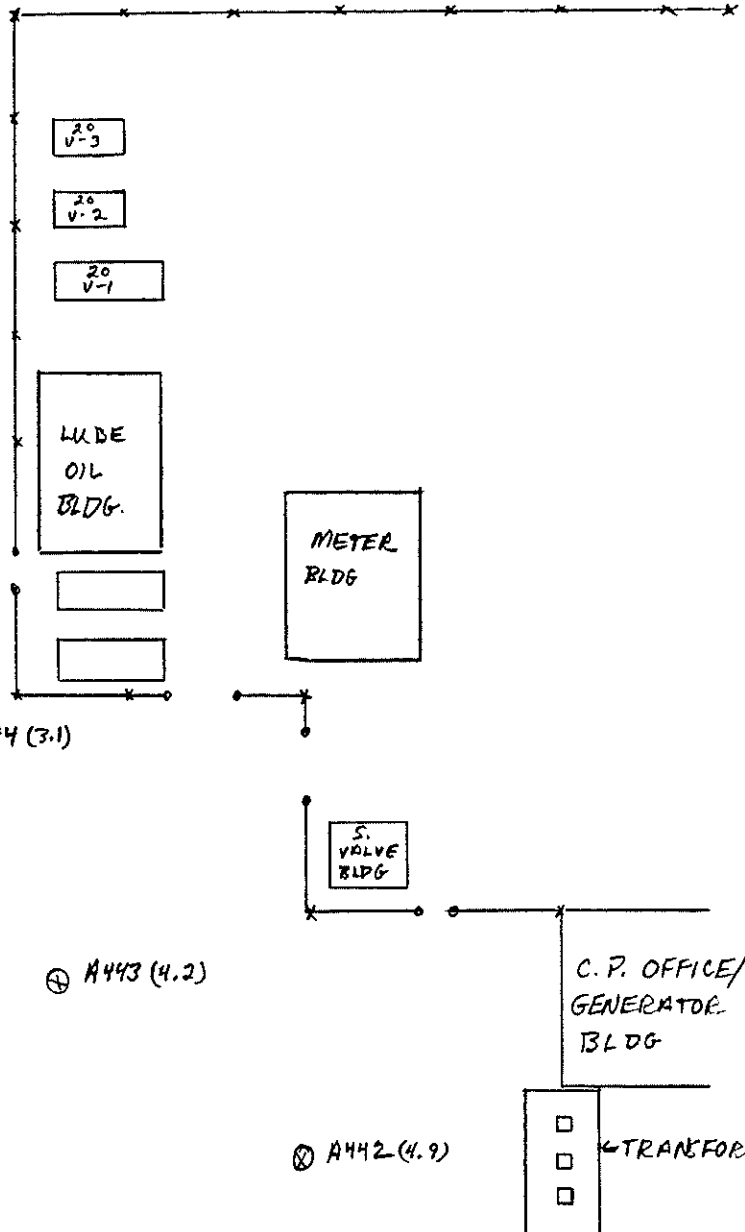



Project: \_\_\_\_\_ By: \_\_\_\_\_

Subject: \_\_\_\_\_ Date: \_\_\_\_\_

COMPRESSOR PLANT FACILITY -  
MACHINE SHOP BUILDING  
0-6" SCREEN  
JUNE 29, 1987

SAMPLE : A541

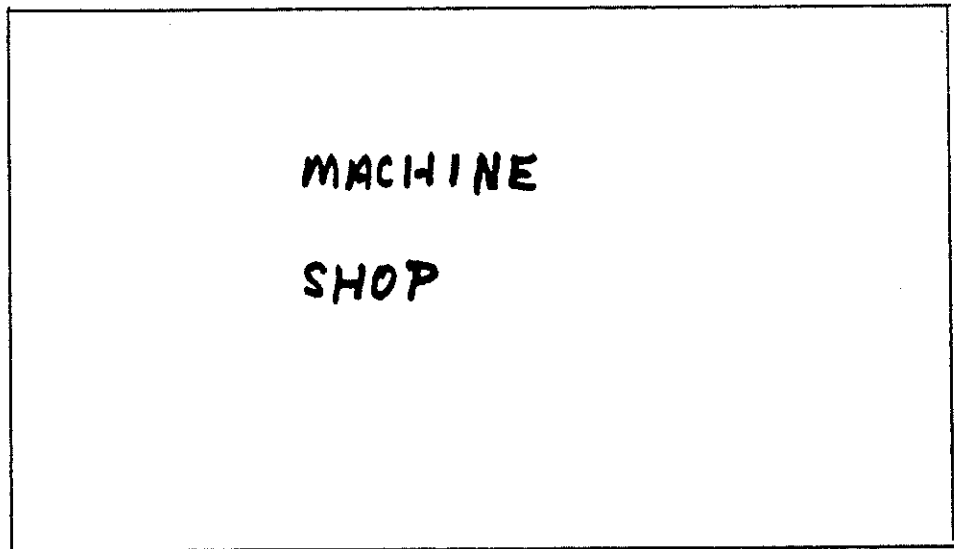

⊗ A541 (-1)

1" = 16'



Project: \_\_\_\_\_ By: \_\_\_\_\_

Subject: \_\_\_\_\_ Date: \_\_\_\_\_

COMPRESSOR PLANT FACILITY -  
 OFFICE / GENERATOR BUILDING  
 0-6" SCREENS  
 JUNE 29, 1987

⊗ A543 (4.6)

OFFICE / GENERATOR  
BUILDING

⊗ A544 (1.9)

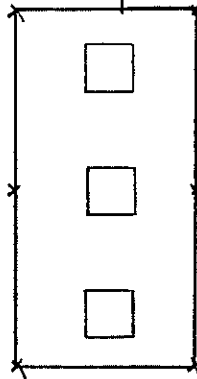

← TRANSFORMERS

A542(1) ⊗

SAMPLES : A542 - A544



1" = 12'

COMPRESSOR PLANT FACILITY-  
PM PLANT ACCESS ROAD  
0-3" SCREENS  
JULY 6, 1987

SAMPLES: A657-A661

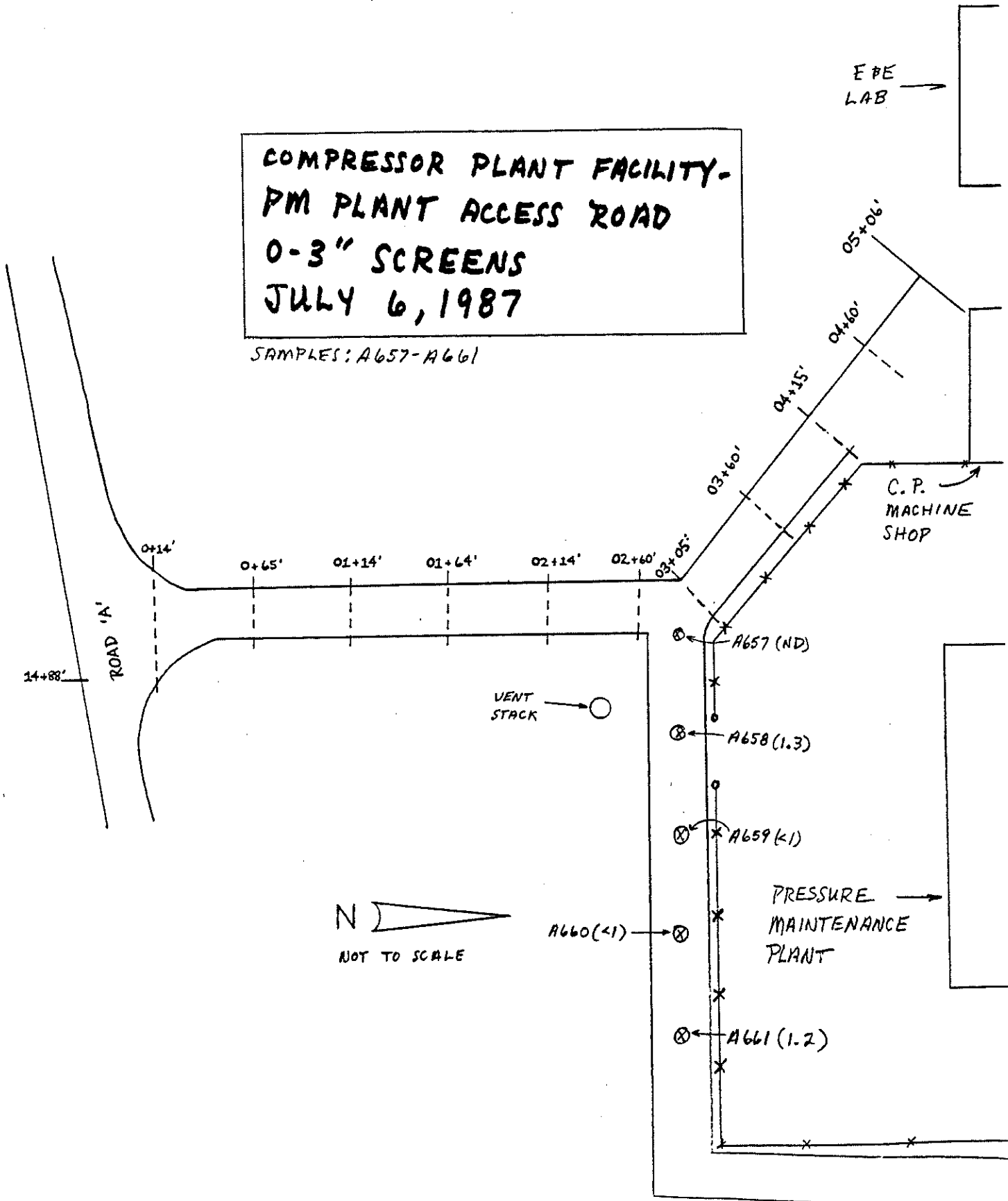



Project: \_\_\_\_\_ By: \_\_\_\_\_

Subject: \_\_\_\_\_ Date: \_\_\_\_\_

SAMPLES : A1186 - A1201

COMPRESSOR PLANT FACILITY - PLANT 10 (SOUTH)  
0-3" SCREENS  
JULY 21, 1987

COMPRESSOR PLANT FACILITY  
OFFICE / GENERATOR BUILDING

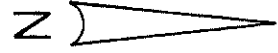
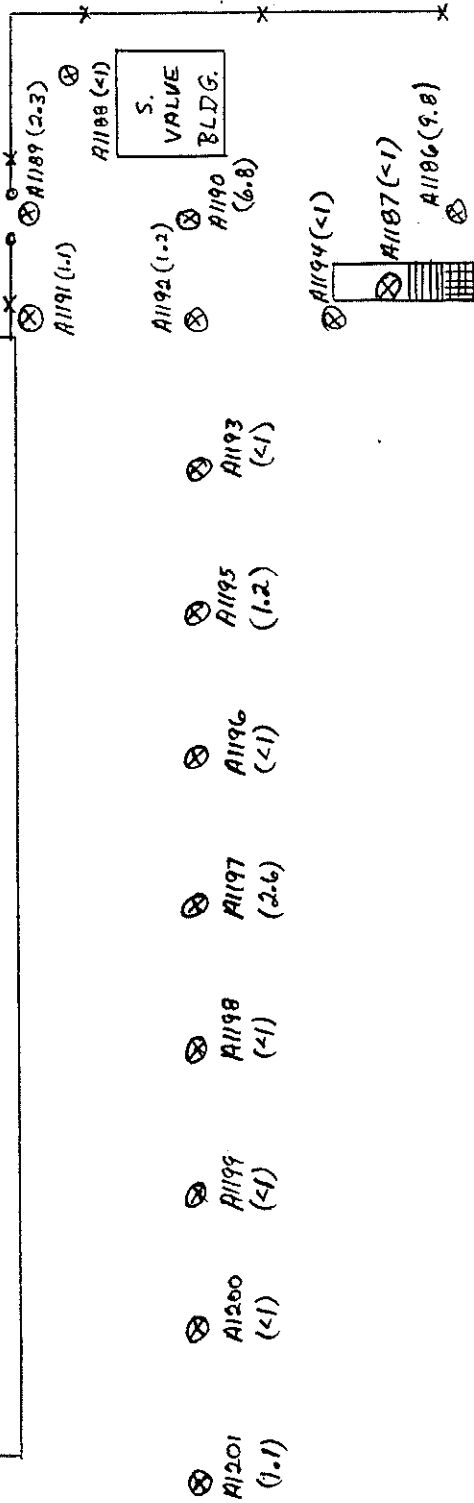

NOT TO SCALE



Project: \_\_\_\_\_ By: \_\_\_\_\_

Subject: \_\_\_\_\_ Date: \_\_\_\_\_

**COMPRESSOR PLANT  
FACILITY - PARKING  
LOT  
0-3" SCREENS  
SEPTEMBER 3, 1987**

SAMPLES: A3819 - A3837

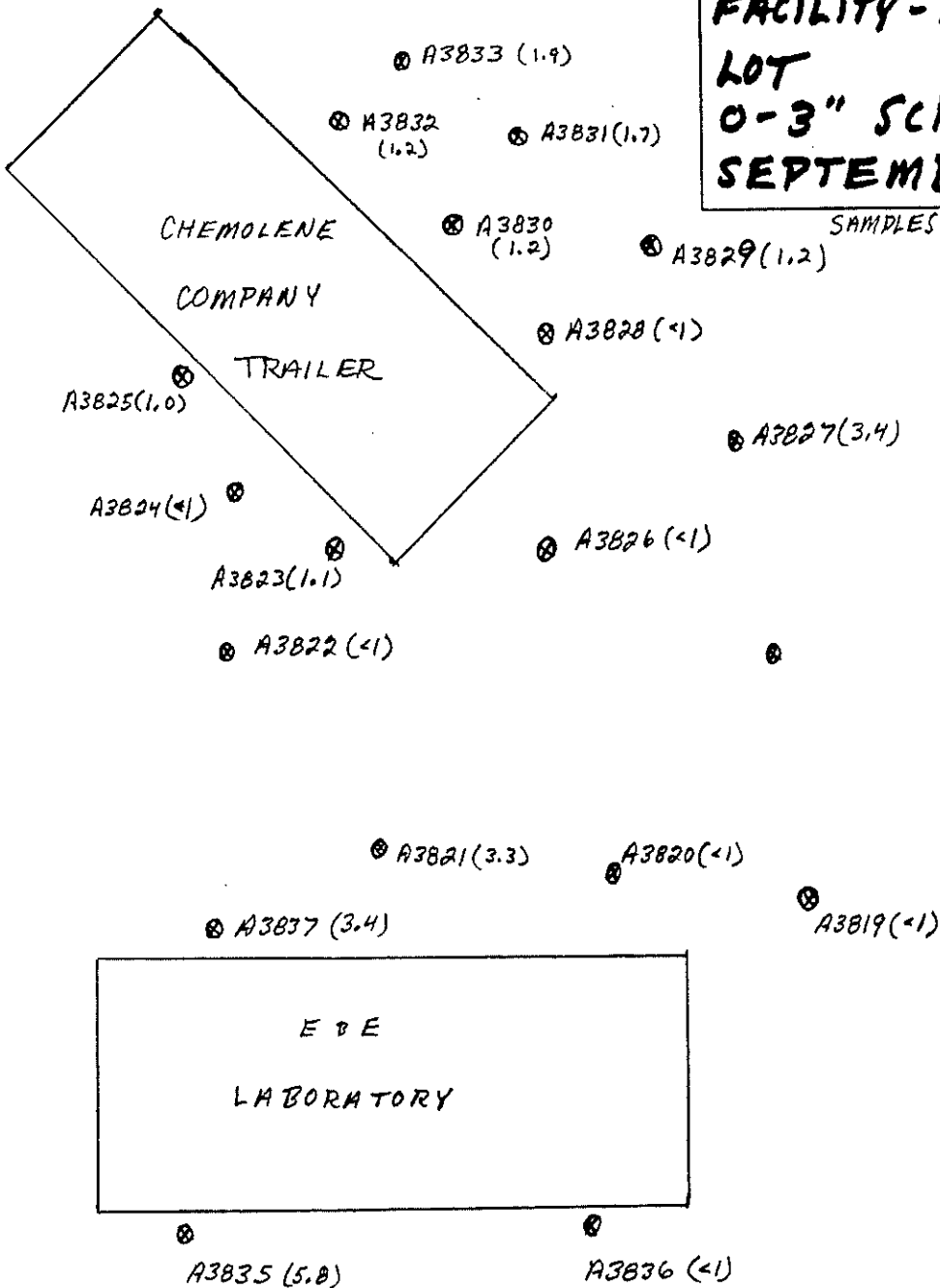



Project: \_\_\_\_\_ By: \_\_\_\_\_

Subject: \_\_\_\_\_ Date: \_\_\_\_\_

COMPRESSOR PLANT FACILITY-  
 MACHINE SHOP AREA  
 0-3" SCREENS  
 SEPTEMBER 21, 1987

SAMPLES: A4470 - A4475



NOT TO SCALE

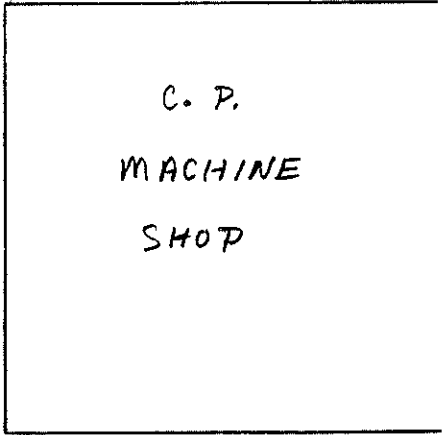

A4470(2.7) ⊗

A4471 (1.0) ⊗

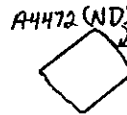

⊗ A4473 (1.2)

A4474 ⊗ (3.6)



A4475 (41)



5277(2.3) 5276(ND)

Compressor Plant  
Buildings A, B & E

E-7, 8, 9

C-4  
Region

PSK #5

PSK #6

PSK #7

Deethanizer

LTS #1

E-405

LTS #2

5254 (28.)

Pipeway

5253 (12.)

5274 (15.5)

5252 (2.4) 1248  
(1.5) 1254

5273 (67.3)

5272 (11.7)

Compressor Plant - Building 10

5251 (-1)

5213 (144.)

5255 (25.) 1248  
(18.) 1254

5256 (-1)

5257 (10.5)

5258 (ND)  
5259 (ND)

5260 (105.)

5261 - 6" (249.)

5264 (6.1)

5271 (ND)

Compressor Plant Office

5263 (ND)

5262 (2.0)

5265 (ND)

5270 (1.6)



NOT TO SCALE

P.M. Compressor Plant Building

5269 (ND)

5265 (ND)

5267 (ND)

5266 (ND)

Compressor Plant Facility -  
General  
0-3" Screens  
October 9, 1987

SAMPLES: A5213; A5251 - A5277



Project: \_\_\_\_\_ By: \_\_\_\_\_

Subject: \_\_\_\_\_ Date: \_\_\_\_\_

**COMPRESSOR PLANT FACILITY-  
PM VALVE BUILDING  
0-3" SCREENS  
OCTOBER 20, 1987**

SAMPLES : A5498 - A5503

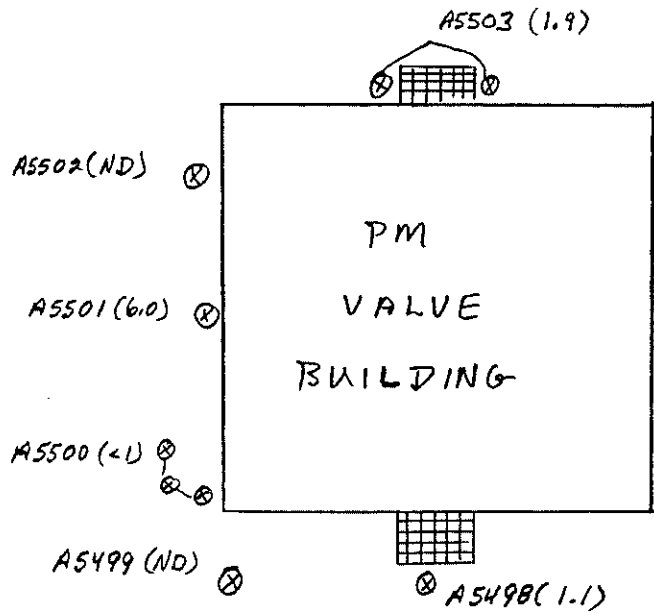

NOT TO SCALE

E + E  
LABORATORY