

TABLE 1 – Groundwater Analytical Results — MW-1

Sample ID#	Round-Date	SWL	GRO	Benzene	Toluene	E-Benzene	Xylenes
KA-42	1- 8/03/94	90.8	NA	64.2	62.7	2.46	11.6
KAFS-99-2	2- 6/16/99	91.5	79	12.6	21.5	1.45	7.1
KAFS-99-21W	2A 9/13/99	91.6	3.4	0.5	0.7	0.13	0.4
KAFS-99-24W	3- 11/29/99	91.6	64	12.8	12.1	0.06	2.5
KAFS-00-32W	4- 7/06/00	91.6	200	32.4	45.5	2.64	12.7
KAFS-00-38	5- 12/13/00	91.1	170	34.6	45.2	2.14	10.1
CLEANUP LEVEL			1.3	0.005	1.00	0.70	10.0

TABLE 2 – Groundwater Analytical Results — MW-2

Sample ID#	Round/Date	SWL	GRO	Benzene	Toluene	E-Benzene	Xylenes
KA-41	1- 9/03/94	90.7	NA	0.001U	0.001U	0.001U	0.001U
KAFS-99-1	2- 6/16/99	91.4	0.09U	0.0005U	0.002U	0.002U	0.002U
CLEANUP LEVEL			1.3	0.005	1.00	0.70	10.0

TABLE 3 – Groundwater Analytical Results — MW-4

Sample ID#	Round/Date	SWL	GRO	Benzene	Toluene	E-Benzene	Xylenes
KA-43	1- 8/03/94	90.6	NA	0.027	1.2	0.01	0.04
KAFS-99-4	2- 6/16/99	91.2	12	0.013	2.11	0.245	1.82
KAFS-99-24W	3- 11/29/99	91.0	7.9	0.18	2.14	0.04U	0.18
KAFS-00-30W	4- 7/06/00	92.4	3.1	0.014	0.75	0.01U	0.02
KAFS-00-36	5- 12/13/00	91.8	1.3	0.014	0.005	0.002U	0.005
CLEANUP LEVEL			1.3	0.005	1.00	0.70	10.0

TABLE 4 – Groundwater Analytical Results — MW-6

Sample ID#	Round/Date	SWL	GRO	Benzene	Toluene	E-Benzene	Xylenes
KAFS-99-25W	3- 11/29/99	91.6	75	11.2	14.7	1.08	4.5
KAFS-00-32W	4- 7/06/00	91.1	55	9.41	12.1	0.79	3.2
KAFS-00-37	5- 12/13/00	91.1	163	30.2	41.5	2.57	11.5
CLEANUP LEVEL			1.3	0.005	1.00	0.70	10.0

TABLE 5 – Groundwater Analytical Results — MW-7

Sample ID#	Round/Date	SWL	GRO	Benzene	Toluene	E-Benzene	Xylenes
KAFS-99-23W	3- 11/29/99	91.3	0.26	0.077	0.002U	0.005	0.011
KAFS-00-29W	4- 7/06/00	91.3	3.4	0.851	0.531	0.041	0.14
KAFS-00-38	5- 12/13/00	90.8	0.47	0.178	0.008	0.019	0.03
CLEANUP LEVEL			1.3	0.005	1.000	0.700	10.0

TABLE 6 – Groundwater Analytical Results — MW-8

Sample ID#	Round/Date	SWL	GRO	Benzene	Toluene	E-Benzene	Xylenes
KAFS-99-22W	3- 11/29/99	90.8	0.64	0.239	0.002U	0.002U	0.002U
KAFS-00-28W	4- 7/06/00	90.3	3.9	1.80	0.02U	0.02U	0.02U
KAFS-00-38	5- 12/13/00	90.3	1.6	0.83	0.023	0.02	0.02U
CLEANUP LEVEL			1.3	0.005	1.00	0.70	10.0

TABLE 2 - Groundwater Analytical Results - MW-7

Sample ID#	Date	SWL	GRO	Benz	Toluene	E-benz	Xylenes	EDB
KAFS-99-23W	11/29/99	91.3	0.26	0.077	0.002U	0.01	0.01	NA
KAFS-00-29W	7/06/00	91.3	3.4	0.851	0.53	0.04	0.14	NA
KAFS-00-38	12/13/00	90.8	0.47	0.178	0.09	0.02	0.03	NA
KAFS-02-05	5/30/02	90.7	2.65	0.301	0.800	0.06	0.10	0.000019U
Cleanup Level			1.3	0.005	1.00	0.70	10.0	0.000050

TABLE 3 - Groundwater Analytical Results - MW-8

Sample ID#	Date	SWL	GRO	Benz	Toluene	E-Benz	Xylenes	EDB
KAFS-99-22W	11/29/99	90.8	0.64	0.239	0.002U	0.00U	0.00U	NA
KAFS-00-28W	7/06/00	90.3	3.9	1.80	0.02U	0.02U	0.02U	NA
KAFS-00-38	12/13/00	90.3	1.6	0.830	0.023	0.02	0.02U	NA
KAFS-02-04	5/30/02	90.1	0.4	0.207	0.002U	0.00U	0.00U	0.000061
Cleanup Level			1.3	0.005	1.00	0.70	10.0	0.000050

TABLE 4 - Groundwater Analytical Results - MW-9

Sample ID#	Date	SWL	GRO	Benz	Toluene	E-Benz	Xylenes	EDB
KAFS-02-06	5/30/02	90.2	29.1	5.48	6.92	0.38	0.8	0.000069
Cleanup Level			1.3	0.005	1.00	0.70	10.0	0.000050

TABLE 5 - Groundwater Analytical Results - MW-10

Sample ID#	Date	SWL	GRO	Benz	Toluene	E-Benz	Xylenes	EDB
KAFS-02-06	5/30/02	90.9	0.3	0.022	0.05	0.01	0.02	0.000019U
Cleanup Level			1.3	0.005	1.00	0.70	10.0	0.000050

TABLE 6 - Groundwater Analytical Results - MW-11

Sample ID#	Date	SWL	GRO	Benz	Toluene	E-Benz	Xylenes	EDB
KAFS-02-06	5/30/02	90.9	0.7	0.093	0.15	0.02	0.06	0.000034
Cleanup Level			1.3	0.005	1.00	0.70	10.0	0.000050

CONSISTANT SOILS PROFILE @ SITE : PREDOMINANTLY KENAI
SANDS WITH SOME GRAVEL OCCASIONAL SILT STRINGERS.

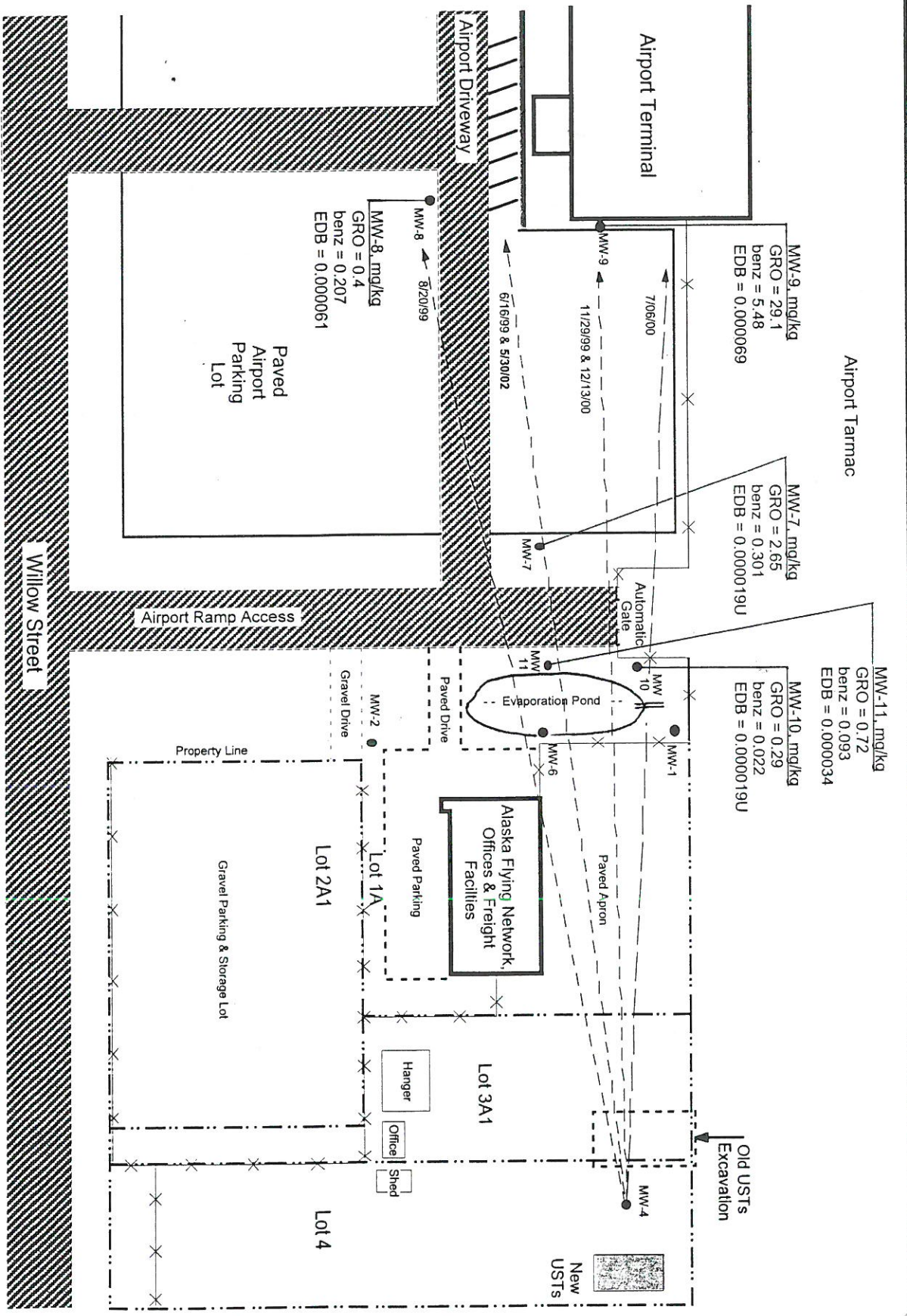

Figure 1. Groundwater Contamination Results for 5-30-02

Kenai Airport Fuel Service ADEC Reckey #90230026801
 Rozak Engineering Rev. No. 4 8-16-02

Legend

- MW
- Property Line
- - - Chain Link Fence
- - - Groundwater Flow
- ▨ Asphalt Pavement

