

ALASKA
Department of
Environmental
Conservation

**DRAFT (2) REPORT FOR GROUNDWATER SAMPLING
COASTAL DRILLING, ADEC File No. 2333.38.013
SOLDOTNA, ALASKA**

December 1, 2008



Prepared by:



825 W. 8th Ave.
Anchorage, AK 99501

December 1, 2008

Mr. Dennis Harwood
Alaska Department of Environmental Conservation
555 Cordova St.
Anchorage, AK 99501

**Subject: DRAFT(2) Report for Coastal Drilling Monitoring Well Sampling
Soldotna, AK
ADEC File No. 2333.38.013; Spill No. 1987230126701**

Dear Mr. Harwood:

This letter presents the report for a monitoring well sampling event conducted by OASIS Environmental, Inc. (OASIS) at the Coastal Drilling Site to update site hydrogeology and groundwater contamination information. The Coastal Drilling Site is located at Mile 0.5 Kenai Spur Highway in Soldotna, Alaska (Figure 1). The work also included well decommissioning, well rehabilitation, and monitoring well network surveying. This report is being submitted as part of the requirements of the Scope of Work. This work is being conducted under OASIS Alaska Department of Environmental Conservation (ADEC) Term Contract No. 18-902813, Notice-to-Proceed No. 18-902813-55.

SITE HISTORY

The Coastal Drilling Facility was developed in 1957 as a maintenance and support facility for petroleum and gas exploration in Cook Inlet. Disposal of old engines, drill rig parts, oil tanks, drums, drilling muds, waste oil, and miscellaneous scrap metal, rubber, and timber is known to have occurred at the site. Two centrally located, adjacent pits (one covered and one uncovered) were reportedly used for much of the disposal and have been the focus of past environmental investigations. The covered pit was also used as a drain field for wastes that were discharged into a metal grate located near a concrete slab. The grate is connected to the pit by a 6-inch-diameter steel pipe. Previous environmental investigations have encountered petroleum hydrocarbons, chlorinated solvents, and polychlorinated biphenyls (PCBs) in surface and subsurface soils. Low to non-detectable levels of aromatic hydrocarbons have been encountered in groundwater beneath the site.

REGULATORY FRAMEWORK

Groundwater laboratory results obtained from the monitoring well network at the Coastal Drilling site were compared to cleanup levels presented in 18 AAC 75.345, Table C (October 9, 2008). The following table presents the cleanup levels that were utilized for comparison to analytical results.

PROJECT GROUNDWATER CLEANUP LEVELS

Parameter / Analytical Method	ADEC Cleanup Level in milligrams per liter (mg/L)
Volatile organic compounds (VOC) / EPA 8260B	Dependent on Analyte
Gasoline range organics (GRO) / AK 101	2.2
Diesel range organics (DRO) / AK 102	1.5
Barium / EPA 6010B	2.0
Chromium / EPA 6010B	0.1
Lead / EPA 6010B	0.015

WORK PERFORMED

OASIS personnel mobilized to the site on September 15, 2008 and met the drilling subcontractor, Hughes Drilling, for well decommissioning and rehabilitation. GW-1 and B-11MW were decommissioned in general accordance with the ADEC Monitoring Well Design and Construction guidance dated February 2008. For B-11MW, the upper 5 feet of the well was removed, and the remaining hole filled with volclay to within 1 foot of the surface. The upper foot was completed with native materials. The casing for GW-1 broke 3 feet below ground surface (bgs). Attempts to reattach to the casing failed. The remaining hole was filled with volclay to within 1 foot of the surface. The upper foot was completed with native materials. Well decommissioning activities were photo-documented; photographs are provided in Appendix A.

GW-2 was rehabilitated by removing the present flush monument, extending the well up by approximately 3 feet, and completing the well with an aboveground, lockable monument. A well lock matching the other site locks were put on the monument to secure the well.

Groundwater levels in GW-2 through GW-7 and B-1MW through B-3MW were then measured. Following groundwater level measuring, wells were purged using disposable bailers on September 15 and 16, 2008. A minimum of three casing volumes were removed from each well; the purge water was observed for sheen and odor. Purge water was containerized. Water from outside the fenced area was segregated from the purge water within the fence to allow for potentially different disposal options.

Upon completion of purging, samples were collected from each well except B-4MW. This well contained approximately one foot of water when measured on September 15, but was found to be dry on September 16.

Volatile analyses (volatile organic compounds [VOCs] and gasoline-range organics [GRO]) were collected first followed by semi- and non-volatile analytes (diesel-range organics [DRO] and dissolved metals [barium, chromium, and lead]). Dissolved metals samples were collected by pumping samples from the bailer through a 0.45 micron filter using a peristaltic pump into the appropriate laboratory provided containers.

Samples were immediately labeled with the monitoring well name, date, time, requested analysis, and sampler's initials. They were then placed in sample coolers with gel ice and maintained at 4 degrees Celsius (°C) until delivered to the laboratory under chain-of-custody procedures.

All site wells were located by a professional land surveyor (PLS). The PLS located all monitoring wells to within 0.5 feet and determine the elevation of all measuring points to the nearest 0.01 foot. The horizontal location of KM-1, a water supply well not included in sampling program, was also determined. Survey information is included in Appendix B.

The individuals who performed the site work met the definition of, or were supervised by a person who meets the definition of, a "qualified person" as per 18 AAC 75.990(100).

GROUNDWATER OBSERVATIONS

Groundwater levels were generally 33 to 40 feet below the top of the well casings (Table 1). Figure 2 presents the inferred groundwater contours for the site. Groundwater flow on the eastern portion of the site is to the west to west north-west with a hydraulic gradient of 0.033. At the fenced area, the groundwater flow direction becomes variable from northward to west-southwestward, and the gradient becomes much flatter, on the order of 0.010 to 0.005 depending on location.

ANALYTICAL RESULTS

Laboratory results are summarized in Table 2. Laboratory reports are provided in Appendix C.

VOCs, GRO, DRO, chromium, and lead results were non-detect (ND) for all samples. Dissolved barium was detected in all samples at a maximum concentration of 0.102 mg/L (GW-5). All concentrations are below the ADEC groundwater cleanup level of 2.0 mg/L.

Data Quality Review

An ADEC Laboratory Data Review Checklist is provided in Appendix C. No data issues were identified by the laboratory or during our review of the data; all data is accepted for the purposes of this report.

CONCLUSIONS

Only barium was detected in the site samples and no concentrations were detected above ADEC cleanup levels in any wells sampled. It appears that groundwater impacts at the site have attenuated over time. All purge/decontamination water from this sampling event can be disposed of on site; we recommend for perception that the drums be emptied inside the fenced area.

As stated in our trip report from May 2008 (OASIS 2008), five empty drums and 9 drums with contents are present within the fenced area; two full drums are present outside the fenced area near GW-2. A least one drum within the fenced area is located within one of the shallow ponded pits (see report cover); it is not known whether this drum is empty or not. Presumably, the contents of the drums are soil and water from past drilling and groundwater sampling activities on the site. In order to bring the site to closure, we recommend that the drums be opened, the contents characterized, and the drums and contents disposed of. Retrieval of the drum in the ponded pit may involve the use of heavy equipment and the removal of some trees and brush.

LIMITATIONS

Work for this project was performed, and this letter report prepared, in accordance with generally accepted professional practices for the nature and conditions of the work completed in the same and similar localities, at the time that the work was performed. It is intended for the exclusive use of ADEC. This letter report is not meant to represent a legal opinion, and no other warranty, express or implied, is made.

We appreciate the opportunity to assist ADEC with this project. If you should have any questions regarding this report, please contact us at 907.258.4880.

Sincerely,

OASIS Environmental, Inc.

Herminio R. Muniz, C.P.G.

Sr. Hydrogeologist

Attachments:

1. Table 1 – Groundwater Elevations – September 15 & 16, 2008
2. Table 2 – Groundwater Laboratory Analytical Results
3. Figure 1 – Site Location Map
4. Figure 2 – Site Plan
5. Appendix A – Photographs
6. Appendix B – Survey Information
7. Appendix C – ADEC Laboratory Data Review Checklist and Laboratory Reports

TABLES

- Page Intentionally Left Blank -

Table 1 - Groundwater Elevations - September 15 & 16, 2008
Coastal Drilling Site
Soldotna, Alaska

Well Number	Measuring Point Elevation ¹ in feet	Depth to Water in feet BTOC	Groundwater Elevation in feet
GW-2	101.81	37.97	63.84
GW-3	101.61	37.58	64.03
GW-4	100.80	36.76	64.04
GW-5	99.85	35.66	64.19
GW-6	100.70	36.69	64.01
GW-7	102.99	33.03	69.96
BMW-2	103.02	39.76	63.26
BMW-3	102.03	38.20	63.83
BMW-4	101.90	Well Dry	

Notes:

¹ Horizontal Datum: NAD83 ASP Zone 4, Hor. Datum Source: KEN5 CORS Epoch 2003;

Vert. Datum: NGVD29, Vert. Datum Source BM B-79 Reset

BTOC = Below top of casing

**Table 2: Groundwater Laboratory Analytical Results
Coastal Drilling Site
Soldotna, Alaska**

Sample: Name	EPA Method 8260B	Alaska Method AK 101	Alaska Method AK 102	EPA Method 6010B		
	VOC in mg/L	GRO in mg/L	DRO in mg/L	Dissolved Barium in mg/L	Dissolved Chromium in mg/L	Dissolved Lead ² in mg/L
GW-2	ND	ND (0.50)	ND (0.40)	0.022	ND (0.008)	ND (0.0.015)
GW-3	ND	ND (0.50)	ND (0.40)	0.020	ND (0.008)	ND (0.0.015)
GW-4 Duplicate 1	ND	ND (0.50)	ND (0.40)	0.087	ND (0.008)	ND (0.0.015)
	ND	ND (0.50)	ND (0.40)	0.088	ND (0.008)	ND (0.0.015)
GW-5	ND	ND (0.50)	ND (0.40)	0.102	ND (0.008)	ND (0.0.015)
GW-6	ND	ND (0.50)	ND (0.40)	0.010	ND (0.008)	ND (0.0.015)
GW-7	ND	ND (0.50)	ND (0.40)	0.056	ND (0.008)	ND (0.0.015)
B-2MW	ND	ND (0.50)	ND (0.40)	0.022	ND (0.008)	ND (0.0.015)
B-3MW	ND	ND (0.50)	ND (0.40)	0.016	ND (0.008)	ND (0.0.015)
B-4MW	Not Sampled, No Water in Well					
Trip Blank	ND	ND (0.50)	-----	-----	-----	-----
ADEC Cleanup Level ¹ in mg/L	Various	2.2	1.5	2.0	0.1	0.015

Notes:

Results may be rounded.

¹18 AAC 75.345, Table C (October 9, 2008).

² Detection limit shown is method detection limit (MDL) not method reporting limit (MRL).

ADEC - Alaska Department of Environmental Conservation

DRO - diesel range organics

EPA - US Environmental Protection Agency

GRO - gasoline range organics

mg/L - milligrams per liter

ND (0.001) - none detected at concentration shown.

ND - No VOC analytes detected; analyte detection limits listed in laboratory report.

FIGURES

- Page Intentionally Left Blank -

PATH: V:\Project Drawings\CDF FILE: 14-138-CDF-WS-F1.DWG PLOTTED: 8/1/08.

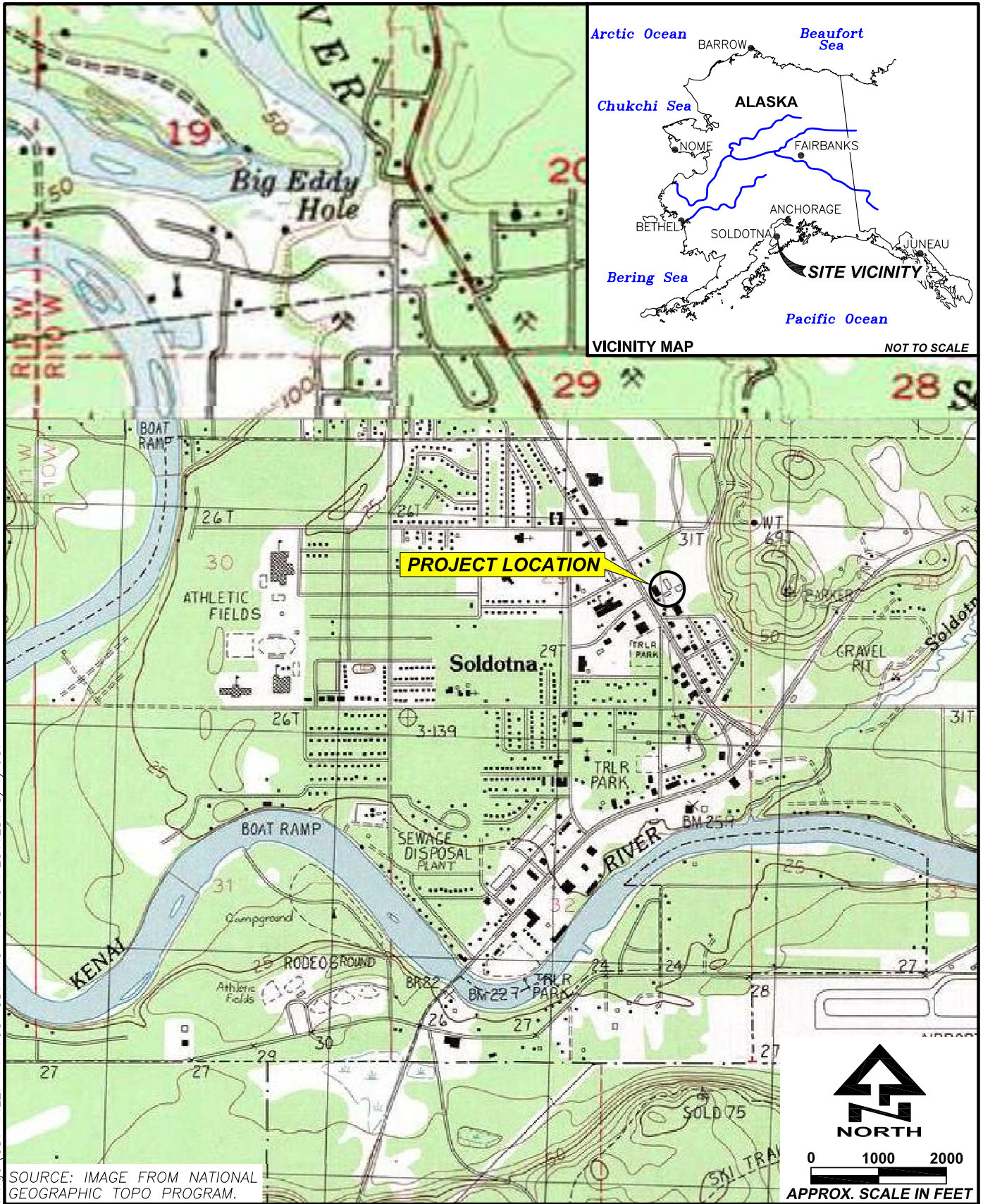

SOURCE: IMAGE FROM NATIONAL GEOGRAPHIC TOPO PROGRAM.



DATE: AUG. 2008
 CHKD: N.R.M.
 DRAWN: K.J.S.
 PROJ. No.: 14-138
 825 W. 8th Ave., Anchorage,
 AK 99501, (907) 258-4880

SITE LOCATION MAP

COASTAL DRILLING
 MONITORING WELL SAMPLING
 Soldotna, Alaska

FIGURE

1

PATH: V:\Project Drawings\CDF FILE: 14-138-CDF-WS-F2.DWG PLOTTED: 12/1/08.

KENAI SPUR ROAD

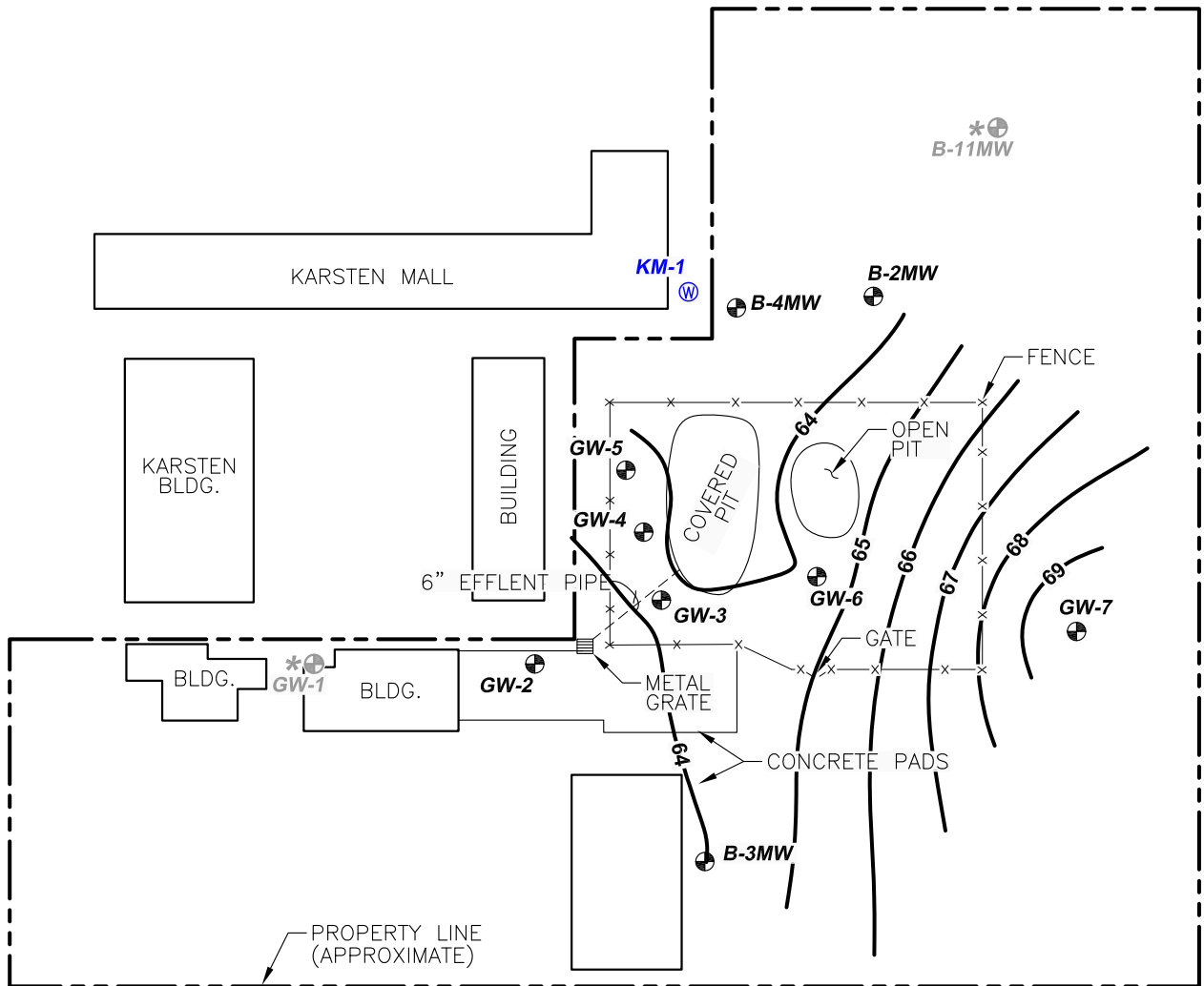

EXPLANATION

- GW-2 MONITORING WELL LOCATION
- GW-1* DECOMMISSIONED MONITORING WELL
- KARSTEN MALL WELL (NOT IN USE)
- 65— GROUNDWATER ELEVATION CONTOUR (AMSL)



0 60 120
APPROX. SCALE IN FEET



DATE: DEC. 2008
 CHKD: N.R.M.
 DRAWN: C.E.H.
 PROJ. No.: 14-138
 825 W. 8th Ave., Anchorage,
 AK 99501, (907) 258-4880

SITE PLAN

COASTAL DRILLING
 MONITORING WELL SAMPLING
 Soldotna, Alaska

FIGURE

2

APPENDIX A

Photographs

- Page Intentionally Left Blank -



Photograph 1: GW-1 with broken casing piece.



Photograph 2: Broken casing in ground, GW-1.



Photograph 3: Pumping volclay into GW-1.



Photograph 4: Removing well casing from B-11 MW.



Photograph 5: Remaining hole in B-11MW after with casing removal..



Photograph 6: B-11MW decommissioning completed.



Photograph 7: GW-2 with old monument removed and new casing extension attached.



Photograph 8: GW-2 after rehabilitation completed.

APPENDIX B
Survey Information

- Page Intentionally Left Blank -

Oasis Job No. 14-138
 Coastal Drilling Site
 Soldotna, AK



1 of 2
 10/21/2008

083087_Oasis_Coastal_Drilling.xls
 HORIZONTAL DATUM: NAD83 ASP ZONE 4
 HOR. DATUM SOURCE: KEN5 CORS EPOCH 2003
 VERT. DATUM: NGVD29
 VERT. DATUM SOURCE BM B-79 RESET

PT NO.	ASP NORTHING	ASP EASTING	ELEV. PVC	ELEV. CASING	ELEV. GROUND	DESCRIPTOR
16	2373462.15	1448571.82	101.81	101.97		99.39 GW2 WELL MONITOR
21	2373652.72	1448871.91	102.99	103.13		100.47 GW7 WELL MONITOR
22	2373402.83	1448732.09	102.03	102.45		99.43 B3 WELL MONITOR
23	2373601.66	1448705.76	100.70	101.00		99.49 GW6 WELL MONITOR
24	2373538.82	1448624.08	101.61	101.99		99.14 GW3 WELL MONITOR
25	2373572.23	1448592.42	100.80	100.98		98.89 GW4 WELL MONITOR
26	2373602.10	1448562.52	99.85	100.26		98.49 GW5 WELL MONITOR
29	2373730.262	1448574.342	101.90	102.54		100.14 B4 WELL MONITOR
30	2373780.30	1448649.17	103.02	103.24		100.14 B2 WELL MONITOR
34	2373724.23	1448541.752				100.56 KM1 WELL CASE
17	2373496.24	1448607.19				99.18 FENCE COR
18	2373538.04	1448682.32				99.58 FENCE COR
19	2373538.89	1448714.85				98.49 FENCE COR
20	2373601.08	1448830.07				99.29 FENCE COR
27	2373637.19	1448532.57				98.04 FENCE COR
28	2373754.70	1448744.97				100.67 FENCE COR
13	2373399.91	1448549.95				99.93 BLDG COR
14	2373445.92	1448524.64				99.69 BLDG COR
31	2373350.27	1448460.77				99.80 BLDG COR
32	2373797.75	1448485.48				98.00 BLDG COR
33	2373707.90	1448535.23				98.00 BLDG COR
13	2373399.91	1448549.95				99.93 BLDG COR
14	2373445.92	1448524.64				99.69 BLDG COR
31	2373350.27	1448460.77				99.80 BLDG COR
32	2373797.75	1448485.48				98.00 BLDG COR
33	2373707.90	1448535.23				98.00 BLDG COR

Oasis Job No. 14-138
Coastal Drilling Site
Soldotna, AK



2 of 2
10/21/2008

083087_Oasis_Coastal_Drilling.xls
HORIZONTAL DATUM: NAD83 ASP ZONE 4
HOR. DATUM SOURCE: KEN5 CORS EPOCH 2003
VERT. DATUM: NGVD29
VERT. DATUM SOURCE BM B-79 RESET

PT NO.	ASP NORTHING	ASP EASTING	ELEV. PVC	ELEV. CASING	ELEV. GROUND	DESCRIPTOR
10	2373445.16	1448691.20				99.57 PAD CONCRETE
11	2373410.25	1448628.18				99.56 PAD CONCRETE
12	2373487.03	1448709.41				99.65 PAD CONCRETE

APPENDIX C

ADEC Laboratory Data Review Checklist and Laboratory Reports

- Page Intentionally Left Blank -

ADEC Laboratory Data Review Checklist for TestAmerica W.O. ARI0068
Report for Coastal Drilling Monitoring Well Sampling, ADEC File No. 2333.38.013
December 1, 2008

1. Laboratory

a. Did an ADEC CS approved laboratory receive and perform all of the submitted sample analyses?

X Yes No Comments:

b. If the samples were transferred to another "network" laboratory or sub-contracted to an alternate laboratory, was the laboratory performing the analyses ADEC CS approved?

X Yes No Comments:

2. Chain of Custody (COC)

a. COC information completed, signed, and dated (including released/received by)?

X Yes No Comments:

b. Correct analyses requested?

X Yes No Comments:

3. Laboratory Sample receipt documentation

a. Sample/cooler temperature documented and within range at receipt (4o + 2 o C)?

X Yes No Comments:

b. Sample preservation acceptable – acidified waters, Methanol preserved VOC soil (GRO, BTEX, Volatile Chlorinated Solvents, etc.)?

X Yes No Comments:

c. Sample condition documented – broken, leaking (Methanol), zero headspace (VOC vials)?

Yes No Comments: N/A

d. If there were any discrepancies, were they documented?

Yes No Comments: N/A

e. Data quality or usability affected? No

4. Case Narrative

a. Present and understandable?

X Yes No Comments:

b. Discrepancies, errors or QC failures identified by the lab?

Yes No Comments:

c. Were all corrective actions documented?

Yes No Comments: N/A

d. What is the effect on data quality/usability according to the case narrative? None

5. Samples Results

a. Correct analyses performed/reported as requested on COC?

X Yes No Comments:

b. All applicable holding times met?

X Yes No Comments:

c. All soils reported on a dry weight basis?

Yes No Comments: N/A

d. Are the reported PQLs less than the Cleanup Level or the minimum required detection level for the project?

X Yes No Comments:

e. Data quality or usability affected? No

6. QC Samples

a. Method Blank

i. One method blank reported per matrix, analysis and 20 samples?

X Yes No Comments:

ii. All method blank results less than PQL?

X Yes No Comments:

iii. If above PQL, what samples are affected?

iv. Do the affected sample(s) have data flags? If so, are the data flags clearly defined?

Yes No Comments: N/A

v. Data quality or usability affected? No

b. Laboratory Control Sample/Duplicate (LCS/LCSD)

i. Organics - One LCS/LCSD reported per matrix, analysis and 20 samples?

X Yes No Comments:

ii. Metals/Inorganics - One LCS and one sample duplicate reported per matrix, analysis and 20 samples?

X Yes No Comments:

iii. Accuracy – All percent recoveries (%R) reported and within method or laboratory limits? Or project specified DQOs? (AK Petroleum methods 75-125 %R; all other analyses see the laboratory QC pages)

X Yes No Comments:

iv. Precision - All relative percent differences (RPD) reported and less than method or laboratory limits? Or project specified DQOs? (AK Petroleum methods 20 %; all other analyses see the laboratory QC pages)

X Yes No Comments:

v. If %R or RPD outside of acceptable limits, what samples are affected? None

vi. Do the affected sample(s) have data flags? If so, are the data flags clearly defined?

Yes No Comments: N/A

vii. Data quality or usability affected? No

c. Surrogates – Organics only

i. Are surrogate recoveries reported for organic analyses – field, QC and laboratory samples?

X Yes No Comments:

ii. Accuracy – All percent recoveries (%R) reported and within method or laboratory limits? Or project specified DQOs? (AK Petroleum methods 50-150 %R; all other analyses see the laboratory report pages)

X Yes No Comments:

iii. Do the sample results with failed surrogate recoveries have data flags? If so, are the data flags clearly defined?

X Yes No Comments:

iv. Data quality or usability affected? No

d. Trip Blank – Volatile analyses only (GRO, BTEX, Volatile Chlorinated Solvents, etc.): water and soil

i. One trip blank reported per matrix, analysis and cooler?

X Yes No Comments: N/A

ii. All results less than PQL?

X Yes No Comments:

iii. If above PQL, what samples are affected? N/A

iv. Data quality or usability affected? No

e. Field Duplicate

i. One field duplicate submitted per matrix, analysis and 10 project samples?

X Yes No Comments:

ii. Submitted blind to lab?

X Yes No Comments:

iii. Precision - All relative percent differences (RPD) less than specified DQOs?
(Recommended: 30% water, 50% soil)

X Yes No Comments: RPD 1.1% for barium analysis. All other results were ND and RPD could not be calculated.

iv. Data quality or usability affected? No

f. Decontamination or Equipment Blank (if applicable)

Yes No X Not Applicable

i. All results less than PQL?

Yes No Comments: N/A

ii. If above PQL, what samples are affected? N/A

iii. Data quality or usability affected? N/A

7. Other Data Flags/Qualifiers (ACOE, AFCEE, Lab specific, etc.)

a. Defined and appropriate

Yes No Comments: N/A

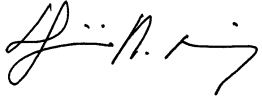
Project Manager:  Date: 12/1/08

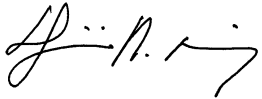
Supervisor:  Date: 12/1/08

October 02, 2008

Nino Muniz
Oasis Environmental, Inc.
825 W 8th Ave, ste 200
Anchorage, AK/USA 99501-4427

RE: Coastal Drilling

Enclosed are the results of analyses for samples received by the laboratory on 09/16/08 16:15.
The following list is a summary of the Work Orders contained in this report, generated on 10/02/08
10:19.

If you have any questions concerning this report, please feel free to contact me.

<u>Work Order</u>	<u>Project</u>	<u>ProjectNumber</u>
ARI0068	Coastal Drilling	14-138

TestAmerica Anchorage



Troy J. Engstrom, Lab Director

The results in this report apply to the samples analyzed in accordance with the chain of custody document. This analytical report must be reproduced in its entirety.



Oasis Environmental, Inc.

825 W 8th Ave, ste 200
Anchorage, AK/USA 99501-4427

Project Name: **Coastal Drilling**
Project Number: 14-138
Project Manager: Nino Muniz

Report Created:
10/02/08 10:19

ANALYTICAL REPORT FOR SAMPLES

Sample ID	Laboratory ID	Matrix	Date Sampled	Date Received
B-2MW	ARI0068-01	Water	09/16/08 11:10	09/16/08 16:15
B-3MW	ARI0068-02	Water	09/16/08 09:40	09/16/08 16:15
GW-2	ARI0068-03	Water	09/16/08 08:50	09/16/08 16:15
GW-3	ARI0068-04	Water	09/15/08 18:00	09/16/08 16:15
GW-4	ARI0068-05	Water	09/15/08 17:00	09/16/08 16:15
GW-5	ARI0068-06	Water	09/15/08 16:15	09/16/08 16:15
GW-6	ARI0068-07	Water	09/15/08 14:45	09/16/08 16:15
GW-7	ARI0068-08	Water	09/16/08 10:20	09/16/08 16:15
Duplicate 1	ARI0068-09	Water	09/15/08 14:00	09/16/08 16:15
Trip Blank	ARI0068-10	Water	09/15/08 12:00	09/16/08 16:15

TestAmerica Anchorage



Troy J. Engstrom, Lab Director

The results in this report apply to the samples analyzed in accordance with the chain of custody document. This analytical report must be reproduced in its entirety.



Oasis Environmental, Inc.

825 W 8th Ave, ste 200
 Anchorage, AK/USA 99501-4427

Project Name: **Coastal Drilling**
 Project Number: 14-138
 Project Manager: Nino Muniz

Report Created:
 10/02/08 10:19

Diesel Range Organics (C10-C25) per AK102
 TestAmerica Anchorage

Analyte	Method	Result	MDL*	MRL	Units	Dil	Batch	Prepared	Analyzed	Analyst	Notes
ARI0068-01 (B-2MW)		Water			Sampled: 09/16/08 11:10						
Diesel Range Organics	AK 102	ND	----	0.391	mg/l	1x	8090076	09/19/08 08:37	09/22/08 14:06	JN	
<i>Surrogate(s): 1-Chlorooctadecane</i>			94.1%		50 - 150 %		"			"	
ARI0068-02 (B-3MW)		Water			Sampled: 09/16/08 09:40						
Diesel Range Organics	AK 102	ND	----	0.391	mg/l	1x	8090076	09/19/08 08:37	09/22/08 14:38	JN	
<i>Surrogate(s): 1-Chlorooctadecane</i>			107%		50 - 150 %		"			"	
ARI0068-03 (GW-2)		Water			Sampled: 09/16/08 08:50						
Diesel Range Organics	AK 102	ND	----	0.391	mg/l	1x	8090076	09/19/08 08:37	09/22/08 14:38	JN	
<i>Surrogate(s): 1-Chlorooctadecane</i>			94.2%		50 - 150 %		"			"	
ARI0068-04 (GW-3)		Water			Sampled: 09/15/08 18:00						
Diesel Range Organics	AK 102	ND	----	0.391	mg/l	1x	8090076	09/19/08 08:37	09/22/08 15:10	JN	
<i>Surrogate(s): 1-Chlorooctadecane</i>			103%		50 - 150 %		"			"	
ARI0068-05 (GW-4)		Water			Sampled: 09/15/08 17:00						
Diesel Range Organics	AK 102	ND	----	0.391	mg/l	1x	8090076	09/19/08 08:37	09/22/08 15:10	JN	
<i>Surrogate(s): 1-Chlorooctadecane</i>			94.3%		50 - 150 %		"			"	
ARI0068-06 (GW-5)		Water			Sampled: 09/15/08 16:15						
Diesel Range Organics	AK 102	ND	----	0.391	mg/l	1x	8090076	09/19/08 08:37	09/22/08 15:42	JN	
<i>Surrogate(s): 1-Chlorooctadecane</i>			108%		50 - 150 %		"			"	
ARI0068-07 (GW-6)		Water			Sampled: 09/15/08 14:45						
Diesel Range Organics	AK 102	ND	----	0.391	mg/l	1x	8090076	09/19/08 08:37	09/22/08 15:42	JN	
<i>Surrogate(s): 1-Chlorooctadecane</i>			97.2%		50 - 150 %		"			"	
ARI0068-08 (GW-7)		Water			Sampled: 09/16/08 10:20						
Diesel Range Organics	AK 102	ND	----	0.391	mg/l	1x	8090076	09/19/08 08:37	09/22/08 16:46	JN	
<i>Surrogate(s): 1-Chlorooctadecane</i>			114%		50 - 150 %		"			"	

TestAmerica Anchorage



Troy J. Engstrom, Lab Director

The results in this report apply to the samples analyzed in accordance with the chain of custody document. This analytical report must be reproduced in its entirety.



Oasis Environmental, Inc. 825 W 8th Ave, ste 200 Anchorage, AK/USA 99501-4427	Project Name: Coastal Drilling Project Number: 14-138 Project Manager: Nino Muniz	Report Created: 10/02/08 10:19
--	--	-----------------------------------

Diesel Range Organics (C10-C25) per AK102
TestAmerica Anchorage

Analyte	Method	Result	MDL*	MRL	Units	Dil	Batch	Prepared	Analyzed	Analyst	Notes
ARI0068-09 (Duplicate 1)		Water			Sampled: 09/15/08 14:00						
Diesel Range Organics	AK 102	ND	----	0.391	mg/l	1x	8090076	09/19/08 08:37	09/22/08 16:46	JN	
<i>Surrogate(s): 1-Chlorooctadecane</i>			96.6%		50 - 150 %	"					"

TestAmerica Anchorage



Troy J. Engstrom, Lab Director

The results in this report apply to the samples analyzed in accordance with the chain of custody document. This analytical report must be reproduced in its entirety.



Oasis Environmental, Inc.

825 W 8th Ave, ste 200
 Anchorage, AK/USA 99501-4427

Project Name: **Coastal Drilling**

Project Number: 14-138

Project Manager: Nino Muniz

Report Created:

10/02/08 10:19

Gasoline Range Organics (C6-C10) per AK101-MS
 TestAmerica Anchorage

Analyte	Method	Result	MDL*	MRL	Units	Dil	Batch	Prepared	Analyzed	Analyst	Notes
ARI0068-01 (B-2MW)		Water			Sampled: 09/16/08 11:10						
Gasoline Range Organics	AK101 - MS	ND	----	50.0	ug/l	1x	8090073	09/18/08 08:58	09/18/08 19:50		ds
Surrogate(s): 4-BFB			102%		80 - 120 %	"					"
Dibromofluoromethane			111%		80 - 120 %	"					"
Toluene-d8			87.9%		80 - 120 %	"					"
ARI0068-02 (B-3MW)		Water			Sampled: 09/16/08 09:40						
Gasoline Range Organics	AK101 - MS	ND	----	50.0	ug/l	1x	8090073	09/18/08 08:58	09/18/08 20:25		ds
Surrogate(s): 4-BFB			101%		80 - 120 %	"					"
Dibromofluoromethane			110%		80 - 120 %	"					"
Toluene-d8			87.5%		80 - 120 %	"					"
ARI0068-03 (GW-2)		Water			Sampled: 09/16/08 08:50						
Gasoline Range Organics	AK101 - MS	ND	----	50.0	ug/l	1x	8090073	09/18/08 08:58	09/19/08 22:18		ds
Surrogate(s): 4-BFB			103%		80 - 120 %	"					"
Dibromofluoromethane			111%		80 - 120 %	"					"
Toluene-d8			86.8%		80 - 120 %	"					"
ARI0068-04 (GW-3)		Water			Sampled: 09/15/08 18:00						
Gasoline Range Organics	AK101 - MS	ND	----	50.0	ug/l	1x	8090073	09/18/08 08:58	09/19/08 12:52		ds
Surrogate(s): 4-BFB			101%		80 - 120 %	"					"
Dibromofluoromethane			112%		80 - 120 %	"					"
Toluene-d8			86.8%		80 - 120 %	"					"
ARI0068-05 (GW-4)		Water			Sampled: 09/15/08 17:00						
Gasoline Range Organics	AK101 - MS	ND	----	50.0	ug/l	1x	8090073	09/18/08 08:58	09/19/08 13:27		ds
Surrogate(s): 4-BFB			102%		80 - 120 %	"					"
Dibromofluoromethane			111%		80 - 120 %	"					"
Toluene-d8			87.3%		80 - 120 %	"					"
ARI0068-06 (GW-5)		Water			Sampled: 09/15/08 16:15						
Gasoline Range Organics	AK101 - MS	ND	----	50.0	ug/l	1x	8090073	09/18/08 08:58	09/19/08 14:01		ds
Surrogate(s): 4-BFB			102%		80 - 120 %	"					"
Dibromofluoromethane			111%		80 - 120 %	"					"
Toluene-d8			85.3%		80 - 120 %	"					"

TestAmerica Anchorage



Troy J. Engstrom, Lab Director

The results in this report apply to the samples analyzed in accordance with the chain of custody document. This analytical report must be reproduced in its entirety.



Oasis Environmental, Inc. 825 W 8th Ave, ste 200 Anchorage, AK/USA 99501-4427	Project Name: Coastal Drilling Project Number: 14-138 Project Manager: Nino Muniz	Report Created: 10/02/08 10:19
--	--	-----------------------------------

Gasoline Range Organics (C6-C10) per AK101-MS
TestAmerica Anchorage

Analyte	Method	Result	MDL*	MRL	Units	Dil	Batch	Prepared	Analyzed	Analyst	Notes
ARI0068-07 (GW-6)		Water			Sampled: 09/15/08 14:45						
Gasoline Range Organics	AK101 - MS	ND	----	50.0	ug/l	1x	8090073	09/18/08 08:58	09/19/08 14:35		ds
<i>Surrogate(s): 4-BFB</i>				102%		80 - 120 %	"				"
<i>Dibromofluoromethane</i>				111%		80 - 120 %	"				"
<i>Toluene-d8</i>				87.5%		80 - 120 %	"				"
ARI0068-08 (GW-7)		Water			Sampled: 09/16/08 10:20						
Gasoline Range Organics	AK101 - MS	ND	----	50.0	ug/l	1x	8090073	09/18/08 08:58	09/19/08 15:09		ds
<i>Surrogate(s): 4-BFB</i>				102%		80 - 120 %	"				"
<i>Dibromofluoromethane</i>				110%		80 - 120 %	"				"
<i>Toluene-d8</i>				86.1%		80 - 120 %	"				"
ARI0068-09 (Duplicate 1)		Water			Sampled: 09/15/08 14:00						
Gasoline Range Organics	AK101 - MS	ND	----	50.0	ug/l	1x	8090073	09/18/08 08:58	09/19/08 15:43		ds
<i>Surrogate(s): 4-BFB</i>				102%		80 - 120 %	"				"
<i>Dibromofluoromethane</i>				112%		80 - 120 %	"				"
<i>Toluene-d8</i>				86.1%		80 - 120 %	"				"
ARI0068-10 (Trip Blank)		Water			Sampled: 09/15/08 12:00						
Gasoline Range Organics	AK101 - MS	ND	----	50.0	ug/l	1x	8090073	09/18/08 08:58	09/19/08 11:45		ds
<i>Surrogate(s): 4-BFB</i>				102%		80 - 120 %	"				"
<i>Dibromofluoromethane</i>				112%		80 - 120 %	"				"
<i>Toluene-d8</i>				86.1%		80 - 120 %	"				"

TestAmerica Anchorage

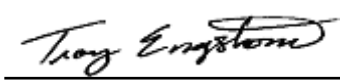

Troy J. Engstrom, Lab Director

The results in this report apply to the samples analyzed in accordance with the chain of custody document. This analytical report must be reproduced in its entirety.



Oasis Environmental, Inc. 825 W 8th Ave, ste 200 Anchorage, AK/USA 99501-4427	Project Name: Coastal Drilling Project Number: 14-138 Project Manager: Nino Muniz	Report Created: 10/02/08 10:19
--	--	-----------------------------------

Total Metals by EPA 6010/7000 Series Methods
TestAmerica Spokane

Analyte	Method	Result	MDL*	MRL	Units	Dil	Batch	Prepared	Analyzed	Analyst	Notes
ARI0068-01 (B-2MW)		Water			Sampled: 09/16/08 11:10						
Barium	EPA 6010C	0.0223	----	0.00800	mg/l	1x	8090158	09/22/08 08:13	09/23/08 10:09	ICP	
Chromium	"	ND	----	0.00800	"	"	"	"	"	ICP	
Lead	"	ND	----	0.0150	"	"	"	"	"	ICP	
ARI0068-02 (B-3MW)		Water			Sampled: 09/16/08 09:40						
Barium	EPA 6010C	0.0157	----	0.00800	mg/l	1x	8090158	09/22/08 08:13	09/23/08 10:32	ICP	
Chromium	"	ND	----	0.00800	"	"	"	"	"	ICP	
Lead	"	ND	----	0.0150	"	"	"	"	"	ICP	
ARI0068-03 (GW-2)		Water			Sampled: 09/16/08 08:50						
Barium	EPA 6010C	0.0217	----	0.00800	mg/l	1x	8090158	09/22/08 08:13	09/23/08 10:37	ICP	
Chromium	"	ND	----	0.00800	"	"	"	"	"	ICP	
Lead	"	ND	----	0.0150	"	"	"	"	"	ICP	
ARI0068-04 (GW-3)		Water			Sampled: 09/15/08 18:00						
Barium	EPA 6010C	0.0203	----	0.00800	mg/l	1x	8090158	09/22/08 08:13	09/23/08 10:42	ICP	
Chromium	"	ND	----	0.00800	"	"	"	"	"	ICP	
Lead	"	ND	----	0.0150	"	"	"	"	"	ICP	
ARI0068-05 (GW-4)		Water			Sampled: 09/15/08 17:00						
Barium	EPA 6010C	0.0868	----	0.00800	mg/l	1x	8090158	09/22/08 08:13	09/23/08 10:47	ICP	
Chromium	"	ND	----	0.00800	"	"	"	"	"	ICP	
Lead	"	ND	----	0.0150	"	"	"	"	"	ICP	
ARI0068-06 (GW-5)		Water			Sampled: 09/15/08 16:15						
Barium	EPA 6010C	0.102	----	0.00800	mg/l	1x	8090158	09/22/08 08:13	09/23/08 10:52	ICP	
Chromium	"	ND	----	0.00800	"	"	"	"	"	ICP	
Lead	"	ND	----	0.0150	"	"	"	"	"	ICP	
ARI0068-07 (GW-6)		Water			Sampled: 09/15/08 14:45						
Barium	EPA 6010C	0.0102	----	0.00800	mg/l	1x	8090158	09/22/08 08:13	09/23/08 10:57	ICP	
Chromium	"	ND	----	0.00800	"	"	"	"	"	ICP	
Lead	"	ND	----	0.0150	"	"	"	"	"	ICP	

TestAmerica Anchorage



Troy J. Engstrom, Lab Director

The results in this report apply to the samples analyzed in accordance with the chain of custody document. This analytical report must be reproduced in its entirety.



Oasis Environmental, Inc.	Project Name: Coastal Drilling	
825 W 8th Ave, ste 200	Project Number: 14-138	Report Created:
Anchorage, AK/USA 99501-4427	Project Manager: Nino Muniz	10/02/08 10:19

Total Metals by EPA 6010/7000 Series Methods
 TestAmerica Spokane

Analyte	Method	Result	MDL*	MRL	Units	Dil	Batch	Prepared	Analyzed	Analyst	Notes
ARI0068-08 (GW-7)		Water			Sampled: 09/16/08 10:20						
Barium	EPA 6010C	0.0564	----	0.00800	mg/l	1x	8090158	09/22/08 08:13	09/23/08 11:02	ICP	
Chromium	"	ND	----	0.00800	"	"	"	"	"	ICP	
Lead	"	ND	----	0.0150	"	"	"	"	"	ICP	
ARI0068-09 (Duplicate 1)		Water			Sampled: 09/15/08 14:00						
Barium	EPA 6010C	0.0878	----	0.00800	mg/l	1x	8090158	09/22/08 08:13	09/23/08 11:07	ICP	
Chromium	"	ND	----	0.00800	"	"	"	"	"	ICP	
Lead	"	ND	----	0.0150	"	"	"	"	"	ICP	

TestAmerica Anchorage



Troy J. Engstrom, Lab Director

The results in this report apply to the samples analyzed in accordance with the chain of custody document. This analytical report must be reproduced in its entirety.



Oasis Environmental, Inc.

825 W 8th Ave, ste 200
 Anchorage, AK/USA 99501-4427

Project Name: **Coastal Drilling**

Project Number: 14-138

Project Manager: Nino Muniz

Report Created:

10/02/08 10:19

Volatile Organic Compounds by EPA Method 8260B
 TestAmerica Spokane

Analyte	Method	Result	MDL*	MRL	Units	Dil	Batch	Prepared	Analyzed	Analyst	Notes
ARI0068-01 (B-2MW)		Water			Sampled: 09/16/08 11:10						
Dichlorodifluoromethane	EPA 8260B	ND	----	1.00	ug/l	1x	8090178	09/24/08 08:23	09/24/08 13:55	Chr	
Chloromethane	"	ND	----	5.00	"	"	"	"	"	Chr	
Vinyl chloride	"	ND	----	0.200	"	"	"	"	"	Chr	
Bromomethane	"	ND	----	5.00	"	"	"	"	"	Chr	
Chloroethane	"	ND	----	1.00	"	"	"	"	"	Chr	
Trichlorofluoromethane	"	ND	----	1.00	"	"	"	"	"	Chr	
1,1-Dichloroethene	"	ND	----	1.00	"	"	"	"	"	Chr	
Carbon disulfide	"	ND	----	1.00	"	"	"	"	"	Chr	
Methylene chloride	"	ND	----	10.0	"	"	"	"	"	Chr	
Acetone	"	ND	----	25.0	"	"	"	"	"	Chr	
trans-1,2-Dichloroethene	"	ND	----	1.00	"	"	"	"	"	Chr	
Methyl tert-butyl ether	"	ND	----	1.00	"	"	"	"	"	Chr	
1,1-Dichloroethane	"	ND	----	1.00	"	"	"	"	"	Chr	
cis-1,2-Dichloroethene	"	ND	----	1.00	"	"	"	"	"	Chr	
2,2-Dichloropropane	"	ND	----	1.00	"	"	"	"	"	Chr	
Bromochloromethane	"	ND	----	1.00	"	"	"	"	"	Chr	
Chloroform	"	ND	----	1.00	"	"	"	"	"	Chr	
Carbon tetrachloride	"	ND	----	1.00	"	"	"	"	"	Chr	
1,1,1-Trichloroethane	"	ND	----	1.00	"	"	"	"	"	Chr	
2-Butanone	"	ND	----	10.0	"	"	"	"	"	Chr	
1,1-Dichloropropene	"	ND	----	1.00	"	"	"	"	"	Chr	
Benzene	"	ND	----	0.200	"	"	"	"	"	Chr	
1,2-Dichloroethane (EDC)	"	ND	----	1.00	"	"	"	"	"	Chr	
Trichloroethene	"	ND	----	1.00	"	"	"	"	"	Chr	
Dibromomethane	"	ND	----	1.00	"	"	"	"	"	Chr	
1,2-Dichloropropane	"	ND	----	1.00	"	"	"	"	"	Chr	
Bromodichloromethane	"	ND	----	1.00	"	"	"	"	"	Chr	
cis-1,3-Dichloropropene	"	ND	----	1.00	"	"	"	"	"	Chr	
Toluene	"	ND	----	1.00	"	"	"	"	"	Chr	
4-Methyl-2-pentanone	"	ND	----	10.0	"	"	"	"	"	Chr	
trans-1,3-Dichloropropene	"	ND	----	1.00	"	"	"	"	"	Chr	
Tetrachloroethene	"	ND	----	1.00	"	"	"	"	"	Chr	
1,1,2-Trichloroethane	"	ND	----	1.00	"	"	"	"	"	Chr	
Dibromochloromethane	"	ND	----	1.00	"	"	"	"	"	Chr	
1,3-Dichloropropane	"	ND	----	1.00	"	"	"	"	"	Chr	
1,2-Dibromoethane	"	ND	----	1.00	"	"	"	"	"	Chr	
2-Hexanone	"	ND	----	10.0	"	"	"	"	"	Chr	

TestAmerica Anchorage



Troy J. Engstrom, Lab Director

The results in this report apply to the samples analyzed in accordance with the chain of custody document. This analytical report must be reproduced in its entirety.



Oasis Environmental, Inc.	Project Name: Coastal Drilling	
825 W 8th Ave, ste 200	Project Number: 14-138	Report Created:
Anchorage, AK/USA 99501-4427	Project Manager: Nino Muniz	10/02/08 10:19

Volatile Organic Compounds by EPA Method 8260B
 TestAmerica Spokane

Analyte	Method	Result	MDL*	MRL	Units	Dil	Batch	Prepared	Analyzed	Analyst	Notes
ARI0068-01 (B-2MW)		Water									
		Sampled: 09/16/08 11:10									
Ethylbenzene	EPA 8260B	ND	----	1.00	ug/l	1x	8090178	09/24/08 08:23	09/24/08 13:55		Chr
Chlorobenzene	"	ND	----	1.00	"	"	"	"	"		Chr
1,1,1,2-Tetrachloroethane	"	ND	----	1.00	"	"	"	"	"		Chr
m,p-Xylene	"	ND	----	2.00	"	"	"	"	"		Chr
o-Xylene	"	ND	----	1.00	"	"	"	"	"		Chr
Styrene	"	ND	----	1.00	"	"	"	"	"		Chr
Bromoform	"	ND	----	1.00	"	"	"	"	"		Chr
Isopropylbenzene	"	ND	----	1.00	"	"	"	"	"		Chr
n-Propylbenzene	"	ND	----	1.00	"	"	"	"	"		Chr
1,1,2,2-Tetrachloroethane	"	ND	----	1.00	"	"	"	"	"		Chr
Bromobenzene	"	ND	----	1.00	"	"	"	"	"		Chr
1,3,5-Trimethylbenzene	"	ND	----	1.00	"	"	"	"	"		Chr
2-Chlorotoluene	"	ND	----	1.00	"	"	"	"	"		Chr
1,2,3-Trichloropropane	"	ND	----	1.00	"	"	"	"	"		Chr
4-Chlorotoluene	"	ND	----	1.00	"	"	"	"	"		Chr
tert-Butylbenzene	"	ND	----	1.00	"	"	"	"	"		Chr
1,2,4-Trimethylbenzene	"	ND	----	1.00	"	"	"	"	"		Chr
sec-Butylbenzene	"	ND	----	1.00	"	"	"	"	"		Chr
p-Isopropyltoluene	"	ND	----	1.00	"	"	"	"	"		Chr
1,3-Dichlorobenzene	"	ND	----	1.00	"	"	"	"	"		Chr
1,4-Dichlorobenzene	"	ND	----	1.00	"	"	"	"	"		Chr
n-Butylbenzene	"	ND	----	1.00	"	"	"	"	"		Chr
1,2-Dichlorobenzene	"	ND	----	1.00	"	"	"	"	"		Chr
1,2-Dibromo-3-chloropropane	"	ND	----	5.00	"	"	"	"	"		Chr
Hexachlorobutadiene	"	ND	----	1.00	"	"	"	"	"		Chr
1,2,4-Trichlorobenzene	"	ND	----	1.00	"	"	"	"	"		Chr
Naphthalene	"	ND	----	2.00	"	"	"	"	"		Chr
1,2,3-Trichlorobenzene	"	ND	----	1.00	"	"	"	"	"		Chr
<i>Surrogate(s):</i>	<i>Dibromofluoromethane</i>			<i>107%</i>			<i>62.2 - 128 %</i>	<i>"</i>			<i>"</i>
	<i>Toluene-d8</i>			<i>86.0%</i>			<i>75.4 - 120 %</i>	<i>"</i>			<i>"</i>
	<i>4-bromofluorobenzene</i>			<i>84.8%</i>			<i>77.3 - 129 %</i>	<i>"</i>			<i>"</i>

TestAmerica Anchorage



Troy J. Engstrom, Lab Director

The results in this report apply to the samples analyzed in accordance with the chain of custody document. This analytical report must be reproduced in its entirety.



Oasis Environmental, Inc.	Project Name: Coastal Drilling	
825 W 8th Ave, ste 200	Project Number: 14-138	Report Created:
Anchorage, AK/USA 99501-4427	Project Manager: Nino Muniz	10/02/08 10:19

Volatile Organic Compounds by EPA Method 8260B
 TestAmerica Spokane

Analyte	Method	Result	MDL*	MRL	Units	Dil	Batch	Prepared	Analyzed	Analyst	Notes
ARI0068-02 (B-3MW)		Water									
		Sampled: 09/16/08 09:40									
Dichlorodifluoromethane	EPA 8260B	ND	----	1.00	ug/l	1x	8090178	09/24/08 08:23	09/24/08 15:24	Chr	
Chloromethane	"	ND	----	5.00	"	"	"	"	"	Chr	
Vinyl chloride	"	ND	----	0.200	"	"	"	"	"	Chr	
Bromomethane	"	ND	----	5.00	"	"	"	"	"	Chr	
Chloroethane	"	ND	----	1.00	"	"	"	"	"	Chr	
Trichlorofluoromethane	"	ND	----	1.00	"	"	"	"	"	Chr	
1,1-Dichloroethene	"	ND	----	1.00	"	"	"	"	"	Chr	
Carbon disulfide	"	ND	----	1.00	"	"	"	"	"	Chr	
Methylene chloride	"	ND	----	10.0	"	"	"	"	"	Chr	
Acetone	"	ND	----	25.0	"	"	"	"	"	Chr	
trans-1,2-Dichloroethene	"	ND	----	1.00	"	"	"	"	"	Chr	
Methyl tert-butyl ether	"	ND	----	1.00	"	"	"	"	"	Chr	
1,1-Dichloroethane	"	ND	----	1.00	"	"	"	"	"	Chr	
cis-1,2-Dichloroethene	"	ND	----	1.00	"	"	"	"	"	Chr	
2,2-Dichloropropane	"	ND	----	1.00	"	"	"	"	"	Chr	
Bromochloromethane	"	ND	----	1.00	"	"	"	"	"	Chr	
Chloroform	"	ND	----	1.00	"	"	"	"	"	Chr	
Carbon tetrachloride	"	ND	----	1.00	"	"	"	"	"	Chr	
1,1,1-Trichloroethane	"	ND	----	1.00	"	"	"	"	"	Chr	
2-Butanone	"	ND	----	10.0	"	"	"	"	"	Chr	
1,1-Dichloropropene	"	ND	----	1.00	"	"	"	"	"	Chr	
Benzene	"	ND	----	0.200	"	"	"	"	"	Chr	
1,2-Dichloroethane (EDC)	"	ND	----	1.00	"	"	"	"	"	Chr	
Trichloroethene	"	ND	----	1.00	"	"	"	"	"	Chr	
Dibromomethane	"	ND	----	1.00	"	"	"	"	"	Chr	
1,2-Dichloropropane	"	ND	----	1.00	"	"	"	"	"	Chr	
Bromodichloromethane	"	ND	----	1.00	"	"	"	"	"	Chr	
cis-1,3-Dichloropropene	"	ND	----	1.00	"	"	"	"	"	Chr	
Toluene	"	ND	----	1.00	"	"	"	"	"	Chr	
4-Methyl-2-pentanone	"	ND	----	10.0	"	"	"	"	"	Chr	
trans-1,3-Dichloropropene	"	ND	----	1.00	"	"	"	"	"	Chr	
Tetrachloroethene	"	ND	----	1.00	"	"	"	"	"	Chr	
1,1,2-Trichloroethane	"	ND	----	1.00	"	"	"	"	"	Chr	
Dibromochloromethane	"	ND	----	1.00	"	"	"	"	"	Chr	
1,3-Dichloropropane	"	ND	----	1.00	"	"	"	"	"	Chr	
1,2-Dibromoethane	"	ND	----	1.00	"	"	"	"	"	Chr	
2-Hexanone	"	ND	----	10.0	"	"	"	"	"	Chr	

TestAmerica Anchorage

The results in this report apply to the samples analyzed in accordance with the chain of custody document. This analytical report must be reproduced in its entirety.



Troy J. Engstrom, Lab Director



Oasis Environmental, Inc.

825 W 8th Ave, ste 200
 Anchorage, AK/USA 99501-4427

Project Name: **Coastal Drilling**

Project Number: 14-138

Project Manager: Nino Muniz

Report Created:

10/02/08 10:19

Volatile Organic Compounds by EPA Method 8260B
 TestAmerica Spokane

Analyte	Method	Result	MDL*	MRL	Units	Dil	Batch	Prepared	Analyzed	Analyst	Notes
ARI0068-02 (B-3MW)		Water			Sampled: 09/16/08 09:40						
Ethylbenzene	EPA 8260B	ND	----	1.00	ug/l	1x	8090178	09/24/08 08:23	09/24/08 15:24		Chr
Chlorobenzene	"	ND	----	1.00	"	"	"	"	"		Chr
1,1,1,2-Tetrachloroethane	"	ND	----	1.00	"	"	"	"	"		Chr
m,p-Xylene	"	ND	----	2.00	"	"	"	"	"		Chr
o-Xylene	"	ND	----	1.00	"	"	"	"	"		Chr
Styrene	"	ND	----	1.00	"	"	"	"	"		Chr
Bromoform	"	ND	----	1.00	"	"	"	"	"		Chr
Isopropylbenzene	"	ND	----	1.00	"	"	"	"	"		Chr
n-Propylbenzene	"	ND	----	1.00	"	"	"	"	"		Chr
1,1,2,2-Tetrachloroethane	"	ND	----	1.00	"	"	"	"	"		Chr
Bromobenzene	"	ND	----	1.00	"	"	"	"	"		Chr
1,3,5-Trimethylbenzene	"	ND	----	1.00	"	"	"	"	"		Chr
2-Chlorotoluene	"	ND	----	1.00	"	"	"	"	"		Chr
1,2,3-Trichloropropane	"	ND	----	1.00	"	"	"	"	"		Chr
4-Chlorotoluene	"	ND	----	1.00	"	"	"	"	"		Chr
tert-Butylbenzene	"	ND	----	1.00	"	"	"	"	"		Chr
1,2,4-Trimethylbenzene	"	ND	----	1.00	"	"	"	"	"		Chr
sec-Butylbenzene	"	ND	----	1.00	"	"	"	"	"		Chr
p-Isopropyltoluene	"	ND	----	1.00	"	"	"	"	"		Chr
1,3-Dichlorobenzene	"	ND	----	1.00	"	"	"	"	"		Chr
1,4-Dichlorobenzene	"	ND	----	1.00	"	"	"	"	"		Chr
n-Butylbenzene	"	ND	----	1.00	"	"	"	"	"		Chr
1,2-Dichlorobenzene	"	ND	----	1.00	"	"	"	"	"		Chr
1,2-Dibromo-3-chloropropane	"	ND	----	5.00	"	"	"	"	"		Chr
Hexachlorobutadiene	"	ND	----	1.00	"	"	"	"	"		Chr
1,2,4-Trichlorobenzene	"	ND	----	1.00	"	"	"	"	"		Chr
Naphthalene	"	ND	----	2.00	"	"	"	"	"		Chr
1,2,3-Trichlorobenzene	"	ND	----	1.00	"	"	"	"	"		Chr
<i>Surrogate(s):</i>	<i>Dibromofluoromethane</i>			<i>109%</i>			<i>62.2 - 128 %</i>	<i>"</i>			<i>"</i>
	<i>Toluene-d8</i>			<i>85.4%</i>			<i>75.4 - 120 %</i>	<i>"</i>			<i>"</i>
	<i>4-bromofluorobenzene</i>			<i>86.2%</i>			<i>77.3 - 129 %</i>	<i>"</i>			<i>"</i>

TestAmerica Anchorage



Troy J. Engstrom, Lab Director

The results in this report apply to the samples analyzed in accordance with the chain of custody document. This analytical report must be reproduced in its entirety.



Oasis Environmental, Inc.

825 W 8th Ave, ste 200
 Anchorage, AK/USA 99501-4427

Project Name: **Coastal Drilling**

Project Number: 14-138

Project Manager: Nino Muniz

Report Created:

10/02/08 10:19

Volatile Organic Compounds by EPA Method 8260B
 TestAmerica Spokane

Analyte	Method	Result	MDL*	MRL	Units	Dil	Batch	Prepared	Analyzed	Analyst	Notes
ARI0068-03 (GW-2)		Water			Sampled: 09/16/08 08:50						
Dichlorodifluoromethane	EPA 8260B	ND	----	1.00	ug/l	1x	8090178	09/24/08 08:23	09/24/08 15:54	Chr	
Chloromethane	"	ND	----	5.00	"	"	"	"	"	Chr	
Vinyl chloride	"	ND	----	0.200	"	"	"	"	"	Chr	
Bromomethane	"	ND	----	5.00	"	"	"	"	"	Chr	
Chloroethane	"	ND	----	1.00	"	"	"	"	"	Chr	
Trichlorofluoromethane	"	ND	----	1.00	"	"	"	"	"	Chr	
1,1-Dichloroethene	"	ND	----	1.00	"	"	"	"	"	Chr	
Carbon disulfide	"	ND	----	1.00	"	"	"	"	"	Chr	
Methylene chloride	"	ND	----	10.0	"	"	"	"	"	Chr	
Acetone	"	ND	----	25.0	"	"	"	"	"	Chr	
trans-1,2-Dichloroethene	"	ND	----	1.00	"	"	"	"	"	Chr	
Methyl tert-butyl ether	"	ND	----	1.00	"	"	"	"	"	Chr	
1,1-Dichloroethane	"	ND	----	1.00	"	"	"	"	"	Chr	
cis-1,2-Dichloroethene	"	ND	----	1.00	"	"	"	"	"	Chr	
2,2-Dichloropropane	"	ND	----	1.00	"	"	"	"	"	Chr	
Bromochloromethane	"	ND	----	1.00	"	"	"	"	"	Chr	
Chloroform	"	ND	----	1.00	"	"	"	"	"	Chr	
Carbon tetrachloride	"	ND	----	1.00	"	"	"	"	"	Chr	
1,1,1-Trichloroethane	"	ND	----	1.00	"	"	"	"	"	Chr	
2-Butanone	"	ND	----	10.0	"	"	"	"	"	Chr	
1,1-Dichloropropene	"	ND	----	1.00	"	"	"	"	"	Chr	
Benzene	"	ND	----	0.200	"	"	"	"	"	Chr	
1,2-Dichloroethane (EDC)	"	ND	----	1.00	"	"	"	"	"	Chr	
Trichloroethene	"	ND	----	1.00	"	"	"	"	"	Chr	
Dibromomethane	"	ND	----	1.00	"	"	"	"	"	Chr	
1,2-Dichloropropane	"	ND	----	1.00	"	"	"	"	"	Chr	
Bromodichloromethane	"	ND	----	1.00	"	"	"	"	"	Chr	
cis-1,3-Dichloropropene	"	ND	----	1.00	"	"	"	"	"	Chr	
Toluene	"	ND	----	1.00	"	"	"	"	"	Chr	
4-Methyl-2-pentanone	"	ND	----	10.0	"	"	"	"	"	Chr	
trans-1,3-Dichloropropene	"	ND	----	1.00	"	"	"	"	"	Chr	
Tetrachloroethene	"	ND	----	1.00	"	"	"	"	"	Chr	
1,1,2-Trichloroethane	"	ND	----	1.00	"	"	"	"	"	Chr	
Dibromochloromethane	"	ND	----	1.00	"	"	"	"	"	Chr	
1,3-Dichloropropane	"	ND	----	1.00	"	"	"	"	"	Chr	
1,2-Dibromoethane	"	ND	----	1.00	"	"	"	"	"	Chr	
2-Hexanone	"	ND	----	10.0	"	"	"	"	"	Chr	

TestAmerica Anchorage



Troy J. Engstrom, Lab Director

The results in this report apply to the samples analyzed in accordance with the chain of custody document. This analytical report must be reproduced in its entirety.



Oasis Environmental, Inc.	Project Name: Coastal Drilling	
825 W 8th Ave, ste 200	Project Number: 14-138	Report Created:
Anchorage, AK/USA 99501-4427	Project Manager: Nino Muniz	10/02/08 10:19

Volatile Organic Compounds by EPA Method 8260B
 TestAmerica Spokane

Analyte	Method	Result	MDL*	MRL	Units	Dil	Batch	Prepared	Analyzed	Analyst	Notes
ARI0068-03 (GW-2)		Water									
		Sampled: 09/16/08 08:50									
Ethylbenzene	EPA 8260B	ND	----	1.00	ug/l	1x	8090178	09/24/08 08:23	09/24/08 15:54		Chr
Chlorobenzene	"	ND	----	1.00	"	"	"	"	"		Chr
1,1,1,2-Tetrachloroethane	"	ND	----	1.00	"	"	"	"	"		Chr
m,p-Xylene	"	ND	----	2.00	"	"	"	"	"		Chr
o-Xylene	"	ND	----	1.00	"	"	"	"	"		Chr
Styrene	"	ND	----	1.00	"	"	"	"	"		Chr
Bromoform	"	ND	----	1.00	"	"	"	"	"		Chr
Isopropylbenzene	"	ND	----	1.00	"	"	"	"	"		Chr
n-Propylbenzene	"	ND	----	1.00	"	"	"	"	"		Chr
1,1,2,2-Tetrachloroethane	"	ND	----	1.00	"	"	"	"	"		Chr
Bromobenzene	"	ND	----	1.00	"	"	"	"	"		Chr
1,3,5-Trimethylbenzene	"	ND	----	1.00	"	"	"	"	"		Chr
2-Chlorotoluene	"	ND	----	1.00	"	"	"	"	"		Chr
1,2,3-Trichloropropane	"	ND	----	1.00	"	"	"	"	"		Chr
4-Chlorotoluene	"	ND	----	1.00	"	"	"	"	"		Chr
tert-Butylbenzene	"	ND	----	1.00	"	"	"	"	"		Chr
1,2,4-Trimethylbenzene	"	ND	----	1.00	"	"	"	"	"		Chr
sec-Butylbenzene	"	ND	----	1.00	"	"	"	"	"		Chr
p-Isopropyltoluene	"	ND	----	1.00	"	"	"	"	"		Chr
1,3-Dichlorobenzene	"	ND	----	1.00	"	"	"	"	"		Chr
1,4-Dichlorobenzene	"	ND	----	1.00	"	"	"	"	"		Chr
n-Butylbenzene	"	ND	----	1.00	"	"	"	"	"		Chr
1,2-Dichlorobenzene	"	ND	----	1.00	"	"	"	"	"		Chr
1,2-Dibromo-3-chloropropane	"	ND	----	5.00	"	"	"	"	"		Chr
Hexachlorobutadiene	"	ND	----	1.00	"	"	"	"	"		Chr
1,2,4-Trichlorobenzene	"	ND	----	1.00	"	"	"	"	"		Chr
Naphthalene	"	ND	----	2.00	"	"	"	"	"		Chr
1,2,3-Trichlorobenzene	"	ND	----	1.00	"	"	"	"	"		Chr
<i>Surrogate(s):</i>	<i>Dibromofluoromethane</i>			<i>106%</i>			<i>62.2 - 128 %</i>	<i>"</i>			<i>"</i>
	<i>Toluene-d8</i>			<i>86.8%</i>			<i>75.4 - 120 %</i>	<i>"</i>			<i>"</i>
	<i>4-bromofluorobenzene</i>			<i>85.2%</i>			<i>77.3 - 129 %</i>	<i>"</i>			<i>"</i>

TestAmerica Anchorage



Troy J. Engstrom, Lab Director

The results in this report apply to the samples analyzed in accordance with the chain of custody document. This analytical report must be reproduced in its entirety.



Oasis Environmental, Inc.	Project Name: Coastal Drilling	
825 W 8th Ave, ste 200	Project Number: 14-138	Report Created:
Anchorage, AK/USA 99501-4427	Project Manager: Nino Muniz	10/02/08 10:19

Volatile Organic Compounds by EPA Method 8260B
 TestAmerica Spokane

Analyte	Method	Result	MDL*	MRL	Units	Dil	Batch	Prepared	Analyzed	Analyst	Notes
ARI0068-04 (GW-3)		Water									
		Sampled: 09/15/08 18:00									
Dichlorodifluoromethane	EPA 8260B	ND	----	1.00	ug/l	1x	8090178	09/24/08 08:23	09/24/08 16:23	Chr	
Chloromethane	"	ND	----	5.00	"	"	"	"	"	Chr	
Vinyl chloride	"	ND	----	0.200	"	"	"	"	"	Chr	
Bromomethane	"	ND	----	5.00	"	"	"	"	"	Chr	
Chloroethane	"	ND	----	1.00	"	"	"	"	"	Chr	
Trichlorofluoromethane	"	ND	----	1.00	"	"	"	"	"	Chr	
1,1-Dichloroethene	"	ND	----	1.00	"	"	"	"	"	Chr	
Carbon disulfide	"	ND	----	1.00	"	"	"	"	"	Chr	
Methylene chloride	"	ND	----	10.0	"	"	"	"	"	Chr	
Acetone	"	ND	----	25.0	"	"	"	"	"	Chr	
trans-1,2-Dichloroethene	"	ND	----	1.00	"	"	"	"	"	Chr	
Methyl tert-butyl ether	"	ND	----	1.00	"	"	"	"	"	Chr	
1,1-Dichloroethane	"	ND	----	1.00	"	"	"	"	"	Chr	
cis-1,2-Dichloroethene	"	ND	----	1.00	"	"	"	"	"	Chr	
2,2-Dichloropropane	"	ND	----	1.00	"	"	"	"	"	Chr	
Bromochloromethane	"	ND	----	1.00	"	"	"	"	"	Chr	
Chloroform	"	ND	----	1.00	"	"	"	"	"	Chr	
Carbon tetrachloride	"	ND	----	1.00	"	"	"	"	"	Chr	
1,1,1-Trichloroethane	"	ND	----	1.00	"	"	"	"	"	Chr	
2-Butanone	"	ND	----	10.0	"	"	"	"	"	Chr	
1,1-Dichloropropene	"	ND	----	1.00	"	"	"	"	"	Chr	
Benzene	"	ND	----	0.200	"	"	"	"	"	Chr	
1,2-Dichloroethane (EDC)	"	ND	----	1.00	"	"	"	"	"	Chr	
Trichloroethene	"	ND	----	1.00	"	"	"	"	"	Chr	
Dibromomethane	"	ND	----	1.00	"	"	"	"	"	Chr	
1,2-Dichloropropane	"	ND	----	1.00	"	"	"	"	"	Chr	
Bromodichloromethane	"	ND	----	1.00	"	"	"	"	"	Chr	
cis-1,3-Dichloropropene	"	ND	----	1.00	"	"	"	"	"	Chr	
Toluene	"	ND	----	1.00	"	"	"	"	"	Chr	
4-Methyl-2-pentanone	"	ND	----	10.0	"	"	"	"	"	Chr	
trans-1,3-Dichloropropene	"	ND	----	1.00	"	"	"	"	"	Chr	
Tetrachloroethene	"	ND	----	1.00	"	"	"	"	"	Chr	
1,1,2-Trichloroethane	"	ND	----	1.00	"	"	"	"	"	Chr	
Dibromochloromethane	"	ND	----	1.00	"	"	"	"	"	Chr	
1,3-Dichloropropane	"	ND	----	1.00	"	"	"	"	"	Chr	
1,2-Dibromoethane	"	ND	----	1.00	"	"	"	"	"	Chr	
2-Hexanone	"	ND	----	10.0	"	"	"	"	"	Chr	

TestAmerica Anchorage

The results in this report apply to the samples analyzed in accordance with the chain of custody document. This analytical report must be reproduced in its entirety.



Troy J. Engstrom, Lab Director



Oasis Environmental, Inc.	Project Name: Coastal Drilling	
825 W 8th Ave, ste 200	Project Number: 14-138	Report Created:
Anchorage, AK/USA 99501-4427	Project Manager: Nino Muniz	10/02/08 10:19

Volatile Organic Compounds by EPA Method 8260B
 TestAmerica Spokane

Analyte	Method	Result	MDL*	MRL	Units	Dil	Batch	Prepared	Analyzed	Analyst	Notes
ARI0068-04 (GW-3)		Water									
		Sampled: 09/15/08 18:00									
Ethylbenzene	EPA 8260B	ND	----	1.00	ug/l	1x	8090178	09/24/08 08:23	09/24/08 16:23		Chr
Chlorobenzene	"	ND	----	1.00	"	"	"	"	"		Chr
1,1,1,2-Tetrachloroethane	"	ND	----	1.00	"	"	"	"	"		Chr
m,p-Xylene	"	ND	----	2.00	"	"	"	"	"		Chr
o-Xylene	"	ND	----	1.00	"	"	"	"	"		Chr
Styrene	"	ND	----	1.00	"	"	"	"	"		Chr
Bromoform	"	ND	----	1.00	"	"	"	"	"		Chr
Isopropylbenzene	"	ND	----	1.00	"	"	"	"	"		Chr
n-Propylbenzene	"	ND	----	1.00	"	"	"	"	"		Chr
1,1,2,2-Tetrachloroethane	"	ND	----	1.00	"	"	"	"	"		Chr
Bromobenzene	"	ND	----	1.00	"	"	"	"	"		Chr
1,3,5-Trimethylbenzene	"	ND	----	1.00	"	"	"	"	"		Chr
2-Chlorotoluene	"	ND	----	1.00	"	"	"	"	"		Chr
1,2,3-Trichloropropane	"	ND	----	1.00	"	"	"	"	"		Chr
4-Chlorotoluene	"	ND	----	1.00	"	"	"	"	"		Chr
tert-Butylbenzene	"	ND	----	1.00	"	"	"	"	"		Chr
1,2,4-Trimethylbenzene	"	ND	----	1.00	"	"	"	"	"		Chr
sec-Butylbenzene	"	ND	----	1.00	"	"	"	"	"		Chr
p-Isopropyltoluene	"	ND	----	1.00	"	"	"	"	"		Chr
1,3-Dichlorobenzene	"	ND	----	1.00	"	"	"	"	"		Chr
1,4-Dichlorobenzene	"	ND	----	1.00	"	"	"	"	"		Chr
n-Butylbenzene	"	ND	----	1.00	"	"	"	"	"		Chr
1,2-Dichlorobenzene	"	ND	----	1.00	"	"	"	"	"		Chr
1,2-Dibromo-3-chloropropane	"	ND	----	5.00	"	"	"	"	"		Chr
Hexachlorobutadiene	"	ND	----	1.00	"	"	"	"	"		Chr
1,2,4-Trichlorobenzene	"	ND	----	1.00	"	"	"	"	"		Chr
Naphthalene	"	ND	----	2.00	"	"	"	"	"		Chr
1,2,3-Trichlorobenzene	"	ND	----	1.00	"	"	"	"	"		Chr
<i>Surrogate(s):</i>	<i>Dibromofluoromethane</i>			<i>104%</i>			<i>62.2 - 128 %</i>	<i>"</i>			<i>"</i>
	<i>Toluene-d8</i>			<i>86.4%</i>			<i>75.4 - 120 %</i>	<i>"</i>			<i>"</i>
	<i>4-bromofluorobenzene</i>			<i>83.0%</i>			<i>77.3 - 129 %</i>	<i>"</i>			<i>"</i>

TestAmerica Anchorage



Troy J. Engstrom, Lab Director

The results in this report apply to the samples analyzed in accordance with the chain of custody document. This analytical report must be reproduced in its entirety.



Oasis Environmental, Inc.

825 W 8th Ave, ste 200
 Anchorage, AK/USA 99501-4427

Project Name: **Coastal Drilling**

Project Number: 14-138

Project Manager: Nino Muniz

Report Created:

10/02/08 10:19

Volatile Organic Compounds by EPA Method 8260B
 TestAmerica Spokane

Analyte	Method	Result	MDL*	MRL	Units	Dil	Batch	Prepared	Analyzed	Analyst	Notes
ARI0068-05 (GW-4)		Water			Sampled: 09/15/08 17:00						
Dichlorodifluoromethane	EPA 8260B	ND	----	1.00	ug/l	1x	8090178	09/24/08 08:23	09/24/08 16:52	Chr	
Chloromethane	"	ND	----	5.00	"	"	"	"	"	Chr	
Vinyl chloride	"	ND	----	0.200	"	"	"	"	"	Chr	
Bromomethane	"	ND	----	5.00	"	"	"	"	"	Chr	
Chloroethane	"	ND	----	1.00	"	"	"	"	"	Chr	
Trichlorofluoromethane	"	ND	----	1.00	"	"	"	"	"	Chr	
1,1-Dichloroethene	"	ND	----	1.00	"	"	"	"	"	Chr	
Carbon disulfide	"	ND	----	1.00	"	"	"	"	"	Chr	
Methylene chloride	"	ND	----	10.0	"	"	"	"	"	Chr	
Acetone	"	ND	----	25.0	"	"	"	"	"	Chr	
trans-1,2-Dichloroethene	"	ND	----	1.00	"	"	"	"	"	Chr	
Methyl tert-butyl ether	"	ND	----	1.00	"	"	"	"	"	Chr	
1,1-Dichloroethane	"	ND	----	1.00	"	"	"	"	"	Chr	
cis-1,2-Dichloroethene	"	ND	----	1.00	"	"	"	"	"	Chr	
2,2-Dichloropropane	"	ND	----	1.00	"	"	"	"	"	Chr	
Bromochloromethane	"	ND	----	1.00	"	"	"	"	"	Chr	
Chloroform	"	ND	----	1.00	"	"	"	"	"	Chr	
Carbon tetrachloride	"	ND	----	1.00	"	"	"	"	"	Chr	
1,1,1-Trichloroethane	"	ND	----	1.00	"	"	"	"	"	Chr	
2-Butanone	"	ND	----	10.0	"	"	"	"	"	Chr	
1,1-Dichloropropene	"	ND	----	1.00	"	"	"	"	"	Chr	
Benzene	"	ND	----	0.200	"	"	"	"	"	Chr	
1,2-Dichloroethane (EDC)	"	ND	----	1.00	"	"	"	"	"	Chr	
Trichloroethene	"	ND	----	1.00	"	"	"	"	"	Chr	
Dibromomethane	"	ND	----	1.00	"	"	"	"	"	Chr	
1,2-Dichloropropane	"	ND	----	1.00	"	"	"	"	"	Chr	
Bromodichloromethane	"	ND	----	1.00	"	"	"	"	"	Chr	
cis-1,3-Dichloropropene	"	ND	----	1.00	"	"	"	"	"	Chr	
Toluene	"	ND	----	1.00	"	"	"	"	"	Chr	
4-Methyl-2-pentanone	"	ND	----	10.0	"	"	"	"	"	Chr	
trans-1,3-Dichloropropene	"	ND	----	1.00	"	"	"	"	"	Chr	
Tetrachloroethene	"	ND	----	1.00	"	"	"	"	"	Chr	
1,1,2-Trichloroethane	"	ND	----	1.00	"	"	"	"	"	Chr	
Dibromochloromethane	"	ND	----	1.00	"	"	"	"	"	Chr	
1,3-Dichloropropane	"	ND	----	1.00	"	"	"	"	"	Chr	
1,2-Dibromoethane	"	ND	----	1.00	"	"	"	"	"	Chr	
2-Hexanone	"	ND	----	10.0	"	"	"	"	"	Chr	

TestAmerica Anchorage

The results in this report apply to the samples analyzed in accordance with the chain of custody document. This analytical report must be reproduced in its entirety.



Troy J. Engstrom, Lab Director



Oasis Environmental, Inc.	Project Name: Coastal Drilling	
825 W 8th Ave, ste 200	Project Number: 14-138	Report Created:
Anchorage, AK/USA 99501-4427	Project Manager: Nino Muniz	10/02/08 10:19

Volatile Organic Compounds by EPA Method 8260B
 TestAmerica Spokane

Analyte	Method	Result	MDL*	MRL	Units	Dil	Batch	Prepared	Analyzed	Analyst	Notes
ARI0068-05 (GW-4)		Water									
		Sampled: 09/15/08 17:00									
Ethylbenzene	EPA 8260B	ND	----	1.00	ug/l	1x	8090178	09/24/08 08:23	09/24/08 16:52		Chr
Chlorobenzene	"	ND	----	1.00	"	"	"	"	"		Chr
1,1,1,2-Tetrachloroethane	"	ND	----	1.00	"	"	"	"	"		Chr
m,p-Xylene	"	ND	----	2.00	"	"	"	"	"		Chr
o-Xylene	"	ND	----	1.00	"	"	"	"	"		Chr
Styrene	"	ND	----	1.00	"	"	"	"	"		Chr
Bromoform	"	ND	----	1.00	"	"	"	"	"		Chr
Isopropylbenzene	"	ND	----	1.00	"	"	"	"	"		Chr
n-Propylbenzene	"	ND	----	1.00	"	"	"	"	"		Chr
1,1,2,2-Tetrachloroethane	"	ND	----	1.00	"	"	"	"	"		Chr
Bromobenzene	"	ND	----	1.00	"	"	"	"	"		Chr
1,3,5-Trimethylbenzene	"	ND	----	1.00	"	"	"	"	"		Chr
2-Chlorotoluene	"	ND	----	1.00	"	"	"	"	"		Chr
1,2,3-Trichloropropane	"	ND	----	1.00	"	"	"	"	"		Chr
4-Chlorotoluene	"	ND	----	1.00	"	"	"	"	"		Chr
tert-Butylbenzene	"	ND	----	1.00	"	"	"	"	"		Chr
1,2,4-Trimethylbenzene	"	ND	----	1.00	"	"	"	"	"		Chr
sec-Butylbenzene	"	ND	----	1.00	"	"	"	"	"		Chr
p-Isopropyltoluene	"	ND	----	1.00	"	"	"	"	"		Chr
1,3-Dichlorobenzene	"	ND	----	1.00	"	"	"	"	"		Chr
1,4-Dichlorobenzene	"	ND	----	1.00	"	"	"	"	"		Chr
n-Butylbenzene	"	ND	----	1.00	"	"	"	"	"		Chr
1,2-Dichlorobenzene	"	ND	----	1.00	"	"	"	"	"		Chr
1,2-Dibromo-3-chloropropane	"	ND	----	5.00	"	"	"	"	"		Chr
Hexachlorobutadiene	"	ND	----	1.00	"	"	"	"	"		Chr
1,2,4-Trichlorobenzene	"	ND	----	1.00	"	"	"	"	"		Chr
Naphthalene	"	ND	----	2.00	"	"	"	"	"		Chr
1,2,3-Trichlorobenzene	"	ND	----	1.00	"	"	"	"	"		Chr
<i>Surrogate(s):</i>	<i>Dibromofluoromethane</i>			<i>104%</i>			<i>62.2 - 128 %</i>	<i>"</i>			<i>"</i>
	<i>Toluene-d8</i>			<i>83.8%</i>			<i>75.4 - 120 %</i>	<i>"</i>			<i>"</i>
	<i>4-bromofluorobenzene</i>			<i>81.6%</i>			<i>77.3 - 129 %</i>	<i>"</i>			<i>"</i>

TestAmerica Anchorage



Troy J. Engstrom, Lab Director

The results in this report apply to the samples analyzed in accordance with the chain of custody document. This analytical report must be reproduced in its entirety.



Oasis Environmental, Inc.

825 W 8th Ave, ste 200
 Anchorage, AK/USA 99501-4427

Project Name: **Coastal Drilling**

Project Number: 14-138

Project Manager: Nino Muniz

Report Created:

10/02/08 10:19

Volatile Organic Compounds by EPA Method 8260B
 TestAmerica Spokane

Analyte	Method	Result	MDL*	MRL	Units	Dil	Batch	Prepared	Analyzed	Analyst	Notes
ARI0068-06 (GW-5)		Water									
		Sampled: 09/15/08 16:15									
Dichlorodifluoromethane	EPA 8260B	ND	----	1.00	ug/l	1x	8090178	09/24/08 08:23	09/24/08 17:22	Chr	
Chloromethane	"	ND	----	5.00	"	"	"	"	"	Chr	
Vinyl chloride	"	ND	----	0.200	"	"	"	"	"	Chr	
Bromomethane	"	ND	----	5.00	"	"	"	"	"	Chr	
Chloroethane	"	ND	----	1.00	"	"	"	"	"	Chr	
Trichlorofluoromethane	"	ND	----	1.00	"	"	"	"	"	Chr	
1,1-Dichloroethene	"	ND	----	1.00	"	"	"	"	"	Chr	
Carbon disulfide	"	ND	----	1.00	"	"	"	"	"	Chr	
Methylene chloride	"	ND	----	10.0	"	"	"	"	"	Chr	
Acetone	"	ND	----	25.0	"	"	"	"	"	Chr	
trans-1,2-Dichloroethene	"	ND	----	1.00	"	"	"	"	"	Chr	
Methyl tert-butyl ether	"	ND	----	1.00	"	"	"	"	"	Chr	
1,1-Dichloroethane	"	ND	----	1.00	"	"	"	"	"	Chr	
cis-1,2-Dichloroethene	"	ND	----	1.00	"	"	"	"	"	Chr	
2,2-Dichloropropane	"	ND	----	1.00	"	"	"	"	"	Chr	
Bromochloromethane	"	ND	----	1.00	"	"	"	"	"	Chr	
Chloroform	"	ND	----	1.00	"	"	"	"	"	Chr	
Carbon tetrachloride	"	ND	----	1.00	"	"	"	"	"	Chr	
1,1,1-Trichloroethane	"	ND	----	1.00	"	"	"	"	"	Chr	
2-Butanone	"	ND	----	10.0	"	"	"	"	"	Chr	
1,1-Dichloropropene	"	ND	----	1.00	"	"	"	"	"	Chr	
Benzene	"	ND	----	0.200	"	"	"	"	"	Chr	
1,2-Dichloroethane (EDC)	"	ND	----	1.00	"	"	"	"	"	Chr	
Trichloroethene	"	ND	----	1.00	"	"	"	"	"	Chr	
Dibromomethane	"	ND	----	1.00	"	"	"	"	"	Chr	
1,2-Dichloropropane	"	ND	----	1.00	"	"	"	"	"	Chr	
Bromodichloromethane	"	ND	----	1.00	"	"	"	"	"	Chr	
cis-1,3-Dichloropropene	"	ND	----	1.00	"	"	"	"	"	Chr	
Toluene	"	ND	----	1.00	"	"	"	"	"	Chr	
4-Methyl-2-pentanone	"	ND	----	10.0	"	"	"	"	"	Chr	
trans-1,3-Dichloropropene	"	ND	----	1.00	"	"	"	"	"	Chr	
Tetrachloroethene	"	ND	----	1.00	"	"	"	"	"	Chr	
1,1,2-Trichloroethane	"	ND	----	1.00	"	"	"	"	"	Chr	
Dibromochloromethane	"	ND	----	1.00	"	"	"	"	"	Chr	
1,3-Dichloropropane	"	ND	----	1.00	"	"	"	"	"	Chr	
1,2-Dibromoethane	"	ND	----	1.00	"	"	"	"	"	Chr	
2-Hexanone	"	ND	----	10.0	"	"	"	"	"	Chr	

TestAmerica Anchorage



Troy J. Engstrom, Lab Director

The results in this report apply to the samples analyzed in accordance with the chain of custody document. This analytical report must be reproduced in its entirety.



Oasis Environmental, Inc.

825 W 8th Ave, ste 200
 Anchorage, AK/USA 99501-4427

Project Name: **Coastal Drilling**

Project Number: 14-138

Project Manager: Nino Muniz

Report Created:

10/02/08 10:19

Volatile Organic Compounds by EPA Method 8260B
 TestAmerica Spokane

Analyte	Method	Result	MDL*	MRL	Units	Dil	Batch	Prepared	Analyzed	Analyst	Notes
ARI0068-06 (GW-5)		Water			Sampled: 09/15/08 16:15						
Ethylbenzene	EPA 8260B	ND	----	1.00	ug/l	1x	8090178	09/24/08 08:23	09/24/08 17:22	Chr	
Chlorobenzene	"	ND	----	1.00	"	"	"	"	"	Chr	
1,1,1,2-Tetrachloroethane	"	ND	----	1.00	"	"	"	"	"	Chr	
m,p-Xylene	"	ND	----	2.00	"	"	"	"	"	Chr	
o-Xylene	"	ND	----	1.00	"	"	"	"	"	Chr	
Styrene	"	ND	----	1.00	"	"	"	"	"	Chr	
Bromoform	"	ND	----	1.00	"	"	"	"	"	Chr	
Isopropylbenzene	"	ND	----	1.00	"	"	"	"	"	Chr	
n-Propylbenzene	"	ND	----	1.00	"	"	"	"	"	Chr	
1,1,2,2-Tetrachloroethane	"	ND	----	1.00	"	"	"	"	"	Chr	
Bromobenzene	"	ND	----	1.00	"	"	"	"	"	Chr	
1,3,5-Trimethylbenzene	"	ND	----	1.00	"	"	"	"	"	Chr	
2-Chlorotoluene	"	ND	----	1.00	"	"	"	"	"	Chr	
1,2,3-Trichloropropane	"	ND	----	1.00	"	"	"	"	"	Chr	
4-Chlorotoluene	"	ND	----	1.00	"	"	"	"	"	Chr	
tert-Butylbenzene	"	ND	----	1.00	"	"	"	"	"	Chr	
1,2,4-Trimethylbenzene	"	ND	----	1.00	"	"	"	"	"	Chr	
sec-Butylbenzene	"	ND	----	1.00	"	"	"	"	"	Chr	
p-Isopropyltoluene	"	ND	----	1.00	"	"	"	"	"	Chr	
1,3-Dichlorobenzene	"	ND	----	1.00	"	"	"	"	"	Chr	
1,4-Dichlorobenzene	"	ND	----	1.00	"	"	"	"	"	Chr	
n-Butylbenzene	"	ND	----	1.00	"	"	"	"	"	Chr	
1,2-Dichlorobenzene	"	ND	----	1.00	"	"	"	"	"	Chr	
1,2-Dibromo-3-chloropropane	"	ND	----	5.00	"	"	"	"	"	Chr	
Hexachlorobutadiene	"	ND	----	1.00	"	"	"	"	"	Chr	
1,2,4-Trichlorobenzene	"	ND	----	1.00	"	"	"	"	"	Chr	
Naphthalene	"	ND	----	2.00	"	"	"	"	"	Chr	
1,2,3-Trichlorobenzene	"	ND	----	1.00	"	"	"	"	"	Chr	
<i>Surrogate(s):</i>	<i>Dibromofluoromethane</i>			<i>105%</i>			<i>62.2 - 128 %</i>	<i>"</i>		<i>"</i>	
	<i>Toluene-d8</i>			<i>85.8%</i>			<i>75.4 - 120 %</i>	<i>"</i>		<i>"</i>	
	<i>4-bromofluorobenzene</i>			<i>80.2%</i>			<i>77.3 - 129 %</i>	<i>"</i>		<i>"</i>	

TestAmerica Anchorage



Troy J. Engstrom, Lab Director

The results in this report apply to the samples analyzed in accordance with the chain of custody document. This analytical report must be reproduced in its entirety.



Oasis Environmental, Inc.	Project Name: Coastal Drilling	
825 W 8th Ave, ste 200	Project Number: 14-138	Report Created:
Anchorage, AK/USA 99501-4427	Project Manager: Nino Muniz	10/02/08 10:19

Volatile Organic Compounds by EPA Method 8260B
 TestAmerica Spokane

Analyte	Method	Result	MDL*	MRL	Units	Dil	Batch	Prepared	Analyzed	Analyst	Notes
ARI0068-07 (GW-6)		Water									
		Sampled: 09/15/08 14:45									
Dichlorodifluoromethane	EPA 8260B	ND	----	1.00	ug/l	1x	8090178	09/24/08 08:23	09/24/08 17:51	Chr	
Chloromethane	"	ND	----	5.00	"	"	"	"	"	Chr	
Vinyl chloride	"	ND	----	0.200	"	"	"	"	"	Chr	
Bromomethane	"	ND	----	5.00	"	"	"	"	"	Chr	
Chloroethane	"	ND	----	1.00	"	"	"	"	"	Chr	
Trichlorofluoromethane	"	ND	----	1.00	"	"	"	"	"	Chr	
1,1-Dichloroethene	"	ND	----	1.00	"	"	"	"	"	Chr	
Carbon disulfide	"	ND	----	1.00	"	"	"	"	"	Chr	
Methylene chloride	"	ND	----	10.0	"	"	"	"	"	Chr	
Acetone	"	ND	----	25.0	"	"	"	"	"	Chr	
trans-1,2-Dichloroethene	"	ND	----	1.00	"	"	"	"	"	Chr	
Methyl tert-butyl ether	"	ND	----	1.00	"	"	"	"	"	Chr	
1,1-Dichloroethane	"	ND	----	1.00	"	"	"	"	"	Chr	
cis-1,2-Dichloroethene	"	ND	----	1.00	"	"	"	"	"	Chr	
2,2-Dichloropropane	"	ND	----	1.00	"	"	"	"	"	Chr	
Bromochloromethane	"	ND	----	1.00	"	"	"	"	"	Chr	
Chloroform	"	ND	----	1.00	"	"	"	"	"	Chr	
Carbon tetrachloride	"	ND	----	1.00	"	"	"	"	"	Chr	
1,1,1-Trichloroethane	"	ND	----	1.00	"	"	"	"	"	Chr	
2-Butanone	"	ND	----	10.0	"	"	"	"	"	Chr	
1,1-Dichloropropene	"	ND	----	1.00	"	"	"	"	"	Chr	
Benzene	"	ND	----	0.200	"	"	"	"	"	Chr	
1,2-Dichloroethane (EDC)	"	ND	----	1.00	"	"	"	"	"	Chr	
Trichloroethene	"	ND	----	1.00	"	"	"	"	"	Chr	
Dibromomethane	"	ND	----	1.00	"	"	"	"	"	Chr	
1,2-Dichloropropane	"	ND	----	1.00	"	"	"	"	"	Chr	
Bromodichloromethane	"	ND	----	1.00	"	"	"	"	"	Chr	
cis-1,3-Dichloropropene	"	ND	----	1.00	"	"	"	"	"	Chr	
Toluene	"	ND	----	1.00	"	"	"	"	"	Chr	
4-Methyl-2-pentanone	"	ND	----	10.0	"	"	"	"	"	Chr	
trans-1,3-Dichloropropene	"	ND	----	1.00	"	"	"	"	"	Chr	
Tetrachloroethene	"	ND	----	1.00	"	"	"	"	"	Chr	
1,1,2-Trichloroethane	"	ND	----	1.00	"	"	"	"	"	Chr	
Dibromochloromethane	"	ND	----	1.00	"	"	"	"	"	Chr	
1,3-Dichloropropane	"	ND	----	1.00	"	"	"	"	"	Chr	
1,2-Dibromoethane	"	ND	----	1.00	"	"	"	"	"	Chr	
2-Hexanone	"	ND	----	10.0	"	"	"	"	"	Chr	

TestAmerica Anchorage

The results in this report apply to the samples analyzed in accordance with the chain of custody document. This analytical report must be reproduced in its entirety.



Troy J. Engstrom, Lab Director



Oasis Environmental, Inc.

825 W 8th Ave, ste 200
 Anchorage, AK/USA 99501-4427

Project Name: **Coastal Drilling**

Project Number: 14-138

Project Manager: Nino Muniz

Report Created:

10/02/08 10:19

Volatile Organic Compounds by EPA Method 8260B
 TestAmerica Spokane

Analyte	Method	Result	MDL*	MRL	Units	Dil	Batch	Prepared	Analyzed	Analyst	Notes
ARI0068-07 (GW-6)		Water			Sampled: 09/15/08 14:45						
Ethylbenzene	EPA 8260B	ND	----	1.00	ug/l	1x	8090178	09/24/08 08:23	09/24/08 17:51		Chr
Chlorobenzene	"	ND	----	1.00	"	"	"	"	"		Chr
1,1,1,2-Tetrachloroethane	"	ND	----	1.00	"	"	"	"	"		Chr
m,p-Xylene	"	ND	----	2.00	"	"	"	"	"		Chr
o-Xylene	"	ND	----	1.00	"	"	"	"	"		Chr
Styrene	"	ND	----	1.00	"	"	"	"	"		Chr
Bromoform	"	ND	----	1.00	"	"	"	"	"		Chr
Isopropylbenzene	"	ND	----	1.00	"	"	"	"	"		Chr
n-Propylbenzene	"	ND	----	1.00	"	"	"	"	"		Chr
1,1,2,2-Tetrachloroethane	"	ND	----	1.00	"	"	"	"	"		Chr
Bromobenzene	"	ND	----	1.00	"	"	"	"	"		Chr
1,3,5-Trimethylbenzene	"	ND	----	1.00	"	"	"	"	"		Chr
2-Chlorotoluene	"	ND	----	1.00	"	"	"	"	"		Chr
1,2,3-Trichloropropane	"	ND	----	1.00	"	"	"	"	"		Chr
4-Chlorotoluene	"	ND	----	1.00	"	"	"	"	"		Chr
tert-Butylbenzene	"	ND	----	1.00	"	"	"	"	"		Chr
1,2,4-Trimethylbenzene	"	ND	----	1.00	"	"	"	"	"		Chr
sec-Butylbenzene	"	ND	----	1.00	"	"	"	"	"		Chr
p-Isopropyltoluene	"	ND	----	1.00	"	"	"	"	"		Chr
1,3-Dichlorobenzene	"	ND	----	1.00	"	"	"	"	"		Chr
1,4-Dichlorobenzene	"	ND	----	1.00	"	"	"	"	"		Chr
n-Butylbenzene	"	ND	----	1.00	"	"	"	"	"		Chr
1,2-Dichlorobenzene	"	ND	----	1.00	"	"	"	"	"		Chr
1,2-Dibromo-3-chloropropane	"	ND	----	5.00	"	"	"	"	"		Chr
Hexachlorobutadiene	"	ND	----	1.00	"	"	"	"	"		Chr
1,2,4-Trichlorobenzene	"	ND	----	1.00	"	"	"	"	"		Chr
Naphthalene	"	ND	----	2.00	"	"	"	"	"		Chr
1,2,3-Trichlorobenzene	"	ND	----	1.00	"	"	"	"	"		Chr
<i>Surrogate(s):</i>	<i>Dibromofluoromethane</i>			<i>104%</i>			<i>62.2 - 128 %</i>	<i>"</i>			<i>"</i>
	<i>Toluene-d8</i>			<i>84.0%</i>			<i>75.4 - 120 %</i>	<i>"</i>			<i>"</i>
	<i>4-bromofluorobenzene</i>			<i>79.4%</i>			<i>77.3 - 129 %</i>	<i>"</i>			<i>"</i>

TestAmerica Anchorage



Troy J. Engstrom, Lab Director

The results in this report apply to the samples analyzed in accordance with the chain of custody document. This analytical report must be reproduced in its entirety.



Oasis Environmental, Inc.	Project Name: Coastal Drilling	
825 W 8th Ave, ste 200	Project Number: 14-138	Report Created:
Anchorage, AK/USA 99501-4427	Project Manager: Nino Muniz	10/02/08 10:19

Volatile Organic Compounds by EPA Method 8260B
 TestAmerica Spokane

Analyte	Method	Result	MDL*	MRL	Units	Dil	Batch	Prepared	Analyzed	Analyst	Notes
ARI0068-08 (GW-7)		Water									
		Sampled: 09/16/08 10:20									
Dichlorodifluoromethane	EPA 8260B	ND	----	1.00	ug/l	1x	8090178	09/24/08 08:23	09/24/08 18:21	Chr	
Chloromethane	"	ND	----	5.00	"	"	"	"	"	Chr	
Vinyl chloride	"	ND	----	0.200	"	"	"	"	"	Chr	
Bromomethane	"	ND	----	5.00	"	"	"	"	"	Chr	
Chloroethane	"	ND	----	1.00	"	"	"	"	"	Chr	
Trichlorofluoromethane	"	ND	----	1.00	"	"	"	"	"	Chr	
1,1-Dichloroethene	"	ND	----	1.00	"	"	"	"	"	Chr	
Carbon disulfide	"	ND	----	1.00	"	"	"	"	"	Chr	
Methylene chloride	"	ND	----	10.0	"	"	"	"	"	Chr	
Acetone	"	ND	----	25.0	"	"	"	"	"	Chr	
trans-1,2-Dichloroethene	"	ND	----	1.00	"	"	"	"	"	Chr	
Methyl tert-butyl ether	"	ND	----	1.00	"	"	"	"	"	Chr	
1,1-Dichloroethane	"	ND	----	1.00	"	"	"	"	"	Chr	
cis-1,2-Dichloroethene	"	ND	----	1.00	"	"	"	"	"	Chr	
2,2-Dichloropropane	"	ND	----	1.00	"	"	"	"	"	Chr	
Bromochloromethane	"	ND	----	1.00	"	"	"	"	"	Chr	
Chloroform	"	ND	----	1.00	"	"	"	"	"	Chr	
Carbon tetrachloride	"	ND	----	1.00	"	"	"	"	"	Chr	
1,1,1-Trichloroethane	"	ND	----	1.00	"	"	"	"	"	Chr	
2-Butanone	"	ND	----	10.0	"	"	"	"	"	Chr	
1,1-Dichloropropene	"	ND	----	1.00	"	"	"	"	"	Chr	
Benzene	"	ND	----	0.200	"	"	"	"	"	Chr	
1,2-Dichloroethane (EDC)	"	ND	----	1.00	"	"	"	"	"	Chr	
Trichloroethene	"	ND	----	1.00	"	"	"	"	"	Chr	
Dibromomethane	"	ND	----	1.00	"	"	"	"	"	Chr	
1,2-Dichloropropane	"	ND	----	1.00	"	"	"	"	"	Chr	
Bromodichloromethane	"	ND	----	1.00	"	"	"	"	"	Chr	
cis-1,3-Dichloropropene	"	ND	----	1.00	"	"	"	"	"	Chr	
Toluene	"	ND	----	1.00	"	"	"	"	"	Chr	
4-Methyl-2-pentanone	"	ND	----	10.0	"	"	"	"	"	Chr	
trans-1,3-Dichloropropene	"	ND	----	1.00	"	"	"	"	"	Chr	
Tetrachloroethene	"	ND	----	1.00	"	"	"	"	"	Chr	
1,1,2-Trichloroethane	"	ND	----	1.00	"	"	"	"	"	Chr	
Dibromochloromethane	"	ND	----	1.00	"	"	"	"	"	Chr	
1,3-Dichloropropane	"	ND	----	1.00	"	"	"	"	"	Chr	
1,2-Dibromoethane	"	ND	----	1.00	"	"	"	"	"	Chr	
2-Hexanone	"	ND	----	10.0	"	"	"	"	"	Chr	

TestAmerica Anchorage

The results in this report apply to the samples analyzed in accordance with the chain of custody document. This analytical report must be reproduced in its entirety.

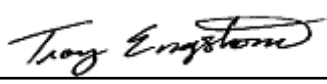

Troy J. Engstrom, Lab Director



Oasis Environmental, Inc.	Project Name: Coastal Drilling	
825 W 8th Ave, ste 200	Project Number: 14-138	Report Created:
Anchorage, AK/USA 99501-4427	Project Manager: Nino Muniz	10/02/08 10:19

Volatile Organic Compounds by EPA Method 8260B
 TestAmerica Spokane

Analyte	Method	Result	MDL*	MRL	Units	Dil	Batch	Prepared	Analyzed	Analyst	Notes
ARI0068-08 (GW-7)		Water									
		Sampled: 09/16/08 10:20									
Ethylbenzene	EPA 8260B	ND	----	1.00	ug/l	1x	8090178	09/24/08 08:23	09/24/08 18:21		Chr
Chlorobenzene	"	ND	----	1.00	"	"	"	"	"		Chr
1,1,1,2-Tetrachloroethane	"	ND	----	1.00	"	"	"	"	"		Chr
m,p-Xylene	"	ND	----	2.00	"	"	"	"	"		Chr
o-Xylene	"	ND	----	1.00	"	"	"	"	"		Chr
Styrene	"	ND	----	1.00	"	"	"	"	"		Chr
Bromoform	"	ND	----	1.00	"	"	"	"	"		Chr
Isopropylbenzene	"	ND	----	1.00	"	"	"	"	"		Chr
n-Propylbenzene	"	ND	----	1.00	"	"	"	"	"		Chr
1,1,2,2-Tetrachloroethane	"	ND	----	1.00	"	"	"	"	"		Chr
Bromobenzene	"	ND	----	1.00	"	"	"	"	"		Chr
1,3,5-Trimethylbenzene	"	ND	----	1.00	"	"	"	"	"		Chr
2-Chlorotoluene	"	ND	----	1.00	"	"	"	"	"		Chr
1,2,3-Trichloropropane	"	ND	----	1.00	"	"	"	"	"		Chr
4-Chlorotoluene	"	ND	----	1.00	"	"	"	"	"		Chr
tert-Butylbenzene	"	ND	----	1.00	"	"	"	"	"		Chr
1,2,4-Trimethylbenzene	"	ND	----	1.00	"	"	"	"	"		Chr
sec-Butylbenzene	"	ND	----	1.00	"	"	"	"	"		Chr
p-Isopropyltoluene	"	ND	----	1.00	"	"	"	"	"		Chr
1,3-Dichlorobenzene	"	ND	----	1.00	"	"	"	"	"		Chr
1,4-Dichlorobenzene	"	ND	----	1.00	"	"	"	"	"		Chr
n-Butylbenzene	"	ND	----	1.00	"	"	"	"	"		Chr
1,2-Dichlorobenzene	"	ND	----	1.00	"	"	"	"	"		Chr
1,2-Dibromo-3-chloropropane	"	ND	----	5.00	"	"	"	"	"		Chr
Hexachlorobutadiene	"	ND	----	1.00	"	"	"	"	"		Chr
1,2,4-Trichlorobenzene	"	ND	----	1.00	"	"	"	"	"		Chr
Naphthalene	"	ND	----	2.00	"	"	"	"	"		Chr
1,2,3-Trichlorobenzene	"	ND	----	1.00	"	"	"	"	"		Chr
<i>Surrogate(s):</i>	<i>Dibromofluoromethane</i>			<i>108%</i>			<i>62.2 - 128 %</i>	<i>"</i>			<i>"</i>
	<i>Toluene-d8</i>			<i>84.4%</i>			<i>75.4 - 120 %</i>	<i>"</i>			<i>"</i>
	<i>4-bromofluorobenzene</i>			<i>78.8%</i>			<i>77.3 - 129 %</i>	<i>"</i>			<i>"</i>

TestAmerica Anchorage



Troy J. Engstrom, Lab Director

The results in this report apply to the samples analyzed in accordance with the chain of custody document. This analytical report must be reproduced in its entirety.



Oasis Environmental, Inc.	Project Name: Coastal Drilling	
825 W 8th Ave, ste 200	Project Number: 14-138	Report Created:
Anchorage, AK/USA 99501-4427	Project Manager: Nino Muniz	10/02/08 10:19

Volatile Organic Compounds by EPA Method 8260B
 TestAmerica Spokane

Analyte	Method	Result	MDL*	MRL	Units	Dil	Batch	Prepared	Analyzed	Analyst	Notes
ARI0068-09 (Duplicate 1)		Water									
		Sampled: 09/15/08 14:00									
Dichlorodifluoromethane	EPA 8260B	ND	----	1.00	ug/l	1x	8090178	09/24/08 08:23	09/24/08 18:51	Chr	
Chloromethane	"	ND	----	5.00	"	"	"	"	"	Chr	
Vinyl chloride	"	ND	----	0.200	"	"	"	"	"	Chr	
Bromomethane	"	ND	----	5.00	"	"	"	"	"	Chr	
Chloroethane	"	ND	----	1.00	"	"	"	"	"	Chr	
Trichlorofluoromethane	"	ND	----	1.00	"	"	"	"	"	Chr	
1,1-Dichloroethene	"	ND	----	1.00	"	"	"	"	"	Chr	
Carbon disulfide	"	ND	----	1.00	"	"	"	"	"	Chr	
Methylene chloride	"	ND	----	10.0	"	"	"	"	"	Chr	
Acetone	"	ND	----	25.0	"	"	"	"	"	Chr	
trans-1,2-Dichloroethene	"	ND	----	1.00	"	"	"	"	"	Chr	
Methyl tert-butyl ether	"	ND	----	1.00	"	"	"	"	"	Chr	
1,1-Dichloroethane	"	ND	----	1.00	"	"	"	"	"	Chr	
cis-1,2-Dichloroethene	"	ND	----	1.00	"	"	"	"	"	Chr	
2,2-Dichloropropane	"	ND	----	1.00	"	"	"	"	"	Chr	
Bromochloromethane	"	ND	----	1.00	"	"	"	"	"	Chr	
Chloroform	"	ND	----	1.00	"	"	"	"	"	Chr	
Carbon tetrachloride	"	ND	----	1.00	"	"	"	"	"	Chr	
1,1,1-Trichloroethane	"	ND	----	1.00	"	"	"	"	"	Chr	
2-Butanone	"	ND	----	10.0	"	"	"	"	"	Chr	
1,1-Dichloropropene	"	ND	----	1.00	"	"	"	"	"	Chr	
Benzene	"	ND	----	0.200	"	"	"	"	"	Chr	
1,2-Dichloroethane (EDC)	"	ND	----	1.00	"	"	"	"	"	Chr	
Trichloroethene	"	ND	----	1.00	"	"	"	"	"	Chr	
Dibromomethane	"	ND	----	1.00	"	"	"	"	"	Chr	
1,2-Dichloropropane	"	ND	----	1.00	"	"	"	"	"	Chr	
Bromodichloromethane	"	ND	----	1.00	"	"	"	"	"	Chr	
cis-1,3-Dichloropropene	"	ND	----	1.00	"	"	"	"	"	Chr	
Toluene	"	ND	----	1.00	"	"	"	"	"	Chr	
4-Methyl-2-pentanone	"	ND	----	10.0	"	"	"	"	"	Chr	
trans-1,3-Dichloropropene	"	ND	----	1.00	"	"	"	"	"	Chr	
Tetrachloroethene	"	ND	----	1.00	"	"	"	"	"	Chr	
1,1,2-Trichloroethane	"	ND	----	1.00	"	"	"	"	"	Chr	
Dibromochloromethane	"	ND	----	1.00	"	"	"	"	"	Chr	
1,3-Dichloropropane	"	ND	----	1.00	"	"	"	"	"	Chr	
1,2-Dibromoethane	"	ND	----	1.00	"	"	"	"	"	Chr	
2-Hexanone	"	ND	----	10.0	"	"	"	"	"	Chr	

TestAmerica Anchorage

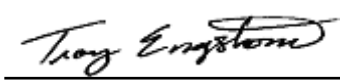

Troy J. Engstrom, Lab Director

The results in this report apply to the samples analyzed in accordance with the chain of custody document. This analytical report must be reproduced in its entirety.



Oasis Environmental, Inc.	Project Name: Coastal Drilling	
825 W 8th Ave, ste 200	Project Number: 14-138	Report Created:
Anchorage, AK/USA 99501-4427	Project Manager: Nino Muniz	10/02/08 10:19

Volatile Organic Compounds by EPA Method 8260B
 TestAmerica Spokane

Analyte	Method	Result	MDL*	MRL	Units	Dil	Batch	Prepared	Analyzed	Analyst	Notes
ARI0068-09 (Duplicate 1)		Water			Sampled: 09/15/08 14:00						
Ethylbenzene	EPA 8260B	ND	----	1.00	ug/l	1x	8090178	09/24/08 08:23	09/24/08 18:51		Chr
Chlorobenzene	"	ND	----	1.00	"	"	"	"	"		Chr
1,1,1,2-Tetrachloroethane	"	ND	----	1.00	"	"	"	"	"		Chr
m,p-Xylene	"	ND	----	2.00	"	"	"	"	"		Chr
o-Xylene	"	ND	----	1.00	"	"	"	"	"		Chr
Styrene	"	ND	----	1.00	"	"	"	"	"		Chr
Bromoform	"	ND	----	1.00	"	"	"	"	"		Chr
Isopropylbenzene	"	ND	----	1.00	"	"	"	"	"		Chr
n-Propylbenzene	"	ND	----	1.00	"	"	"	"	"		Chr
1,1,2,2-Tetrachloroethane	"	ND	----	1.00	"	"	"	"	"		Chr
Bromobenzene	"	ND	----	1.00	"	"	"	"	"		Chr
1,3,5-Trimethylbenzene	"	ND	----	1.00	"	"	"	"	"		Chr
2-Chlorotoluene	"	ND	----	1.00	"	"	"	"	"		Chr
1,2,3-Trichloropropane	"	ND	----	1.00	"	"	"	"	"		Chr
4-Chlorotoluene	"	ND	----	1.00	"	"	"	"	"		Chr
tert-Butylbenzene	"	ND	----	1.00	"	"	"	"	"		Chr
1,2,4-Trimethylbenzene	"	ND	----	1.00	"	"	"	"	"		Chr
sec-Butylbenzene	"	ND	----	1.00	"	"	"	"	"		Chr
p-Isopropyltoluene	"	ND	----	1.00	"	"	"	"	"		Chr
1,3-Dichlorobenzene	"	ND	----	1.00	"	"	"	"	"		Chr
1,4-Dichlorobenzene	"	ND	----	1.00	"	"	"	"	"		Chr
n-Butylbenzene	"	ND	----	1.00	"	"	"	"	"		Chr
1,2-Dichlorobenzene	"	ND	----	1.00	"	"	"	"	"		Chr
1,2-Dibromo-3-chloropropane	"	ND	----	5.00	"	"	"	"	"		Chr
Hexachlorobutadiene	"	ND	----	1.00	"	"	"	"	"		Chr
1,2,4-Trichlorobenzene	"	ND	----	1.00	"	"	"	"	"		Chr
Naphthalene	"	ND	----	2.00	"	"	"	"	"		Chr
1,2,3-Trichlorobenzene	"	ND	----	1.00	"	"	"	"	"		Chr
<i>Surrogate(s):</i>	<i>Dibromofluoromethane</i>			<i>120%</i>			<i>62.2 - 128 %</i>	<i>"</i>			<i>"</i>
	<i>Toluene-d8</i>			<i>83.6%</i>			<i>75.4 - 120 %</i>	<i>"</i>			<i>"</i>
	<i>4-bromofluorobenzene</i>			<i>79.2%</i>			<i>77.3 - 129 %</i>	<i>"</i>			<i>"</i>

TestAmerica Anchorage



Troy J. Engstrom, Lab Director

The results in this report apply to the samples analyzed in accordance with the chain of custody document. This analytical report must be reproduced in its entirety.



Oasis Environmental, Inc.

825 W 8th Ave, ste 200
 Anchorage, AK/USA 99501-4427

Project Name: **Coastal Drilling**

Project Number: 14-138

Project Manager: Nino Muniz

Report Created:

10/02/08 10:19

Volatile Organic Compounds by EPA Method 8260B
 TestAmerica Spokane

Analyte	Method	Result	MDL*	MRL	Units	Dil	Batch	Prepared	Analyzed	Analyst	Notes
ARI0068-10 (Trip Blank)											
		Water									
		Sampled: 09/15/08 12:00									
Dichlorodifluoromethane	EPA 8260B	ND	----	1.00	ug/l	1x	8090178	09/24/08 08:23	09/24/08 19:20	Chr	
Chloromethane	"	ND	----	5.00	"	"	"	"	"	Chr	
Vinyl chloride	"	ND	----	0.200	"	"	"	"	"	Chr	
Bromomethane	"	ND	----	5.00	"	"	"	"	"	Chr	
Chloroethane	"	ND	----	1.00	"	"	"	"	"	Chr	
Trichlorofluoromethane	"	ND	----	1.00	"	"	"	"	"	Chr	
1,1-Dichloroethene	"	ND	----	1.00	"	"	"	"	"	Chr	
Carbon disulfide	"	ND	----	1.00	"	"	"	"	"	Chr	
Methylene chloride	"	ND	----	10.0	"	"	"	"	"	Chr	
Acetone	"	ND	----	25.0	"	"	"	"	"	Chr	
trans-1,2-Dichloroethene	"	ND	----	1.00	"	"	"	"	"	Chr	
Methyl tert-butyl ether	"	ND	----	1.00	"	"	"	"	"	Chr	
1,1-Dichloroethane	"	ND	----	1.00	"	"	"	"	"	Chr	
cis-1,2-Dichloroethene	"	ND	----	1.00	"	"	"	"	"	Chr	
2,2-Dichloropropane	"	ND	----	1.00	"	"	"	"	"	Chr	
Bromochloromethane	"	ND	----	1.00	"	"	"	"	"	Chr	
Chloroform	"	ND	----	1.00	"	"	"	"	"	Chr	
Carbon tetrachloride	"	ND	----	1.00	"	"	"	"	"	Chr	
1,1,1-Trichloroethane	"	ND	----	1.00	"	"	"	"	"	Chr	
2-Butanone	"	ND	----	10.0	"	"	"	"	"	Chr	
1,1-Dichloropropene	"	ND	----	1.00	"	"	"	"	"	Chr	
Benzene	"	ND	----	0.200	"	"	"	"	"	Chr	
1,2-Dichloroethane (EDC)	"	ND	----	1.00	"	"	"	"	"	Chr	
Trichloroethene	"	ND	----	1.00	"	"	"	"	"	Chr	
Dibromomethane	"	ND	----	1.00	"	"	"	"	"	Chr	
1,2-Dichloropropane	"	ND	----	1.00	"	"	"	"	"	Chr	
Bromodichloromethane	"	ND	----	1.00	"	"	"	"	"	Chr	
cis-1,3-Dichloropropene	"	ND	----	1.00	"	"	"	"	"	Chr	
Toluene	"	ND	----	1.00	"	"	"	"	"	Chr	
4-Methyl-2-pentanone	"	ND	----	10.0	"	"	"	"	"	Chr	
trans-1,3-Dichloropropene	"	ND	----	1.00	"	"	"	"	"	Chr	
Tetrachloroethene	"	ND	----	1.00	"	"	"	"	"	Chr	
1,1,2-Trichloroethane	"	ND	----	1.00	"	"	"	"	"	Chr	
Dibromochloromethane	"	ND	----	1.00	"	"	"	"	"	Chr	
1,3-Dichloropropane	"	ND	----	1.00	"	"	"	"	"	Chr	
1,2-Dibromoethane	"	ND	----	1.00	"	"	"	"	"	Chr	
2-Hexanone	"	ND	----	10.0	"	"	"	"	"	Chr	

TestAmerica Anchorage



Troy J. Engstrom, Lab Director

The results in this report apply to the samples analyzed in accordance with the chain of custody document. This analytical report must be reproduced in its entirety.



Oasis Environmental, Inc.	Project Name: Coastal Drilling	
825 W 8th Ave, ste 200	Project Number: 14-138	Report Created:
Anchorage, AK/USA 99501-4427	Project Manager: Nino Muniz	10/02/08 10:19

Volatile Organic Compounds by EPA Method 8260B
 TestAmerica Spokane

Analyte	Method	Result	MDL*	MRL	Units	Dil	Batch	Prepared	Analyzed	Analyst	Notes
ARI0068-10 (Trip Blank)		Water									
		Sampled: 09/15/08 12:00									
Ethylbenzene	EPA 8260B	ND	----	1.00	ug/l	1x	8090178	09/24/08 08:23	09/24/08 19:20		Chr
Chlorobenzene	"	ND	----	1.00	"	"	"	"	"		Chr
1,1,1,2-Tetrachloroethane	"	ND	----	1.00	"	"	"	"	"		Chr
m,p-Xylene	"	ND	----	2.00	"	"	"	"	"		Chr
o-Xylene	"	ND	----	1.00	"	"	"	"	"		Chr
Styrene	"	ND	----	1.00	"	"	"	"	"		Chr
Bromoform	"	ND	----	1.00	"	"	"	"	"		Chr
Isopropylbenzene	"	ND	----	1.00	"	"	"	"	"		Chr
n-Propylbenzene	"	ND	----	1.00	"	"	"	"	"		Chr
1,1,2,2-Tetrachloroethane	"	ND	----	1.00	"	"	"	"	"		Chr
Bromobenzene	"	ND	----	1.00	"	"	"	"	"		Chr
1,3,5-Trimethylbenzene	"	ND	----	1.00	"	"	"	"	"		Chr
2-Chlorotoluene	"	ND	----	1.00	"	"	"	"	"		Chr
1,2,3-Trichloropropane	"	ND	----	1.00	"	"	"	"	"		Chr
4-Chlorotoluene	"	ND	----	1.00	"	"	"	"	"		Chr
tert-Butylbenzene	"	ND	----	1.00	"	"	"	"	"		Chr
1,2,4-Trimethylbenzene	"	ND	----	1.00	"	"	"	"	"		Chr
sec-Butylbenzene	"	ND	----	1.00	"	"	"	"	"		Chr
p-Isopropyltoluene	"	ND	----	1.00	"	"	"	"	"		Chr
1,3-Dichlorobenzene	"	ND	----	1.00	"	"	"	"	"		Chr
1,4-Dichlorobenzene	"	ND	----	1.00	"	"	"	"	"		Chr
n-Butylbenzene	"	ND	----	1.00	"	"	"	"	"		Chr
1,2-Dichlorobenzene	"	ND	----	1.00	"	"	"	"	"		Chr
1,2-Dibromo-3-chloropropane	"	ND	----	5.00	"	"	"	"	"		Chr
Hexachlorobutadiene	"	ND	----	1.00	"	"	"	"	"		Chr
1,2,4-Trichlorobenzene	"	ND	----	1.00	"	"	"	"	"		Chr
Naphthalene	"	ND	----	2.00	"	"	"	"	"		Chr
1,2,3-Trichlorobenzene	"	ND	----	1.00	"	"	"	"	"		Chr
<i>Surrogate(s):</i>	<i>Dibromofluoromethane</i>			<i>108%</i>			<i>62.2 - 128 %</i>	<i>"</i>			<i>"</i>
	<i>Toluene-d8</i>			<i>84.4%</i>			<i>75.4 - 120 %</i>	<i>"</i>			<i>"</i>
	<i>4-bromofluorobenzene</i>			<i>80.0%</i>			<i>77.3 - 129 %</i>	<i>"</i>			<i>"</i>

TestAmerica Anchorage



Troy J. Engstrom, Lab Director

The results in this report apply to the samples analyzed in accordance with the chain of custody document. This analytical report must be reproduced in its entirety.



Oasis Environmental, Inc. 825 W 8th Ave, ste 200 Anchorage, AK/USA 99501-4427	Project Name: Coastal Drilling Project Number: 14-138 Project Manager: Nino Muniz	Report Created: 10/02/08 10:19
--	--	-----------------------------------

Diesel Range Organics (C10-C25) per AK102 - Laboratory Quality Control Results
 TestAmerica Anchorage

QC Batch: 8090076 **Water Preparation Method: EPA 3510**

Analyte	Method	Result	MDL*	MRL	Units	Dil	Source Result	Spike Amt	% REC	(Limits)	% RPD	(Limits)	Analyzed	Notes
Blank (8090076-BLK1)										Extracted: 09/19/08 08:37				
Diesel Range Organics	AK 102	ND	---	0.500	mg/l	1x	--	--	--	--	--	--	09/22/08 10:55	
<i>Surrogate(s): 1-Chlorooctadecane</i>		<i>Recovery: 98.2%</i>		<i>Limits: 50-150%</i>		<i>"</i>							<i>09/22/08 10:55</i>	
LCS (8090076-BS1)										Extracted: 09/19/08 08:37				
Diesel Range Organics	AK 102	10.5	---	0.500	mg/l	1x	--	10.3	102%	(75-125)	--	--	09/22/08 11:26	
<i>Surrogate(s): 1-Chlorooctadecane</i>		<i>Recovery: 94.4%</i>		<i>Limits: 60-120%</i>		<i>"</i>							<i>09/22/08 11:26</i>	
LCS Dup (8090076-BSD1)										Extracted: 09/19/08 08:37				
Diesel Range Organics	AK 102	12.4	---	0.500	mg/l	1x	--	10.3	120%	(75-125)	16.9% (20)		09/22/08 11:58	
<i>Surrogate(s): 1-Chlorooctadecane</i>		<i>Recovery: 107%</i>		<i>Limits: 60-120%</i>		<i>"</i>							<i>09/22/08 11:58</i>	
Duplicate (8090076-DUP1)										QC Source: ARI0070-01			Extracted: 09/19/08 08:37	
Diesel Range Organics	AK 102	ND	---	0.391	mg/l	1x	ND	--	--	--	6.63% (20)		09/22/08 10:55	
<i>Surrogate(s): 1-Chlorooctadecane</i>		<i>Recovery: 108%</i>		<i>Limits: 50-150%</i>		<i>"</i>							<i>09/22/08 10:55</i>	

TestAmerica Anchorage



Troy J. Engstrom, Lab Director

The results in this report apply to the samples analyzed in accordance with the chain of custody document. This analytical report must be reproduced in its entirety.



Oasis Environmental, Inc.	Project Name: Coastal Drilling	
825 W 8th Ave, ste 200	Project Number: 14-138	Report Created:
Anchorage, AK/USA 99501-4427	Project Manager: Nino Muniz	10/02/08 10:19

Gasoline Range Organics (C6-C10) per AK101-MS - Laboratory Quality Control Results
 TestAmerica Anchorage

QC Batch: 8090073 Water Preparation Method: EPA 5030B

Analyte	Method	Result	MDL*	MRL	Units	Dil	Source Result	Spike Amt	% REC	(Limits)	% RPD	(Limits)	Analyzed	Notes
---------	--------	--------	------	-----	-------	-----	---------------	-----------	-------	----------	-------	----------	----------	-------

Blank (8090073-BLK1)

Extracted: 09/18/08 08:58

Gasoline Range Organics	AK101 - MS	ND	---	50.0	ug/l	1x	--	--	--	--	--	--	09/18/08 23:48	
Surrogate(s): 4-BFB		Recovery: 103%		Limits: 80-120%		"							09/18/08 23:48	
Dibromofluoromethane		108%		80-120%		"							"	
Toluene-d8		87.0%		80-120%		"							"	

LCS (8090073-BS1)

Extracted: 09/18/08 08:58

Gasoline Range Organics	AK101 - MS	628	---	50.0	ug/l	1x	--	550	114%	(60-120)	--	--	09/18/08 22:41	
Surrogate(s): 4-BFB		Recovery: 102%		Limits: 80-120%		"							09/18/08 22:41	
Dibromofluoromethane		109%		80-120%		"							"	
Toluene-d8		86.5%		80-120%		"							"	

LCS Dup (8090073-BS1)

Extracted: 09/18/08 08:58

Gasoline Range Organics	AK101 - MS	622	---	50.0	ug/l	1x	--	550	113%	(60-120)	0.926% (20)		09/18/08 23:14	
Surrogate(s): 4-BFB		Recovery: 100%		Limits: 80-120%		"							09/18/08 23:14	
Dibromofluoromethane		110%		80-120%		"							"	
Toluene-d8		87.7%		80-120%		"							"	

Duplicate (8090073-DUP1)

QC Source: ARI0067-07

Extracted: 09/18/08 08:58

Gasoline Range Organics	AK101 - MS	ND	---	50.0	ug/l	1x	ND	--	--	--	NR (12)		09/18/08 18:41	
Surrogate(s): 4-BFB		Recovery: 101%		Limits: 80-120%		"							09/18/08 18:41	
Dibromofluoromethane		112%		80-120%		"							"	
Toluene-d8		88.2%		80-120%		"							"	

TestAmerica Anchorage



Troy J. Engstrom, Lab Director

The results in this report apply to the samples analyzed in accordance with the chain of custody document. This analytical report must be reproduced in its entirety.



Oasis Environmental, Inc. 825 W 8th Ave, ste 200 Anchorage, AK/USA 99501-4427	Project Name: Coastal Drilling Project Number: 14-138 Project Manager: Nino Muniz	Report Created: 10/02/08 10:19
--	--	-----------------------------------

Total Metals by EPA 6010/7000 Series Methods - Laboratory Quality Control Results
 TestAmerica Spokane

QC Batch: 8090158 Water Preparation Method: Metals

Analyte	Method	Result	MDL*	MRL	Units	Dil	Source Result	Spike Amt	% REC	(Limits)	% RPD	(Limits)	Analyzed	Notes
Blank (8090158-BLK1)										Extracted: 09/22/08 08:13				
Barium	EPA 6010C	ND	---	0.00800	mg/l	1x	--	--	--	--	--	--	09/23/08 09:20	
Chromium	"	ND	---	0.00800	"	"	--	--	--	--	--	--	"	
Lead	"	ND	---	0.0300	"	"	--	--	--	--	--	--	"	
LCS (8090158-BS1)										Extracted: 09/22/08 08:13				
Lead	EPA 6010C	1.07	---	0.0300	mg/l	1x	--	1.00	107%	(80-120)	--	--	09/23/08 09:15	
Barium	"	1.04	---	0.00800	"	"	--	"	104%	"	--	--	"	
Chromium	"	1.02	---	0.00800	"	"	--	"	102%	"	--	--	"	
Duplicate (8090158-DUP1)										QC Source: ARI0068-09 Extracted: 09/22/08 08:13				
Lead	EPA 6010C	ND	---	0.0300	mg/l	1x	ND	--	--	--	NR (20)		09/23/08 11:12	
Chromium	"	ND	---	0.00800	"	"	ND	--	--	--	0.484%	"	"	
Barium	"	0.0869	---	0.00800	"	"	0.0878	--	--	--	0.980%	"	"	
Matrix Spike (8090158-MS1)										QC Source: ARI0068-09 Extracted: 09/22/08 08:13				
Lead	EPA 6010C	1.05	---	0.0300	mg/l	1x	ND	1.00	105%	(75-125)	--	--	09/23/08 11:16	
Barium	"	1.13	---	0.00800	"	"	0.0878	"	104%	"	--	--	"	
Chromium	"	1.02	---	0.00800	"	"	0.00112	"	102%	"	--	--	"	
Matrix Spike Dup (8090158-MSD1)										QC Source: ARI0068-09 Extracted: 09/22/08 08:13				
Lead	EPA 6010C	1.06	---	0.0300	mg/l	1x	ND	1.00	106%	(75-125)	0.861% (20)		09/23/08 11:37	
Barium	"	1.14	---	0.00800	"	"	0.0878	"	106%	"	1.51%	"	"	
Chromium	"	1.03	---	0.00800	"	"	0.00112	"	103%	"	1.25%	"	"	

TestAmerica Anchorage



Troy J. Engstrom, Lab Director

The results in this report apply to the samples analyzed in accordance with the chain of custody document. This analytical report must be reproduced in its entirety.



Oasis Environmental, Inc.	Project Name: Coastal Drilling	
825 W 8th Ave, ste 200	Project Number: 14-138	Report Created:
Anchorage, AK/USA 99501-4427	Project Manager: Nino Muniz	10/02/08 10:19

Volatile Organic Compounds by EPA Method 8260B - Laboratory Quality Control Results
 TestAmerica Spokane

QC Batch: 8090178 **Water Preparation Method: GC/MS Volatiles**

Analyte	Method	Result	MDL*	MRL	Units	Dil	Source Result	Spike Amt	% REC	(Limits)	% RPD	(Limits)	Analyzed	Notes
Blank (8090178-BLK1)													Extracted: 09/24/08 08:23	
Dichlorodifluoromethane	EPA 8260B	ND	---	1.00	ug/l	1x	--	--	--	--	--	--	09/24/08 12:27	
Chloromethane	"	ND	---	5.00	"	"	--	--	--	--	--	--	"	
Vinyl chloride	"	ND	---	0.200	"	"	--	--	--	--	--	--	"	
Bromomethane	"	ND	---	5.00	"	"	--	--	--	--	--	--	"	
Chloroethane	"	ND	---	1.00	"	"	--	--	--	--	--	--	"	
Trichlorofluoromethane	"	ND	---	1.00	"	"	--	--	--	--	--	--	"	
1,1-Dichloroethene	"	ND	---	1.00	"	"	--	--	--	--	--	--	"	
Carbon disulfide	"	ND	---	1.00	"	"	--	--	--	--	--	--	"	
Methylene chloride	"	ND	---	10.0	"	"	--	--	--	--	--	--	"	
Acetone	"	ND	---	25.0	"	"	--	--	--	--	--	--	"	
trans-1,2-Dichloroethene	"	ND	---	1.00	"	"	--	--	--	--	--	--	"	
Methyl tert-butyl ether	"	ND	---	1.00	"	"	--	--	--	--	--	--	"	
1,1-Dichloroethane	"	ND	---	1.00	"	"	--	--	--	--	--	--	"	
cis-1,2-Dichloroethene	"	ND	---	1.00	"	"	--	--	--	--	--	--	"	
2,2-Dichloropropane	"	ND	---	1.00	"	"	--	--	--	--	--	--	"	
Bromochloromethane	"	ND	---	1.00	"	"	--	--	--	--	--	--	"	
Chloroform	"	ND	---	1.00	"	"	--	--	--	--	--	--	"	
Carbon tetrachloride	"	ND	---	1.00	"	"	--	--	--	--	--	--	"	
1,1,1-Trichloroethane	"	ND	---	1.00	"	"	--	--	--	--	--	--	"	
2-Butanone	"	ND	---	10.0	"	"	--	--	--	--	--	--	"	
1,1-Dichloropropene	"	ND	---	1.00	"	"	--	--	--	--	--	--	"	
Benzene	"	ND	---	0.200	"	"	--	--	--	--	--	--	"	
1,2-Dichloroethane (EDC)	"	ND	---	1.00	"	"	--	--	--	--	--	--	"	
Trichloroethene	"	ND	---	1.00	"	"	--	--	--	--	--	--	"	
Dibromomethane	"	ND	---	1.00	"	"	--	--	--	--	--	--	"	
1,2-Dichloropropane	"	ND	---	1.00	"	"	--	--	--	--	--	--	"	
Bromodichloromethane	"	ND	---	1.00	"	"	--	--	--	--	--	--	"	
cis-1,3-Dichloropropene	"	ND	---	1.00	"	"	--	--	--	--	--	--	"	
Toluene	"	ND	---	1.00	"	"	--	--	--	--	--	--	"	
4-Methyl-2-pentanone	"	ND	---	10.0	"	"	--	--	--	--	--	--	"	
trans-1,3-Dichloropropene	"	ND	---	1.00	"	"	--	--	--	--	--	--	"	
Tetrachloroethene	"	ND	---	1.00	"	"	--	--	--	--	--	--	"	
1,1,2-Trichloroethane	"	ND	---	1.00	"	"	--	--	--	--	--	--	"	
Dibromochloromethane	"	ND	---	1.00	"	"	--	--	--	--	--	--	"	
1,3-Dichloropropane	"	ND	---	1.00	"	"	--	--	--	--	--	--	"	
1,2-Dibromoethane	"	ND	---	1.00	"	"	--	--	--	--	--	--	"	
2-Hexanone	"	ND	---	10.0	"	"	--	--	--	--	--	--	"	
Ethylbenzene	"	ND	---	1.00	"	"	--	--	--	--	--	--	"	
Chlorobenzene	"	ND	---	1.00	"	"	--	--	--	--	--	--	"	

TestAmerica Anchorage

The results in this report apply to the samples analyzed in accordance with the chain of custody document. This analytical report must be reproduced in its entirety.



Troy J. Engstrom, Lab Director



Oasis Environmental, Inc.	Project Name: Coastal Drilling	
825 W 8th Ave, ste 200	Project Number: 14-138	Report Created:
Anchorage, AK/USA 99501-4427	Project Manager: Nino Muniz	10/02/08 10:19

Volatile Organic Compounds by EPA Method 8260B - Laboratory Quality Control Results
 TestAmerica Spokane

QC Batch: 8090178 **Water Preparation Method: GC/MS Volatiles**

Analyte	Method	Result	MDL*	MRL	Units	Dil	Source Result	Spike Amt	% REC	(Limits)	% RPD	(Limits)	Analyzed	Notes
Blank (8090178-BLK1)													Extracted: 09/24/08 08:23	
1,1,1,2-Tetrachloroethane	EPA 8260B	ND	---	1.00	ug/l	1x	--	--	--	--	--	--	09/24/08 12:27	
m,p-Xylene	"	ND	---	2.00	"	"	--	--	--	--	--	--	"	
o-Xylene	"	ND	---	1.00	"	"	--	--	--	--	--	--	"	
Styrene	"	ND	---	1.00	"	"	--	--	--	--	--	--	"	
Bromoform	"	ND	---	1.00	"	"	--	--	--	--	--	--	"	
Isopropylbenzene	"	ND	---	1.00	"	"	--	--	--	--	--	--	"	
n-Propylbenzene	"	ND	---	1.00	"	"	--	--	--	--	--	--	"	
1,1,2,2-Tetrachloroethane	"	ND	---	1.00	"	"	--	--	--	--	--	--	"	
Bromobenzene	"	ND	---	1.00	"	"	--	--	--	--	--	--	"	
1,3,5-Trimethylbenzene	"	ND	---	1.00	"	"	--	--	--	--	--	--	"	
2-Chlorotoluene	"	ND	---	1.00	"	"	--	--	--	--	--	--	"	
1,2,3-Trichloropropane	"	ND	---	1.00	"	"	--	--	--	--	--	--	"	
4-Chlorotoluene	"	ND	---	1.00	"	"	--	--	--	--	--	--	"	
tert-Butylbenzene	"	ND	---	1.00	"	"	--	--	--	--	--	--	"	
1,2,4-Trimethylbenzene	"	ND	---	1.00	"	"	--	--	--	--	--	--	"	
sec-Butylbenzene	"	ND	---	1.00	"	"	--	--	--	--	--	--	"	
p-Isopropyltoluene	"	ND	---	1.00	"	"	--	--	--	--	--	--	"	
1,3-Dichlorobenzene	"	ND	---	1.00	"	"	--	--	--	--	--	--	"	
1,4-Dichlorobenzene	"	ND	---	1.00	"	"	--	--	--	--	--	--	"	
n-Butylbenzene	"	ND	---	1.00	"	"	--	--	--	--	--	--	"	
1,2-Dichlorobenzene	"	ND	---	1.00	"	"	--	--	--	--	--	--	"	
1,2-Dibromo-3-chloropropane	"	ND	---	5.00	"	"	--	--	--	--	--	--	"	
Hexachlorobutadiene	"	ND	---	1.00	"	"	--	--	--	--	--	--	"	
1,2,4-Trichlorobenzene	"	ND	---	1.00	"	"	--	--	--	--	--	--	"	
Naphthalene	"	ND	---	2.00	"	"	--	--	--	--	--	--	"	
1,2,3-Trichlorobenzene	"	ND	---	1.00	"	"	--	--	--	--	--	--	"	
<i>Surrogate(s):</i>	<i>Dibromofluoromethane</i>	<i>Recovery:</i>	<i>100%</i>	<i>Limits:</i>	<i>62.2-128%</i>	<i>"</i>							<i>09/24/08 12:27</i>	
	<i>Toluene-d8</i>		<i>88.2%</i>		<i>75.4-120%</i>	<i>"</i>							<i>"</i>	
	<i>4-bromofluorobenzene</i>		<i>94.0%</i>		<i>77.3-129%</i>	<i>"</i>							<i>"</i>	

TestAmerica Anchorage



Troy J. Engstrom, Lab Director

The results in this report apply to the samples analyzed in accordance with the chain of custody document. This analytical report must be reproduced in its entirety.



Oasis Environmental, Inc. 825 W 8th Ave, ste 200 Anchorage, AK/USA 99501-4427	Project Name: Coastal Drilling Project Number: 14-138 Project Manager: Nino Muniz	Report Created: 10/02/08 10:19
--	--	-----------------------------------

Volatile Organic Compounds by EPA Method 8260B - Laboratory Quality Control Results
 TestAmerica Spokane

QC Batch: 8090178 Water Preparation Method: GC/MS Volatiles

Analyte	Method	Result	MDL*	MRL	Units	Dil	Source Result	Spike Amt	% REC	(Limits)	% RPD	(Limits)	Analyzed	Notes
---------	--------	--------	------	-----	-------	-----	---------------	-----------	-------	----------	-------	----------	----------	-------

LCS (8090178-BS1)

Extracted: 09/24/08 08:23

1,1-Dichloroethene	EPA 8260B	10.1	---	1.00	ug/l	1x	--	10.0	101%	(60.4-140)	--	--	09/24/08 12:56	
Benzene	"	10.3	---	0.200	"	"	--	"	103%	(72.9-120)	--	--	"	
Trichloroethene	"	9.99	---	1.00	"	"	--	"	99.9%	(73.7-120)	--	--	"	
Toluene	"	9.52	---	1.00	"	"	--	"	95.2%	(72.4-132)	--	--	"	
Chlorobenzene	"	10.5	---	1.00	"	"	--	"	105%	(80-120)	--	--	"	
<i>Surrogate(s): Dibromofluoromethane</i>		<i>Recovery:</i>	<i>102%</i>	<i>Limits:</i>	<i>62.2-128%</i>	<i>"</i>							<i>09/24/08 12:56</i>	
<i>Toluene-d8</i>		<i>89.0%</i>		<i>75.4-120%</i>	<i>"</i>								<i>"</i>	
<i>4-bromofluorobenzene</i>		<i>93.4%</i>		<i>77.3-129%</i>	<i>"</i>								<i>"</i>	

Matrix Spike (8090178-MS1)

QC Source: ARI0068-01

Extracted: 09/24/08 08:23

1,1-Dichloroethene	EPA 8260B	10.1	---	1.00	ug/l	1x	ND	10.0	101%	(52.5-135)	--	--	09/24/08 14:25	
Benzene	"	10.7	---	0.200	"	"	ND	"	107%	(72.3-120)	--	--	"	
Trichloroethene	"	11.0	---	1.00	"	"	ND	"	110%	(80-120)	--	--	"	
Toluene	"	10.2	---	1.00	"	"	ND	"	102%	(62.7-137)	--	--	"	
Chlorobenzene	"	11.3	---	1.00	"	"	ND	"	113%	(78.9-120)	--	--	"	
<i>Surrogate(s): Dibromofluoromethane</i>		<i>Recovery:</i>	<i>107%</i>	<i>Limits:</i>	<i>62.2-128%</i>	<i>"</i>							<i>09/24/08 14:25</i>	
<i>Toluene-d8</i>		<i>85.2%</i>		<i>75.4-120%</i>	<i>"</i>								<i>"</i>	
<i>4-bromofluorobenzene</i>		<i>87.4%</i>		<i>77.3-129%</i>	<i>"</i>								<i>"</i>	

Matrix Spike Dup (8090178-MSD1)

QC Source: ARI0068-01

Extracted: 09/24/08 08:23

1,1-Dichloroethene	EPA 8260B	9.96	---	1.00	ug/l	1x	ND	10.0	99.6%	(52.5-135)	1.10%	(10.5)	09/24/08 14:54	
Benzene	"	10.7	---	0.200	"	"	ND	"	107%	(72.3-120)	0.0935%	(10.7)	"	
Trichloroethene	"	10.8	---	1.00	"	"	ND	"	108%	(80-120)	2.20%	(10)	"	
Toluene	"	9.87	---	1.00	"	"	ND	"	98.7%	(62.7-137)	2.90%	(13)	"	
Chlorobenzene	"	11.0	---	1.00	"	"	ND	"	110%	(78.9-120)	2.51%	(11.2)	"	
<i>Surrogate(s): Dibromofluoromethane</i>		<i>Recovery:</i>	<i>107%</i>	<i>Limits:</i>	<i>62.2-128%</i>	<i>"</i>							<i>09/24/08 14:54</i>	
<i>Toluene-d8</i>		<i>84.6%</i>		<i>75.4-120%</i>	<i>"</i>								<i>"</i>	
<i>4-bromofluorobenzene</i>		<i>84.2%</i>		<i>77.3-129%</i>	<i>"</i>								<i>"</i>	

TestAmerica Anchorage



Troy J. Engstrom, Lab Director

The results in this report apply to the samples analyzed in accordance with the chain of custody document. This analytical report must be reproduced in its entirety.



Oasis Environmental, Inc.

825 W 8th Ave, ste 200
Anchorage, AK/USA 99501-4427

Project Name: **Coastal Drilling**

Project Number: 14-138

Project Manager: Nino Muniz

Report Created:

10/02/08 10:19

Notes and Definitions

Report Specific Notes:

None

Laboratory Reporting Conventions:

- DET - Analyte DETECTED at or above the Reporting Limit. Qualitative Analyses only.
- ND - Analyte NOT DETECTED at or above the reporting limit (MDL or MRL, as appropriate).
- NR/NA - Not Reported / Not Available
- dry - Sample results reported on a Dry Weight Basis. Results and Reporting Limits have been corrected for Percent Dry Weight.
- wet - Sample results and reporting limits reported on a Wet Weight Basis (as received). Results with neither 'wet' nor 'dry' are reported on a Wet Weight Basis.
- RPD - RELATIVE PERCENT DIFFERENCE (RPDs calculated using Results, not Percent Recoveries).
- MRL - METHOD REPORTING LIMIT. Reporting Level at, or above, the lowest level standard of the Calibration Table.
- MDL* - METHOD DETECTION LIMIT. Reporting Level at, or above, the statistically derived limit based on 40CFR, Part 136, Appendix B. *MDLs are listed on the report only if the data has been evaluated below the MRL. Results between the MDL and MRL are reported as Estimated Results.
- Dil - Dilutions are calculated based on deviations from the standard dilution performed for an analysis, and may not represent the dilution found on the analytical raw data.
- Reporting Limits - Reporting limits (MDLs and MRLs) are adjusted based on variations in sample preparation amounts, analytical dilutions and percent solids, where applicable.
- Electronic Signature - Electronic Signature added in accordance with TestAmerica's *Electronic Reporting and Electronic Signatures Policy*. Application of electronic signature indicates that the report has been reviewed and approved for release by the laboratory. Electronic signature is intended to be the legally binding equivalent of a traditionally handwritten signature.

TestAmerica Anchorage



Troy J. Engstrom, Lab Director

The results in this report apply to the samples analyzed in accordance with the chain of custody document. This analytical report must be reproduced in its entirety.



TestAmerica

THE LEADER IN ENVIRONMENTAL TESTING

11720 North Creek Pkwy N Suite 400, Bothell, WA 98011-8244
 11922 E. First Ave, Spokane, WA 99206-5302
 9405 SW Nimbus Ave, Beaverton, OR 97008-7145
 2000 W International Airport Rd Ste A10, Anchorage, AK 99502-1119

425-420-9200 FAX 420-9210
 509-924-9200 FAX 924-9290
 503-906-9200 FAX 906-9210
 907-563-9200 FAX 563-9210

CHAIN OF CUSTODY REPORT

Work Order #: **AR10068**

CLIENT:	INVOICE TO:	TURNAROUND REQUEST			
		in Business Days *			
CLIENT: OASIS Environmental	INVOICE TO: OASIS Environmental	<input checked="" type="checkbox"/> 7 <input type="checkbox"/> 5 <input type="checkbox"/> 4 <input type="checkbox"/> 3 <input type="checkbox"/> 2 <input type="checkbox"/> 1 <input type="checkbox"/> <1	<input checked="" type="checkbox"/> 7 <input type="checkbox"/> 5 <input type="checkbox"/> 4 <input type="checkbox"/> 3 <input type="checkbox"/> 2 <input type="checkbox"/> 1 <input type="checkbox"/> <1		
REPORT TO: 825 W. 8th Ave		Organic & Inorganic Analyses Petroleum Hydrocarbon Analyses			
ADDRESS: Anchorage, AK 99587		<input checked="" type="checkbox"/> ATD <input checked="" type="checkbox"/> STD <input type="checkbox"/> OTHER Specify:			
PHONE: (907) 258-4880 FAX:		* Turnaround Requests less than standard may incur Revis Charges.			
PROJECT NAME: Coastal Drilling	P.O. NUMBER:				
PROJECT NUMBER: 14-138					
SAMPLED BY: AT/OS					
CLIENT SAMPLE IDENTIFICATION	SAMPLING DATE/TIME	MATRIX (W, S, O)	# OF CONT.	LOCATION/ COMMENTS	TA WO ID
1 B-2 MW	9/16/08 1110	W	9		1
2 B-3 MW	9/16/08 0940	W	9		2
3 GW-2	9/16/08 0850	W	9		3
4 GW-3	9/15/08 1800	W	9		4
5 GW-4	9/15/08 1700	W	9		5
6 GW-5	9/15/08 1615	W	9		6
7 GW-6	9/15/08 1445	W	9		7
8 GW-7	9/16/08 1020	W	9		8
9 Duplicate 1	9/15/08 1400	W	9		9
10 Trip Blank	9/15/08 1200	W	5		10
RELEASED BY: Olga Stewart	DATE: 9/16/08	RECEIVED BY: David Sumner	DATE: 9/16/08		
PRINT NAME: OLGA STEWART	DATE: 4:15 PM	PRINT NAME: DAVID SUMNER	DATE: 4:15 PM	FIRM: ANCHORAGE	TIME: 1615
ADDITIONAL REMARKS:				FIRM: DAVID SUMNER	DATE: 1615

TEMP: 2.6

PAGE 2 OF 6

TAL-100(04/08)

Test America Anchorage Cooler Receipt Form

(Army Corps. Compliant)

WORK ORDER # AR10068

CLIENT: OASIS

PROJECT: COASTAL DRILLING

Date /Time Cooler Arrived 9 / 16 / 08 16:15

Cooler signed for by: DAVID SUMMERVILLE
(Print name)

Preliminary Examination Phase:

Date cooler opened: same as date received or / /

Cooler opened by (print) DAVID SUMMERVILLE (sign) David Summerville

1. Delivered by ALASKA AIRLINES Fed-Ex UPS NAC LYNDEN CLIENT Other:

Shipment Tracking # if applicable (include copy of shipping papers in file)

2. Number of Custody Seals 2 Signed by Olga Stewart Date 9 / 16 / 08

Were custody seals unbroken and intact on arrival? Yes No

3. Were custody papers sealed in a plastic bag? Yes No

4. Were custody papers filled out properly (ink, signed, etc.)? Yes No

5. Did you sign the custody papers in the appropriate place? Yes No

6. Was ice used? Yes No Type of ice: blue ice gel ice real ice dry ice Condition of Ice: 26 solid

Temperature by Digi-Thermo Probe 2.6 °C Thermometer # Rec # 3
Acceptance Criteria: 0 - 6°C

7. Packing in Cooler: bubble wrap styrofoam cardboard Other:

8. Did samples arrive in plastic bags? Yes No

9. Did all bottles arrive unbroken, and with labels in good condition? Yes No

10. Are all bottle labels complete (ID, date, time, etc.) Yes No

11. Do bottle labels and Chain of Custody agree? Yes No

12. Are the containers and preservatives correct for the tests indicated? Yes No

13. Conoco Phillips, Alyeska, BP H2O samples only: pH < 2? Yes No N/A

14. Is there adequate volume for the tests requested? Yes No

15. Were VOA vials free of bubbles? N/A Yes No

If "NO" which containers contained "head space" or bubbles?

Log-in Phase:

Date of sample log-in 09 / 17 / 08

Samples logged in by (print) DALJET MAHAL (sign) D. Mahal

1. Was project identifiable from custody papers? Yes No

2. Do Turn Around Times and Due Dates agree? Yes No

3. Was the Project Manager notified of status? Yes No

4. Was the Lab notified of status? Yes No

5. Was the COC scanned and copied? Yes No

TestAmerica
THE LEADER IN ENVIRONMENTAL TESTING
1 4 8 5 6 7

Custody Seal *2/11/08*
DATE *Steph Howard*
SIGNATURE

TestAmerica
THE LEADER IN ENVIRONMENTAL TESTING
1 4 8 5 6 7

TestAmerica
THE LEADER IN ENVIRONMENTAL TESTING
1 4 8 5 6 7

Custody Seal *80/9/12*
DATE *[Signature]*
SIGNATURE

TestAmerica
THE LEADER IN ENVIRONMENTAL TESTING
1 4 8 5 6 7