



January 29, 2014

Bob Mattson
Environmental Program Specialist
ADEC, Division of Spill Prevention and Response
410 Willoughby Avenue, Suite 316
Juneau, Alaska 99811-1800

Re: 2822 Marsha Avenue, Spill #14119919601

Dear Mr. Mattson,

Andrea DeWees has contracted with Carson Dorn to help her address the above-referenced spill at her home at 2822 Marsha Avenue in the lower Mendenhall Valley. Our role includes interfacing with you, performing a site assessment, recommending a work plan, and clearance sampling. She has contracted directly with Gene Cheeseman (and Kurt Tveten) to do the actual remediation work, and she has contracted directly with Bicknell, Inc. to treat the contaminated soil.

In May 2013, as a pre-condition to for the DeWees's to buy the house, the existing UST was decommissioned and a new AST was installed to replace it. The new supply/return piping for the new AST was connected to the existing underground supply/return piping that had served the UST. Subsequent to that work, there was a failure either in the existing old piping or at the fittings where it connected to the new piping, and a spill of 250 gallons, plus or minus, resulted. It wasn't until the end of 2013 that a rising water table brought fuel into the crawl space and forced the DeWees family to move out because of fuel odors inside the house.

Because of the unusual mild January weather, and with your approval, we have embarked on an expedited approach to this project. On Monday, January 27, we met Gene Cheeseman on site to both begin excavation at the point of original discharge and to evaluate the situation inside the crawl space. Using a mini-excavator and small loader, Gene removed about 11 tons of contaminated soil from the area of original release and he opened an excavation that went under the footing to the crawl space beyond. Kurt Tveten hauled the material to Bicknell's yard.

Inside the crawl space, we found the original vapor barrier still in place and considerable other debris, all of which was contaminated with fuel. The crawl space material is a very consistent sand and with moderate contamination identifiable to a depth of a few inches in the area adjacent to the spill zone.

On Monday afternoon and evening, Andrea and Duncan DeWees bagged and removed everything from the crawl space, passing the bags out through the opening excavated by Cheeseman. By Tuesday morning, the crawl space was ready for work.

On Tuesday, Andrea and Duncan worked with Kurt Tveten inside the crawl space, moving contaminated soil to the access hole excavated beneath the footing. Gene Cheeseman then pulled the material out from under the footing with the excavator and shuttled it to Tveten's truck using the small loader. Perhaps 3" of sandy material was removed in this fashion from half the crawl space. In total, about 6 tons were removed and hauled to Bicknell on Tuesday.

Also on Tuesday, Andrea decided to have Cheeseman remove and dispose of the old UST. As a result, the excavated area was expanded and deepened to about 5.5' below grade (about 1.5' below water table). The resulting overall excavation was then backfilled with approximately 10 yards of 2" crushed rock. As part of the backfill effort, a 12" vertical sump was installed complete with a float-controlled sump pump that discharges through an oily water separator and then through the ADEC filtration barrel before ultimate discharge to the CBJ storm drain system. The sump pump in the crawl space also discharges through the ADEC filtration barrel. A small amount of contaminated soil was also removed from the NW corner of the parcel where the crawl space sump pump had discharged before the ADEC filtration barrel was installed.

Figure 1, attached herewith, illustrates what has been accomplished.

The next step of the response will be careful installation of a 10 mil vapor barrier in the crawl space, sealed against stem walls, footings, and any pipe penetrations. That work is scheduled for Friday, January 31.

Today, I will use a hand auger to collect a sample at depth at the edge of the backfill area, a sample where material was removed from the NW corner of the lot, and a sample in the crawl space. We will forward the lab report to you as soon as we receive it.

Regards,



Thomas G. Carson
Principal, Carson Dorn, Inc.

Cc: Andrea DeWees (via email)

Attachment



Carson Dorn Inc.

BY TEC DATE 1/29/14 CLIENT 2822 MARSHA SHEET 1 OF 1

CHKD. BY _____ DESCRIPTION FUEL OIL SPILL JOB NO. _____

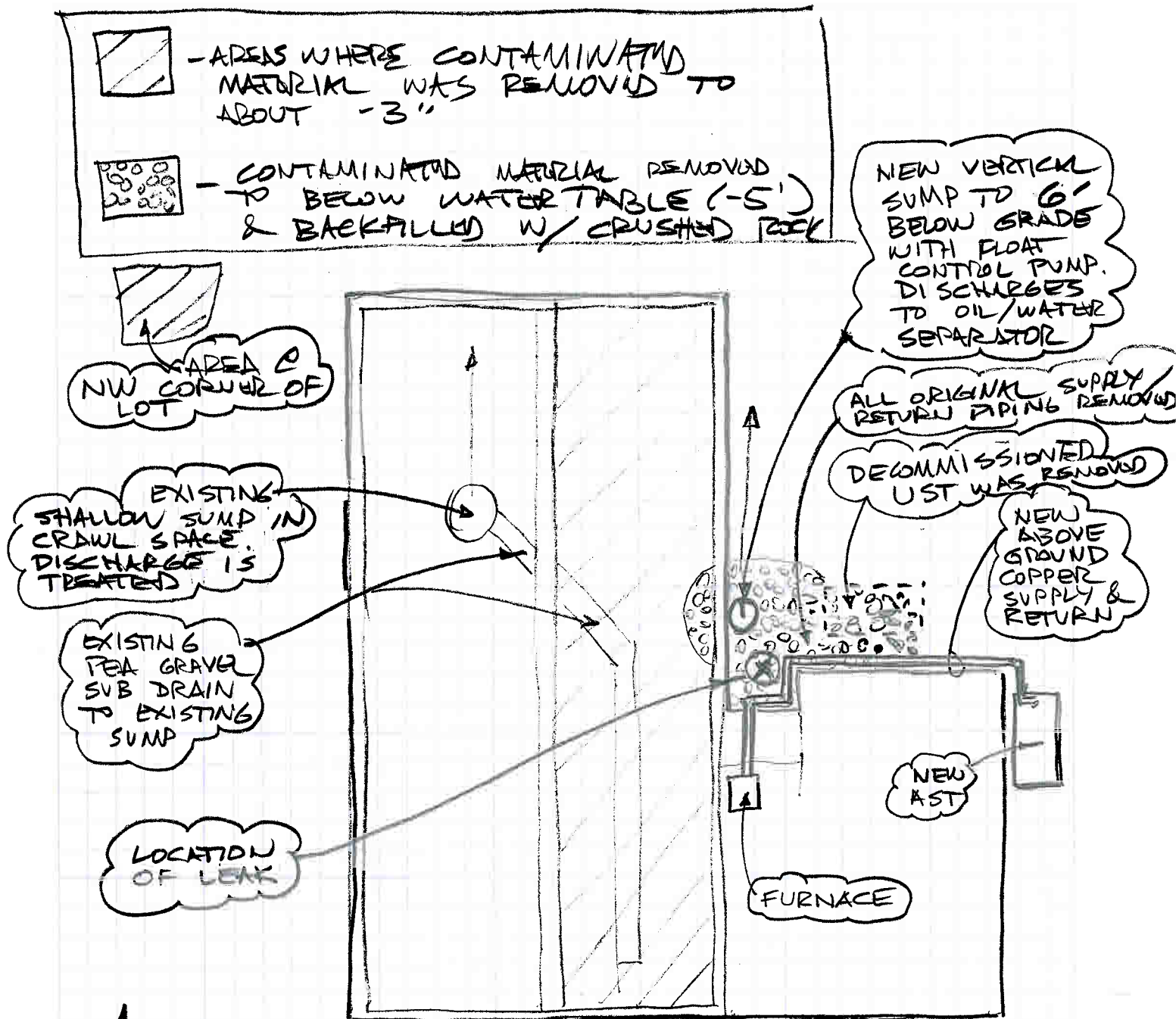

NOTE: ORIGINAL SPILL OCCURRED AFTER NEW AST WAS INSTALLED. A LEAK OCCURRED WHERE NEW SUPPLY/RETURN PIPES CONNECTED TO ORIGINAL SUPPLY/RETURN PIPES.

2822 MARSHA
PLAN VIEW

FIGURE
1