

**Appendix E**  
**Copy of Field Notebook**



2 30 AUG 03

#2

Leave School 1020  
leave arrive 1058 50g Subsamples

Staking out to 1130

Finish Sampling 1244 -0150

SU 2A 64° 28' 56" N 55.89  
(SE CORNER) 146° 56' 55" W - 55.17 W

SU 2B 64° 28' 55.94 N  
(SW CORNER) 146° 56' 55.25 W

Back to truck 1400

Very heavily grassy in w/ alders  
young birch

Soil a low-density light brown sandy silt  
w/ many roots, some wood fragments

30 AUG 03

#3

arrive 1435  
MP Marker 577  
ROADWAY in dense forest

Area to east/north of road disturbed  
at Marker  
Corridor is very narrow here, but we  
will continue with soft grid

Move ~200ft South of Marker

1500 - Stake out  
grassy area on west side, forest on east  
side of road. No samples within  
roadway

Finish Sampling 1547 -0250

Soil is a light sandy silt with  
many roots, darker in forest and  
grasses lighter colored along side  
road

SU 3B 64° 21' 32.76 N  
(NE CORNER) 146° 21' 50" W

SU 3A 146° 50' 4" W 64° 21' 33.113  
(NE CORNER) 146° 50' 45.362

4 31 AUG 03 RAINING  
52°F at 0730

#1  
arrive 1020

GP ...  
...  
sketch 1001  
1A SW 00 64 32 57.400  
146 58 21.282

1B SE Corn 64 32 57.235  
146 58 20.639

Finish sampling 1113

Sample -0380

soil; dark silt w/ roots  
50 foot grid spans entire  
grassy area.

No stakes set, due to proximity  
to plowed fields

31 AUG 03 RAIN

#5  
arrive 1249

Grassy, very well defined circular  
Evidence of relatively recent clearing  
activities to either side of Fowler Road  
Go ~ 1/2 mile south, center lane of  
trees appears

Pick spot where little evidence of  
clearing, but few trees in way  
Start 1311

Area not wide enough: steep dropoff  
on east, steep bank on right east.

Drive further south, to just before  
road turns east: similar spot w/in banks.

Start grid 1328

Sample 1355 - 1407

0480

SU 5A 64° 15' 58.023 N  
146° 11' 26.192 W  
5B 64° 15' 57.697 N  
146° 11' 27.665 W

6 31 AUG 03 RAINING

#5 BKGD

PICK SITE 1446

~0.3 mile east of corridor

at Bitch postland south of Cabin Road

GRID WILL SPADLE Cabin Road

Start Digging 1507

Finish sampling 1540 - 0530

Soil's Range from light-colored sandy silt in roadway, to dark high organic silt.

BK 5B 64° 16' 12.389" N  
146° 11' 36.788" W

BK 5A 64° 16' 12.295" N  
146° 11' 38.005" W

1 SEP 03 RAIN

#6 arrive 1058

very broad grassy corridor

will place grid on west side

opposite utility lines

30 ft in from west side to

avoid signs at driveway /

light earth moving

Sampling ends 12:30

06 g6 100 gram subsample  
07 s0 QC dup  
08 s0 QA dup

leave site 1222

Soil's Range from very wet  
peat (sampled 1m under root layer)  
to bare silt (0-2 in)

Holes on east most row in wet area,  
filled w/ water. - row moved west several

SUBA 64° 12' 49.541" N  
145° 57' 32.953" W

SUBB 64° 12' 49.824" N  
145° 57' 32.274" W

8 1 SEP 03 light rain

# 7 arrive 1320

sta mapping 1340

sparsely veg

SU7A 63° 58' 04" 805 N "NE corner"

145° 28' 59" 219 W

SU7B 65° 58' 04" 775 N "NW corner"

145° 28' 59" 797 W

sparsely vegetated area, w/ bare patches. Shallow trench, presumed from excavated pipeline.

GRID centered on trench

Sampling finished 1400.

Soil a moist silt, light brown little organics

-09 ga

base site 1445

1 SEP 03

9

#4 arrive 1533

Sampling finished 1620

-10 ga

SU4A 64° 18' 44" 139 N "NW corner"  
146° 31' 53" 671 W

SU4B 64° 18' 44" 618 N "NE corner"  
146° 31' 53" 343 W

Broad marshy landscape  
deep water filled trench sunken along west side.  
bare grid w/ west side along east edge of trench

Soil very wet peat, overlying gray silt.

leave 1651

2 SEP 03 light rain

#8 BKGD  
pullout at culvert .1336  
walk into woods

end samplings 1230  
-12 go

Small clearing in spruce forest  
heavy sphagnum layer under floor

Soil sampled immediately under  
root mat, 1-6 inches below surface  
Some silt, some root matter  
w/ wood fragments

BK8B 63° 53' 15.200"  
(SE corner) 195° 11' 42.132"

BK8A 63° 53' 14.689"  
(SW corner) 145° 11' 42.453"

2 SEP 03 light rain

#8 arrive 1207  
drive down ATV trail from pullout  
just south of MP 1402,  
directly to "513" panel marker

bare area, rectangular about  
50ft square  
approx centered on old panel support

Soil varies from clean sands  
in bare area to silt w/ roots  
in wooded area on east of west.

Sampled 1230-1245

-11 go

SU 8A 63° 53' 21.503"  
145° 11' 40.226"

NE corner - only datum

2 SEP 03

#9

get truck stuck on trail  
find safe place to park at end of  
trail. get out 1642

wider patch of relatively narrow  
(~30'?) corridor / ATV trail  
veg is grass surrounded by  
spruce & willow.  
start flagging 1649

S49A 63° 45' 35.454" N  
"NW corner" 144° 42' 25.205" W

S49B 63° 45' 35.676" N  
"NE corner" 144° 42' 29.390" W

finish sampling 1716

Soil a dark silt w/ roots

-1350

abandon truck 1930  
head back to DJ

3 Sep 03

#11 arrive 1121

roughly rectangular area of grass  
in line with vaguely defined corridor.  
50 ft e-w, ~150 ft n-s.

Place north side of grid against  
north side of rectangular area.  
tussock grass surrounded by  
willow, spruce, dwarf birch.

Soil: dark peaty silt w/ some dark  
mossy fine roots  
Sampling ends 1216

-1450

SU11B 63° 21' 16.507" N "NE corner"  
143° 49' 42.599" W

SU11A 63° 26' 16.271" N "NW corner"  
143° 49' 43.552" W



4 SEP 03

#17(?)  
 Cannot find location / flags, try  
 Walk into clearing / bare soil -  
 find remnant of pipeline  
 (between 1234 and 1235 MPE)  
 set up 1300.  
 (DOT Paperdate reads 1234.5)

headout 1308

Place grid south of pipeline remnant  
 where vegetation is still intact.  
 Obvious depression where pipeline  
 once ran. Corridor between largest trees  
 is only about 40' wide  
 start sampling 1322 finish 1349-1650

Soil is dark peaty silt, first 10"  
 6" in SW corner hole.

SU17A 62° 41' 29.138" N "NE corner"  
 H° 12' 12.496" W

SU17B 62° 44' 20.932" N "NW corner"  
 H° 12' 13.391" W

4 SEP 03

#18 arrive 1020  
 meet NStFW people  
 brief safety meeting  
 end flagging 1046  
 Open Corridor w/ alder saplings  
 some brush burning w/in Corridor  
 Grid avoids burn areas

finish sampling 1120

Soil is a dark peaty silt w/  
 fine roots.

-15 gso  
 SU18A 62° 37' 02.644" N "SE corner"  
 H° 00' 47.598" W

SU18B 62° 37' 02.444" N "SW corner"  
 H° 00' 48.456" W

4 SEP 03

"Pond site" (Pulout just south of  
stop 1430 MP 1234.5)

Collect subsample at mouth of  
south drainage into pond, then  
walk along pond margin to right  
collecting a 4oz subsample every  
20 paces for 4 subsamples.

Repeat walking left around pond  
margin for a total of 9 subsamples.

Homogenize into composite sample  
finish 1450

-10/80

Mouth of drainage into pond:

62° 44' 10.503" N  
141° 12' 40.452" W

4 SEP 03

Site #16 (new)

Deadman's Lake Road (MP

Pullin, see corridor w/ pipeline  
walk ~ 200 yds north.

Place grid in bare sandy area.  
1603

Grid sampling 1640

Grid overlaps sandy area and  
into woods! 1/5 subsamples in sand,  
2/5 in peaty silt.

Veg is aspen, birch, grasses

SU16A 62° 53' 06.789" N "SW Corner"  
141° 30' 37.250" W

SU16B 62° 53' 07.014" N "SE Corner"

141° 30' 36.929" W

-17

-18 AC Dup

-19 QA Dup

5 SEP 04

#16 BK16A 1720

~0.3 mile down Deadman Lake Road  
Pullout weeding to north  
Cleared area amidst spruce & aspen  
Place grid where disturbed soil appears  
to end, and native mosses are visible  
about 100ft off water lake Road

Sampling ends 1755

-20 So

Soil is mostly very fine pale silt  
w/ some peat overlying.

BK16A 62° 53' 07.953" N "SE corner"  
| 41° 31' 00.259" W

BK16B 62° 53' 06.874" N "SW corner"  
| 41° 31' 00.799" W

5 SEP 04

#15

UDRINE CRISTITE 0910

"Value pit 47"  
On relatively narrow bench  
50-ft grid overlaps upper bank by  
two rows - placed just north of  
valve pit  
Sampling finished 0940

-21 So

Soils range from gravel to  
dry peat - some holes sampled  
at less than 2" due to refusal by  
rock

SU 15 A 63° 00' 29.314"  
"SW CORNER OF GRID" | 41° 44' 11.261"

SU 15 B 63° 00' 29.682"  
"SE CORNER OF GRID" | 41° 44' 10.663"

20 5 SEP 03

#13 arrive 1100 ~~Forest~~  
largest grid - points on north end  
near utility pole - capture pit  
Grid is immediately north of  
paved marker "411". Trench  
is visible along west side of  
Corridor

1-2780 wind sampling 1129

Soil is a dark colored silt  
w/ roots

SW Corner of grid  
\*SU13B 63° 19' 03.736"  
142° 38' 26.407

SE Corner of grid  
SU13A 63° 19' 04.199"  
142° 38' 26.963

21

1.5 mile NW site 14

Sections 20  
right in middle of Section

Utility serves N close to pipeline  
Toshin Native Corp - have general  
perm. 11.3.02

(Notes from  
phone call  
w/ Dave  
Matbach)

~~John  
Dolan~~

5 SEP 03

~0.5 mile east of DOR MARSHED ROAD  
TRAIL OF UTILITY  
CORNER

Site #12 W/line 130C

Pipeline marker "43C"

collider visible - re-taken way,

Some bare ground, east

Place of id immediately south of  
marker

Samples collected 1340

-23 So

med brown silt

g

NW Corner  
DE Corner

SU12 B 63° 21' 39.385" N

SW Corner 143° 19' 47.587" W

SU12 A 63° 21' 30.971" N

143° 19' 47.699" W

5 SEP 03

#12 BLEED ABOVE 1400

approx 1/4 mile north of #12

clearing in aspen/spruce forest -  
low ground cover

finish samplings 1426

-24 So

Soil a med brown silt

AREA 63° 21' 44.421" N (SW corner)

143° 19' 54.859" W

BLEED 63° 21' 44.850" N (SW corner)

143° 19' 55.023" W

5 SEP 03

#14 (new) ADrive 1625  
relatively undisturbed corridor  
near western area.  
Aspen / rose, some bare soil

High sampling 1655

-25 So

Grid begins at first  
undisturbed - appearing soil  
south of barrow area  
Eratomant two rows overlap  
in to forest

Soils are pretty soft overlapping  
of forest; plant w/ roots in woods

SW Corner  
SU14A 63° 13' 22.720" N  
(NW corner) 142° 13' 26.982" W  
SU14B 63° 13' 23.121" N  
142° 13' 26.166" W

6 SEP 03

TROTZKE

#10 (new) ADrive 0943  
Trotzky residence at MP 1360  
Section of pipe visible running  
between house and parking lot.  
Section of corridor SE of house

Start grid where pipe ends ~ 200 ft  
SE of house; grid extends to 522

Sampling ends 1035

-26 So

Soil is wet brown silt w/ sand  
Veg is birch / rose, retarded out  
emergent on corridor

SU10B 63° 38' 46.284" N  
(NW corner) 144° 02' 20.320" W

SU10A 63° 38' 46.545" N  
(NE corner) 144° 02' 19.507" W

Wild Sampling for 6 Sept 03

26 21 OCT 03

meet Carolyn

Haines Site 19 Weison  
leave Haines 0830

arrive 0921 MP 40

South and down slope from hornosite  
grid placed in depression / flat fish  
area. 0958 Heavy weed / alder

Sample 1015-1045

-2780

Soil dark organic silt, or  
light sandy silt

GPS not working  
set markers on "north" side grid

+9\*  
29 x 5 yards from N side of  
grid to intersection between  
of road and canal

\*38 x 5 =

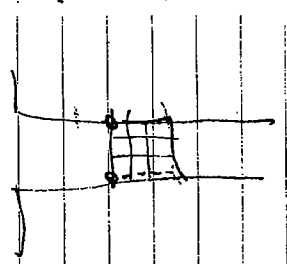

21 OCT 03

27

Site 20 BK

1156 Mosquito Lake Campground  
cleared area off end of M.L. Road  
steel structure on lake side

Sample 1280-1255

-2880

silty sand + gravel  
two lanes on lake side overlap  
into forest.

BK 20A 59° 27' 35.26 N  
136° 01' 32.91 W

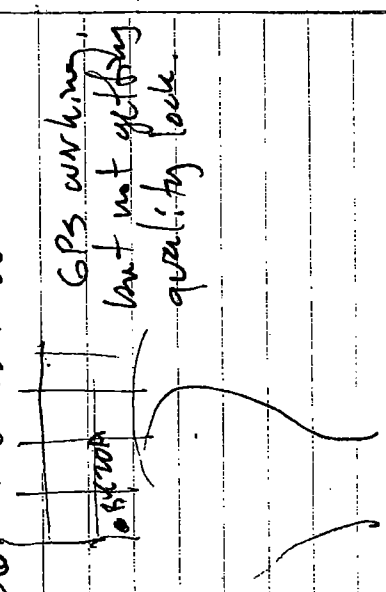

21 OCT 03

TAM HAYWOOD PROPERTY  
ARIVE 1558

Site 22  
up slope from house

Samples collected 1650-1700  
- 1980  
- 3080 (exc dmp)

soil a dark silt w/ gravel  
and rocks

monuments placed along  
north side of grid

No GPS - instrument not achieving  
lock

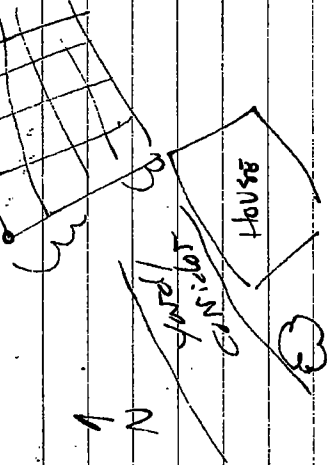

22 OCTOBER 2003

SITE 21

Klukwan berry picking ground  
across Highway from Council  
Grounds pull out 1000

Heavily forested area, with  
trace of small growth between  
large cottonwoods

Soil is sand, underlying  
a thin layer of organics

- 3180 } sample collected  
1018-1030

GPS coordinates completed





22 OCT 2003

Site 23

Comidar continuing - AF  
Skyline Drive 1230  
Sample grassy area just  
down slope of pipe fence

Gravelly roadway partly covered  
in grass

Start flagging 1351

Sun 1405-1427

-3380



CAR SET IN POINT  
↓ GIVE ROOM IN FROM  
EDGE OF GRID

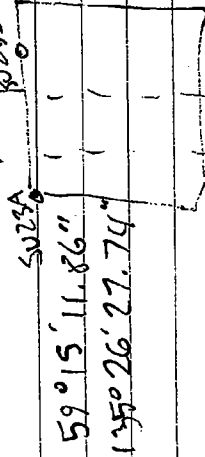

22 OCT 2003

SITE 23 BK

~1100 yds up Mt Ripinsky Trail  
from trailhead @ PIPE GATE  
1300

Dense hemlock rain forest  
In part of old stonewall trail

Sample 1310-1325

-3280

dark, high organics, weed  
fragments.

BK23A  
59°15'12.63" N  
155°26'37.34 W

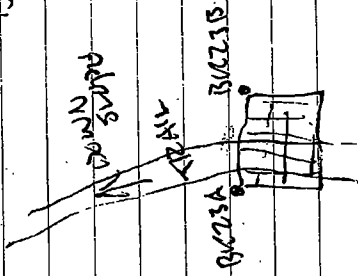

27 OCT 03

SITE 20 MOUNTAIN VIEW RD

MILLENMARKER "2.9" on west side of road

Grassy corridor thru alders Pick wider spot for grid flagging: 1634

-34 So  
sample collected 1635-1655

dark silt w/ roots

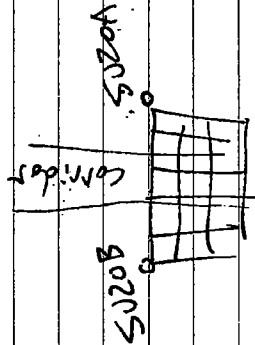

↑ N

End of Sampling  
Chung  
27 OCT 2003

~~of 13  
collected  
80% of  
of 13~~